

P-12348-1

21440

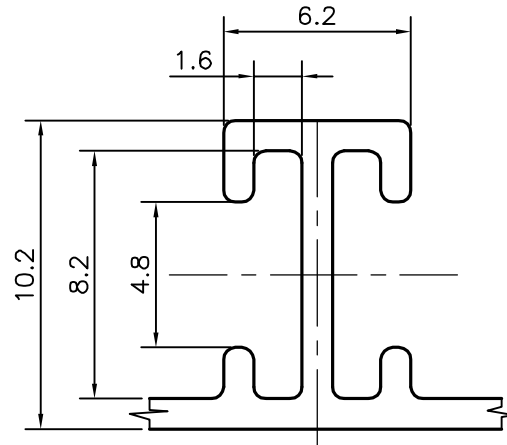

DETAILS OF "A"
SCALE 4:1

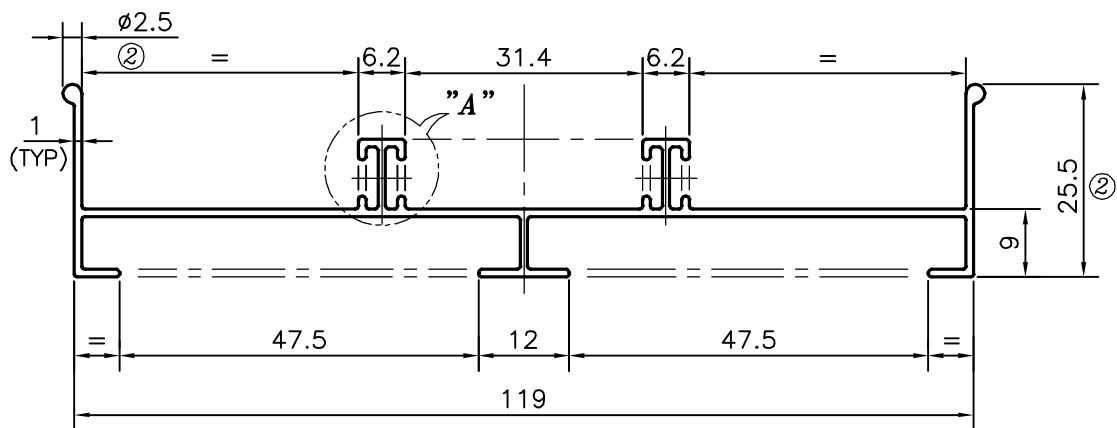

ISSUE (2) :-

- ☞ $\phi 2.5$ - 2 BULB ADDED ACCORDINGLY DIMENSION ALSO CHANGED FROM 24 TO 25.5 mm AT BOTH ENDS.
- ☞ WEIGHT ALSO CHANGED FROM 0.638 kg/m. TO 0.661 kg/m.



SYMBOL OF QUALITY
AN ISO 9001 COMPANY

JINDAL ALUMINIUM LTD.
BANGALORE-560073 (INDIA)

	NAME	DATE
DRAWN	PARVESH	11-06-2015
CHECKED		
APPROVED	S.S.GARG	17-06-2015
SCALE		1:1
AREA mm ²		244.952
PERIMETER mm.		472.95
WEIGHT kg/m		0.661
DRAWING No.	SECTION No.	
P-12348-1	-	
21440	21440 (ISSUE-2)	

1. ALL DIMENSIONS ARE IN mm.
2. ROUND OFF ALL SHARP CORNERS WITH 0.40 mm.
3. TOLERANCES WILL BE AS PER BS:EN-755-9, UNLESS OTHERWISE SPECIFIED

PARTY'S NAME	PRAYOSHA ENTERPRISES LTD., UGANDA
PARTY'S DRAWING No.	AS PER SKETCH (25mm SERIES)
ALLOY & TEMPER	6063 T6
DESCRIPTION	WINDOW SECTION (3 TRACK VERTICAL)