

P-12717-1  
S3759  
21453

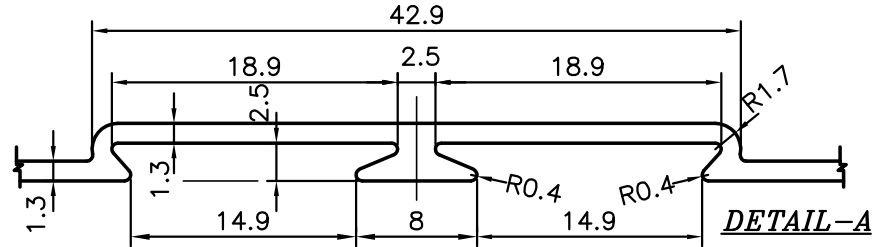
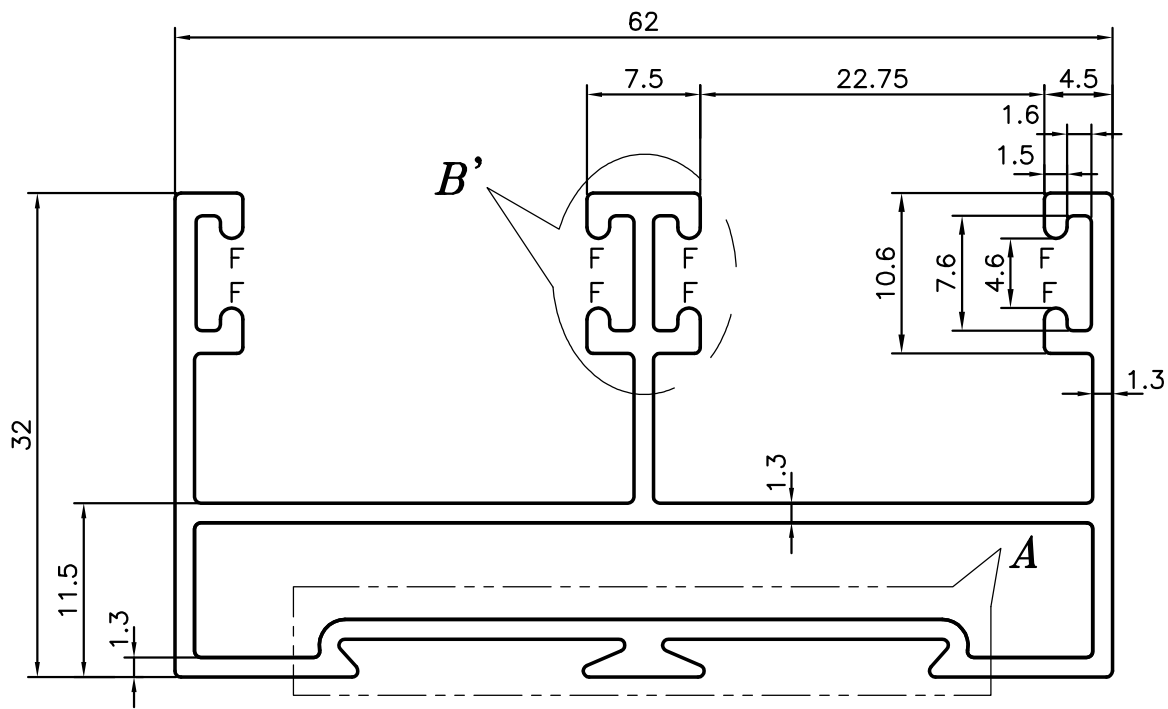
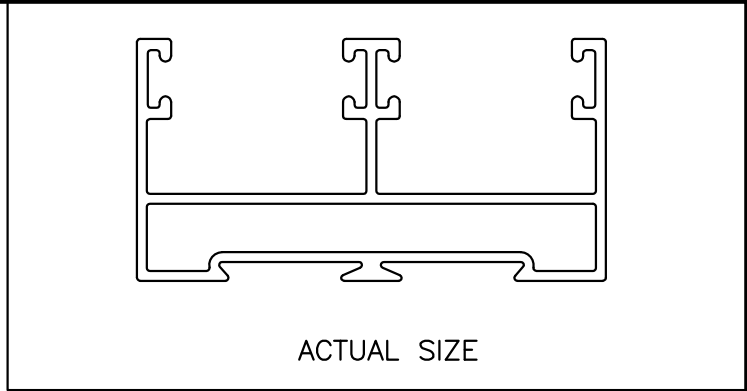
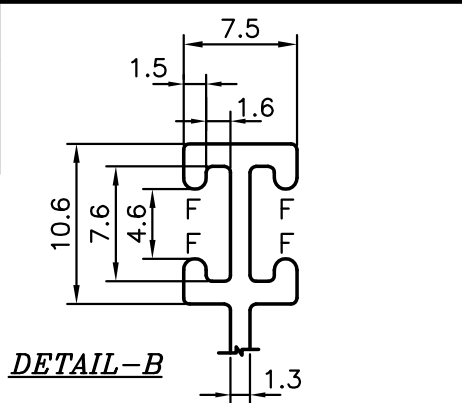

WEIGHT RANGE: - +0%  
- -6%

WEIGHT RANGE: -0.868 TO 0.923 kg/M

F= RADII FULL (8 PLACES)

TOLERANCES ON OVERALL WIDTHS & WIDTHS ACROSS FLATS OF BARS, & REGULAR SECTIONS

UPTO 6.40mm - ±0.20	UPTO 32.0mm - ±0.38	UPTO 120.0mm - ±0.85	UPTO 320.00mm - ±1.70
UPTO 10.0mm - ±0.23	UPTO 50.0mm - ±0.46	UPTO 160.0mm - ±1.02	
UPTO 12.0mm - ±0.25	UPTO 60.0mm - ±0.53	UPTO 200.0mm - ±1.14	
UPTO 16.0mm - ±0.28	UPTO 80.0mm - ±0.69	UPTO 250.0mm - ±1.40	
UPTO 25.0mm - ±0.30	UPTO 100.0mm - ±0.75	UPTO 300.0mm - ±1.65	

	<b>JINDAL ALUMINIUM LTD.</b> BANGALORE-560073 (INDIA)	DRAWN	J.P.KAUSHIK	DATE	11-05-2013
		CHECKED			
1. ALL DIMENSIONS ARE IN mm. 2. ROUND OFF ALL SHARP CORNERS WITH 0.40 mm. 3. TOLERANCES WILL BE AS PER IS:6477-1983 UNLESS OTHERWISE SPECIFIED		APPROVED	S.S.GARG		17-05-2013
		SCALE			2:1
PARTY'S NAME GIRDHARI LAL CONSTRUCTION PVT. LTD., BATHINDA		AREA mm <sup>2</sup>			341.763
		PERIMETER mm.			353.587
PARTY'S DRAWING No. LIGHTER OF SECTION No:-20888		WEIGHT kg/m			0.923
		DRAWING No.		SECTION No.	
ALLOY & TEMPER 6063 T6		P-12717-1			-
		S3759			S3759
DESCRIPTION WINDOW SECTION		21453			21453