

P-3614

S820

2829

22022

1. F = FULL RADIUS (4)
2. GENERAL WALL THICKNESS:- 1.35 mm.

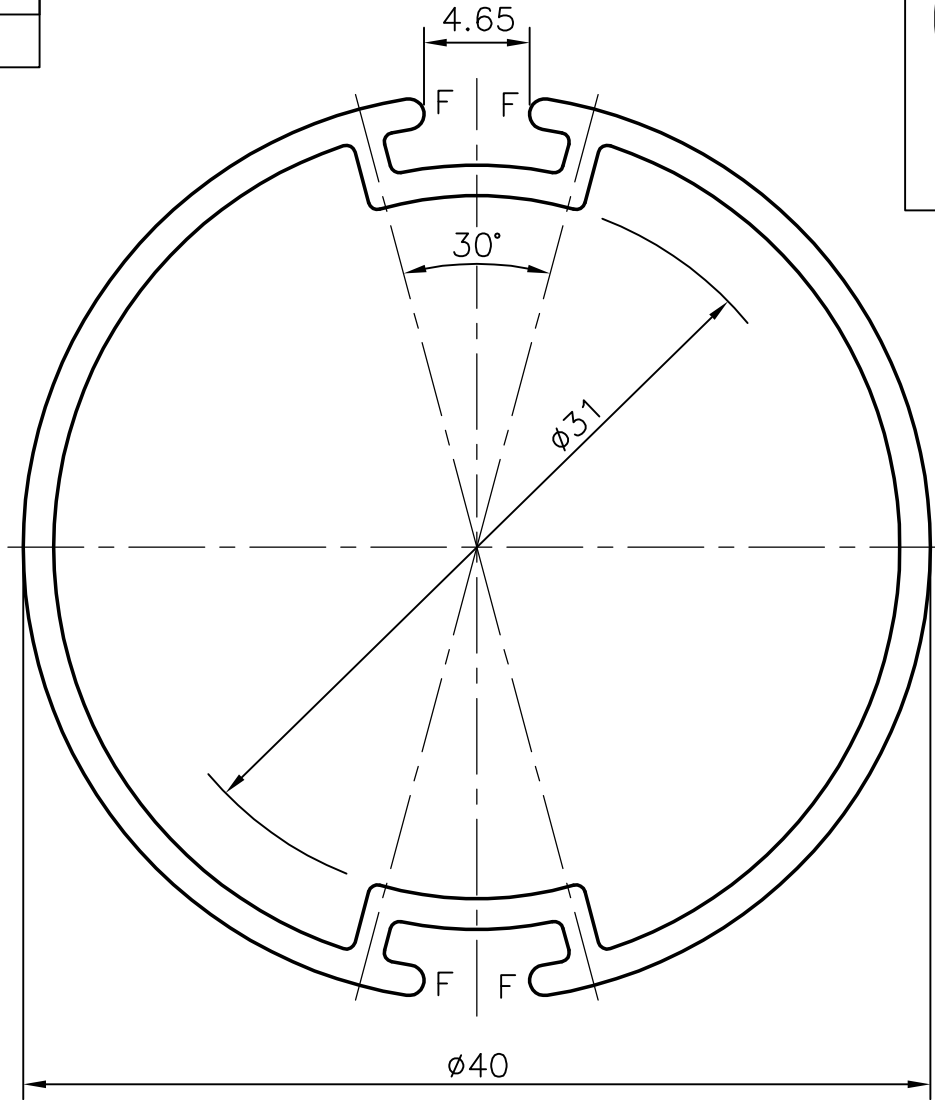
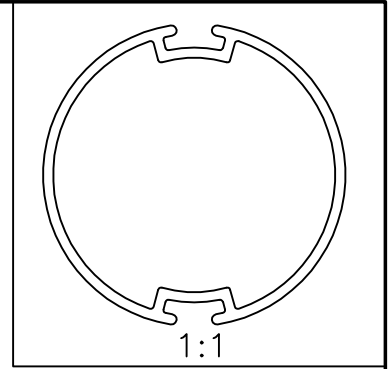

**ISSUE-2**

INSIDE FINS (8 NOS.) REMOVED & WEIGHT CHANGED FROM 0.508 kg/m TO 0.505 kg/m



SYMBOL OF QUALITY  
AN ISO 9002 COMPANY

**JINDAL ALUMINIUM LTD.**  
BANGALORE-560073 (INDIA)

	NAME	DATE
DRAWN	R.D.Sharma	07-01-03
CHECKED		
APPROVED		

1. ALL DIMENSIONS ARE IN mm.
2. ROUND OFF ALL SHARP CORNERS WITH 0.40 mm.
3. TOLERANCES WILL BE AS PER IS: 6477-1983 UNLESS OTHERWISE SPECIFIED

SCALE	1:1 & 3:1
AREA mm <sup>2</sup>	187
PERIMETER mm.	147.7
WEIGHT kg/m	0.505
SECTION No.	22022
DRAWING No.	22022

PARTY'S NAME	MAC LIFESTYLE PRODUCTS PVT. LTD., NEW DELHI
PARTY'S DRAWING No.	AS PER SAMPLE
ALLOY & TEMPER	HE9 WP
DESCRIPTION	MISCELLANEOUS TUBE