

P-3926

X248

22057

SECTION SHOULD BE CHECKED ALONG WITH MATCHING COMPONENTS TO ENSURE PROPER FITTING AND RUNNING

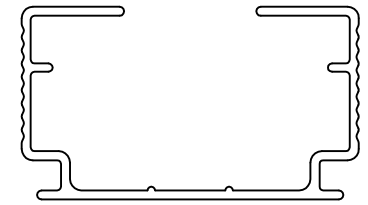

1:1

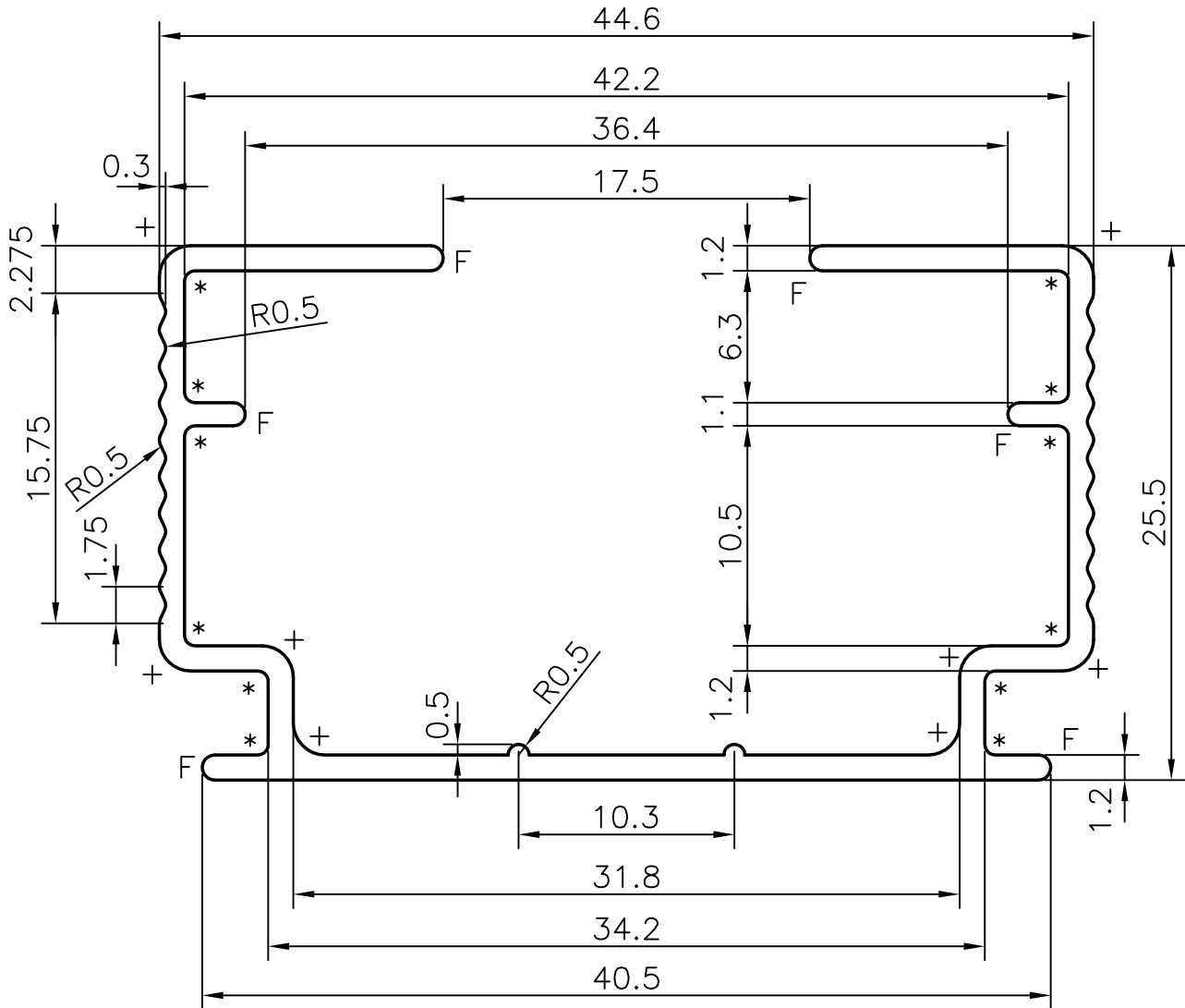

- * = RADIUS 0.5 (12)
- + = RADIUS 1.5 (8)
- F = FULL RADIUS (6)



SYMBOL OF QUALITY
AN ISO 9002 COMPANY

JINDAL ALUMINIUM LTD.
BANGALORE-560073 (INDIA)

	NAME	DATE
DRAWN	R.D.Sharma	17-08-02
CHECKED		
APPROVED		

1. ALL DIMENSIONS ARE IN mm.
2. ROUND OFF ALL SHARP CORNERS WITH 0.40 mm.
3. TOLERANCES WILL BE AS PER IS 3965-1981 UNLESS OTHERWISE SPECIFIED

SCALE	3:1
AREA mm ²	149.3
PERIMETER	255 mm
WEIGHT kg/m	0.403
SECTION No.	22057
DRAWING No.	22057

PARTY'S NAME	GOMRAJ FATAICHAND, CHENNAI
PARTY'S DRAWING No.	AS PER DRAWING
ALLOY & TEMPER	HE9 WP
DESCRIPTION	SLIM LINE VERTICAL BLIND-CHANNEL