

S212

5145

23204

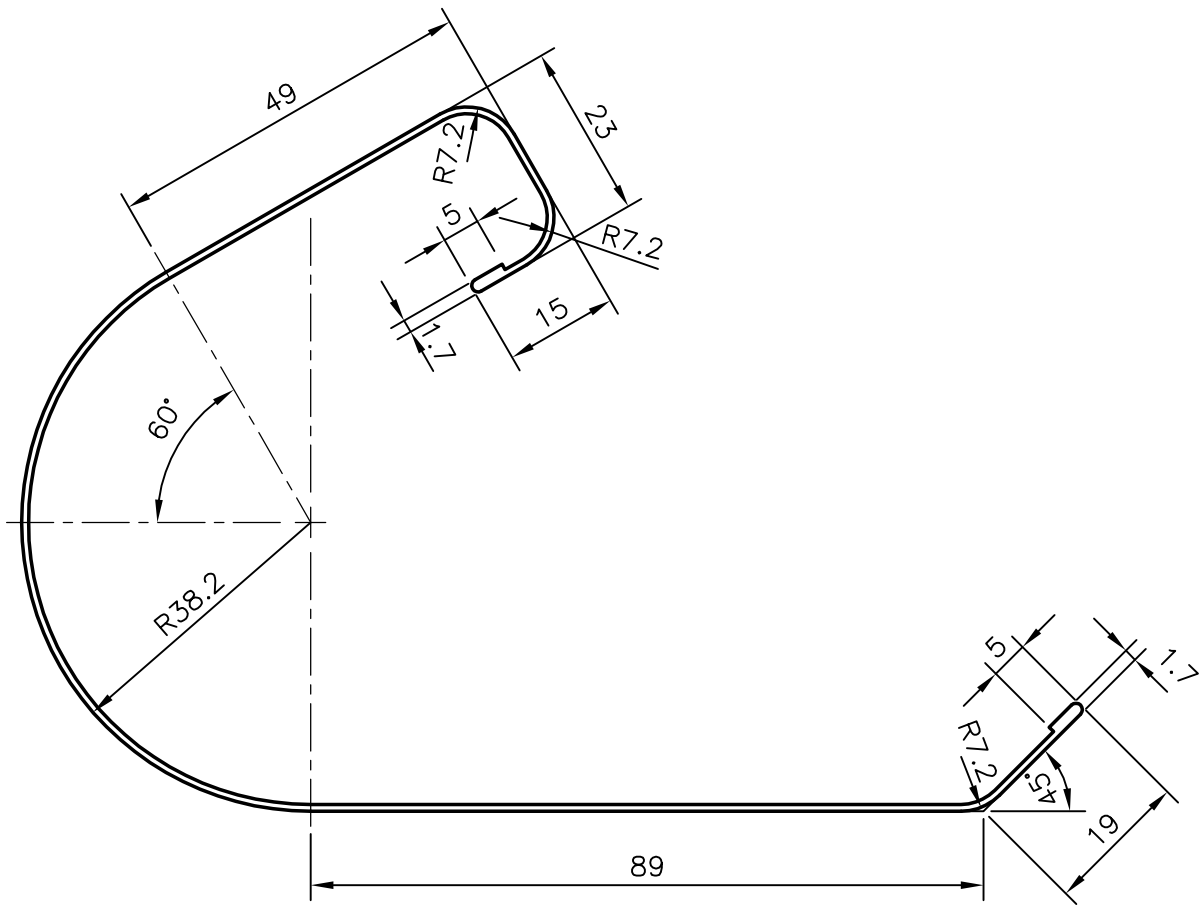

GENERAL WALL THICKNESS :- 0.90 mm.

JINDAL ALUMINIUM LTD.**BANGALORE-560073**

NAME

DATE

DRAWN

R.D.Sharma

19-03-98

CHECKED

APPROVED

1. ALL DIMENSIONS ARE IN mm.
 2. ROUND OFF ALL SHARP CORNERS WITH 0.4 mm.
 3. TOLERANCES WILL BE AS PER IS: 3965-1981 ,UNLESS OTHERWISE SPECIFIED

PARTY'S NAME

S.S. METAL, COIMBATORE

SCALE

1:1

PARTY'S DRAWING No.

NIL

WEIGHT kg/m

0.714

ALLOY & TEMPER

HE9 WP

SECTION No.

23204

LENGTH

3048 mm.

DRAWING No.

DESCRIPTION

FEEDER CHANNEL

23204