

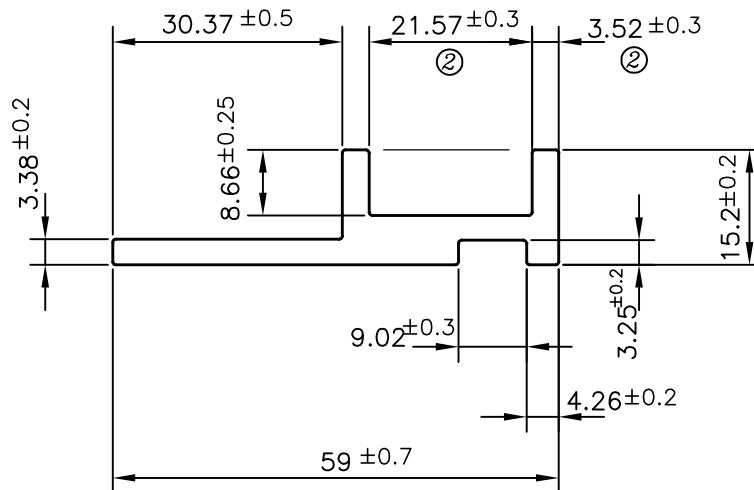



P-11579

S3217

24626

**ISSUE (2) :-****DIMENSION CHANGED FROM:-**

-  21.97 mm. TO 21.57 mm.
-  3.12 mm. TO 3.52 mm.
-  **WEIGHT ALSO CHANGED FROM**  
0.859 Kg/M TO 0.868 Kg/M



SYMBOL OF QUALITY  
AN ISO 9001 COMPANY

**JINDAL ALUMINIUM LTD.**  
BANGALORE-560073 (INDIA)

	NAME	DATE
DRAWN	PARVESH	28-08-2013
CHECKED		
APPROVED	S.S.GARG	29-08-2013
SCALE		1:1
AREA mm <sup>2</sup>		321.578
PERIMETER mm.		169.816
WEIGHT kg/m		0.868
DRAWING No.	SECTION No.	
P-11579	-	
S3217	S3217 (ISSUE-2)	
24626	24626	

1. ALL DIMENSIONS ARE IN mm.
2. ROUND OFF ALL SHARP CORNERS WITH 0.40 mm.
3. TOLERANCES WILL BE AS PER BS:EN-755-9, UNLESS OTHERWISE SPECIFIED

PARTY'S NAME	MARVEL MECHATRONICS PVT. LTD., CHENNAI
PARTY'S DRAWING No.	B13-159-05+EXTR BLAN
ALLOY & TEMPER	6061 T6
DESCRIPTION	TELECOMMUNICATION SECTION