

P-6675-1  
 S1859  
 24798

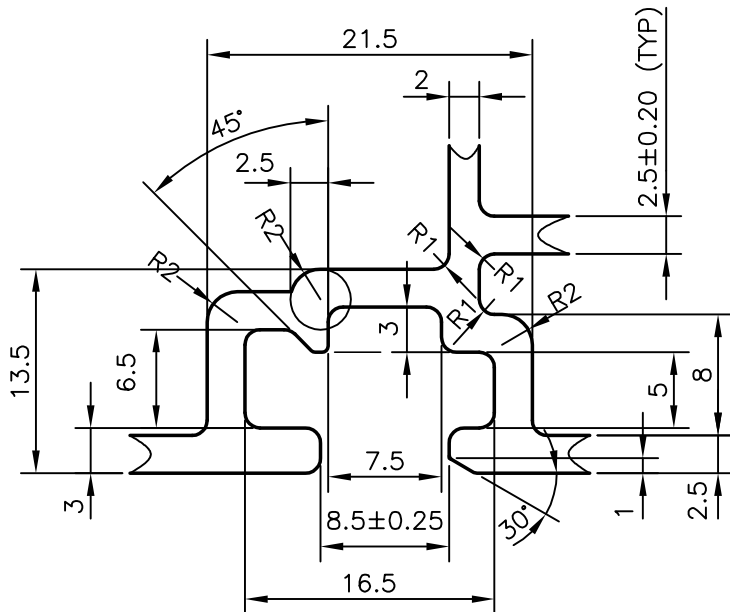

UNSPECIFIED RADII 1.0 mm (TYP)  
 \* = R 0.5 ( 11 PLACES )

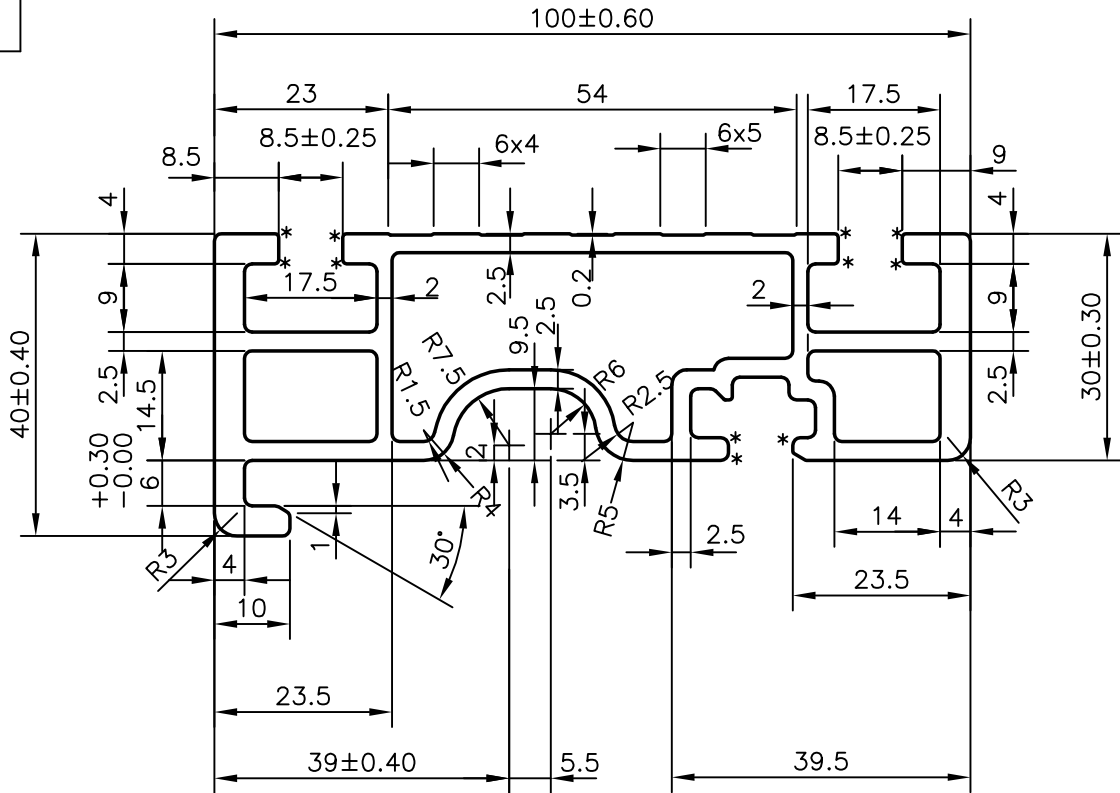

**JINDAL ALUMINIUM LTD.**  
 BANGALORE-560073 (INDIA)

	NAME	DATE
DRAWN	J.P.KAUSHIK	29-09-2006
CHECKED		
APPROVED		

- ALL DIMENSIONS ARE IN mm.
- ROUND OFF ALL SHARP CORNERS WITH 0.50 mm.
- TOLERANCES WILL BE AS PER IS:6477-1983 UNLESS OTHERWISE SPECIFIED

SCALE	1:1
AREA mm <sup>2</sup>	1008.206
PERIMETER mm.	414.736
WEIGHT kg/m	2.722

PARTY'S NAME	KIRLOSKAR TOYODA TEXTILE MACHINERY (P) LTD., BANGALORE
PARTY'S DRAWING No.	R6101-04010
ALLOY & TEMPER	6063 T6
DESCRIPTION	TEXTILE SECTION

DRAWING No.	SECTION No.
P-6675-1	-
S1859	S1859
24798	24798