

P-9416-1

S2253

24815

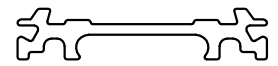

SCALE 1:1

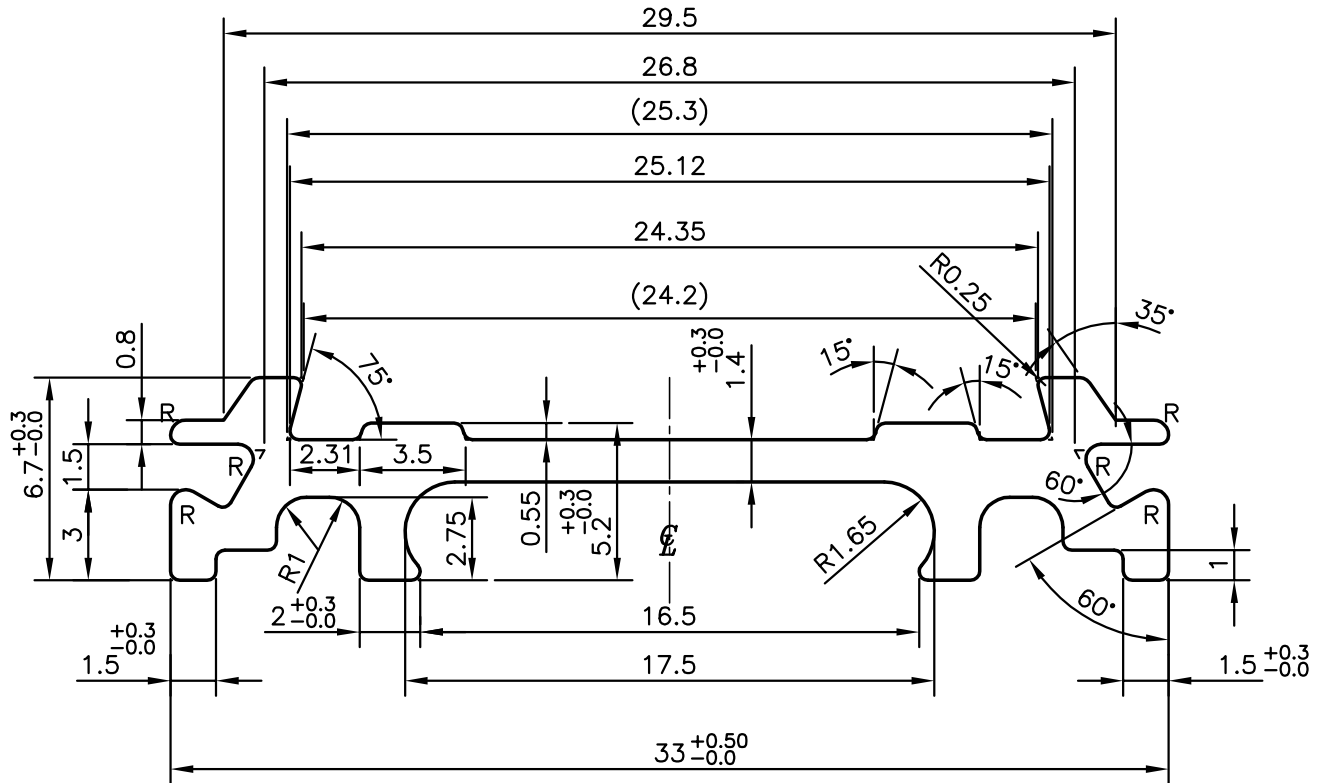

1. TWIST & BEND = 1.70 mm/M
2. STRAIGHTNESS = 1.70 mm/M
3. SECTION IS SYMMETRY ABOUT CENTER LINE
4. R = 0.50mm RADIUS (6 PLACES)
5. UNSPECIFIED RADIUS WILL BE 0.30mm



SYMBOL OF QUALITY
AN ISO 9001 COMPANY

JINDAL ALUMINIUM LTD.
BANGALORE-560073 (INDIA)

	NAME	DATE
DRAWN	RAGHAVENDRA	17-08-2009
CHECKED		
APPROVED		

1. ALL DIMENSIONS ARE IN mm.
2. ROUND OFF ALL SHARP CORNERS WITH 0.30 mm.
3. TOLERANCES WILL BE AS PER IS:3965-1981 UNLESS OTHERWISE SPECIFIED

SCALE	4:1
AREA mm ²	85.45
PERIMETER mm.	107.252
WEIGHT kg/m	0.231

PARTY'S NAME	LAKZER CARD CLOTHING INDIA PCT. LTD.,COIMBATORE
PARTY'S DRAWING No.	LAK-TYPE-G-CLIP-100
ALLOY & TEMPER	63400 T6
DESCRIPTION	TEXTILE SECTION

DRAWING No.	SECTION No.
P-9416-1	-
S2253	S2253
24815	24815