

P-10991

X1562

24821

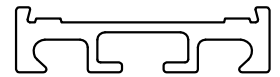

1:1

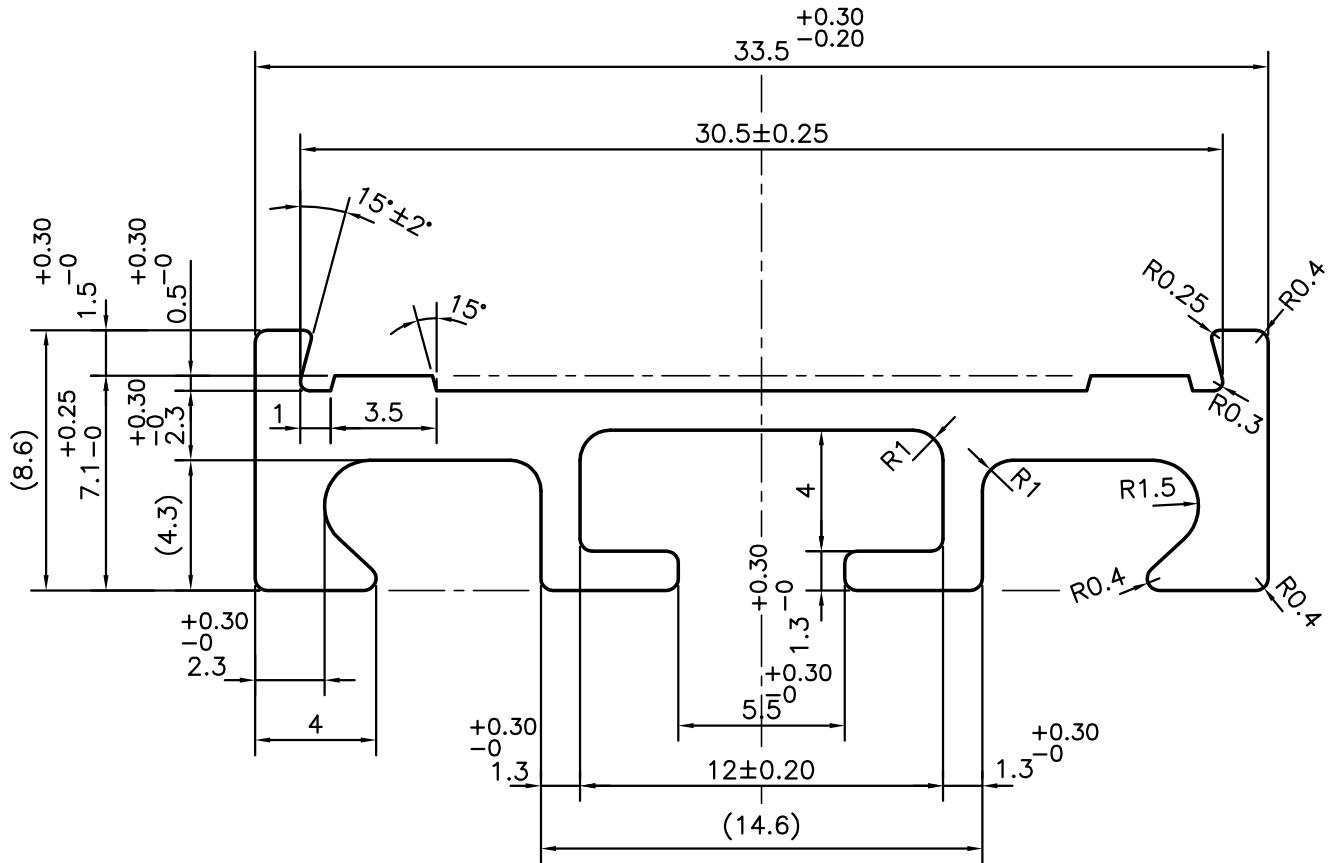

STRAIGHTNESS & TWIST TO BE MAINTAINED WITH IN 1.0mm/M



SYMBOL OF QUALITY
AN ISO 9001 COMPANY

JINDAL ALUMINIUM LTD.
BANGALORE-560073 (INDIA)

	NAME	DATE
DRAWN	J.P.KAUSHIK	23-05-2011
CHECKED		
APPROVED	S.S.GARG	09-11-2011
SCALE		4:1
AREA mm ²		120.762
PERIMETER mm.		130.187
WEIGHT kg/m		0.326
DRAWING No.	SECTION No.	
P-10991	-	
X1562	X1562	
24821	24821	

1. ALL DIMENSIONS ARE IN mm.
2. ROUND OFF ALL SHARP CORNERS WITH 0.40 mm.
3. TOLERANCES WILL BE AS PER, IS:3965-1981 UNLESS OTHERWISE SPECIFIED

PARTY'S NAME	THE INDIAN CARD CLOTHING CO. LTD., PUNE
PARTY'S DRAWING No.	EXP/SE-522/E
ALLOY & TEMPER	HE9 WP
DESCRIPTION	TEXTILE SECTION