

P-13027

S3866

24868

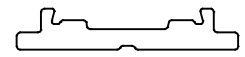

SCALE 1:1

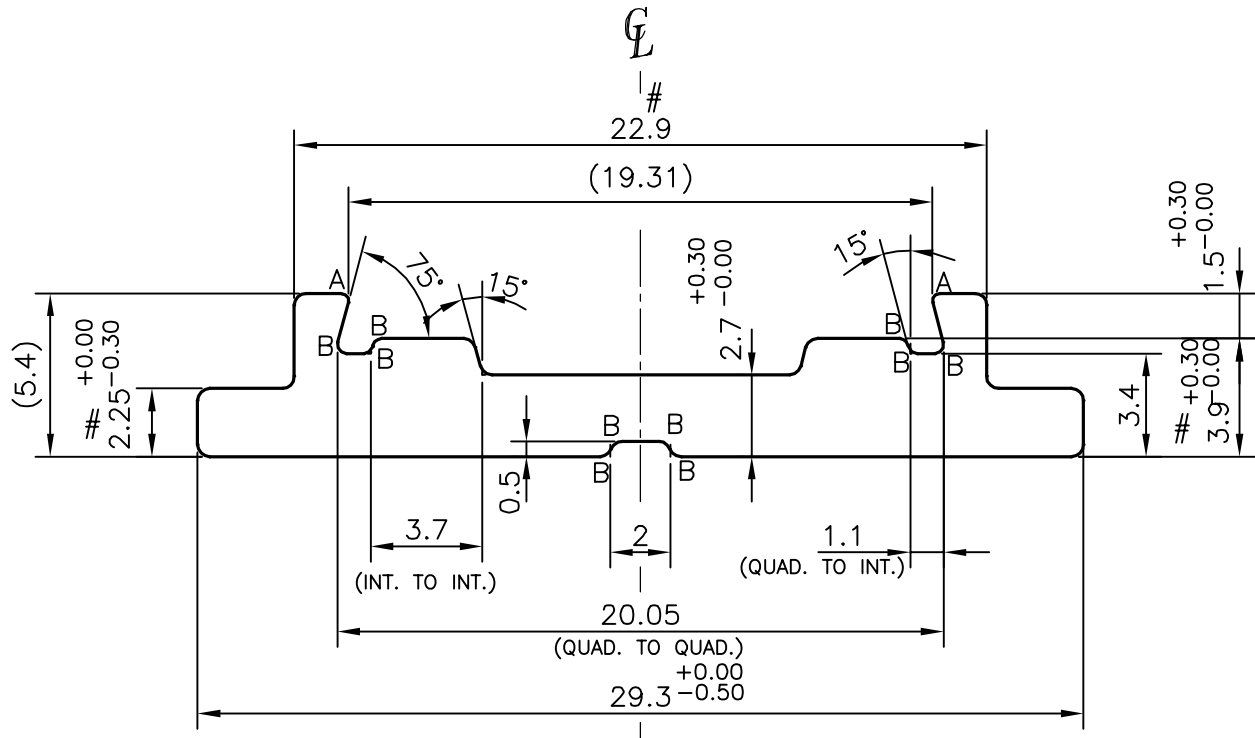

= CRITICAL DIMENSIONS

A = 0.25 mm RADIUS (2 PLACES)

B = 0.30 mm RADIUS (10 PLACES)

TOLERANCES ON OVERALL WIDTHS & WIDTHS ACROSS FLATS OF BARS, & REGULAR SECTIONS

UPTO 6.40mm - ±0.20	UPTO 32.0mm - ±0.38	UPTO 120.0mm - ±0.85	1. STRAIGHTNESS=1.7mm/M 2. TWIST=1.7mm/M 3. ANGULARITY= ±2° 4. FLATNESS =0.3mm
UPTO 10.0mm - ±0.23	UPTO 50.0mm - ±0.46	UPTO 160.0mm - ±1.02	
UPTO 12.0mm - ±0.25	UPTO 60.0mm - ±0.53	UPTO 200.0mm - ±1.14	
UPTO 16.0mm - ±0.28	UPTO 80.0mm - ±0.69	UPTO 250.0mm - ±1.40	
UPTO 25.0mm - ±0.30	UPTO 100.0mm - ±0.75	UPTO 320.0mm - ±1.70	

SYMBOL OF QUALITY
AN ISO 9001 COMPANY**JINDAL ALUMINIUM LTD.**
BANGALORE-560073 (INDIA)

	NAME	DATE
DRAWN	SRIYATHSA	19-09-2013
CHECKED		
APPROVED	S.S.GARG	23-09-2013

1. ALL DIMENSIONS ARE IN mm.
2. ROUND OFF ALL SHARP CORNERS WITH 0.40 mm.
3. TOLERANCES WILL BE AS PER IS:3965-1981, UNLESS OTHERWISE SPECIFIED

SCALE	4:1
AREA mm ²	93.513
PERIMETER mm.	74.780
WEIGHT kg/m	0.252

PARTY'S NAME	SANMIT CARD CLOTHING INDIA PVT. LTD., COIMBATORE	DRAWING No.	P-13027	SECTION No.	-
PARTY'S DRAWING No.	SANMIT-TYPE-C-481/R1 & AS PER AUTOCAD DRAWING		S3866		S3866
ALLOY & TEMPER	HE9 WP		24868		24868
DESCRIPTION	TEXTILE SECTION				