

P-12115
S3521
25222

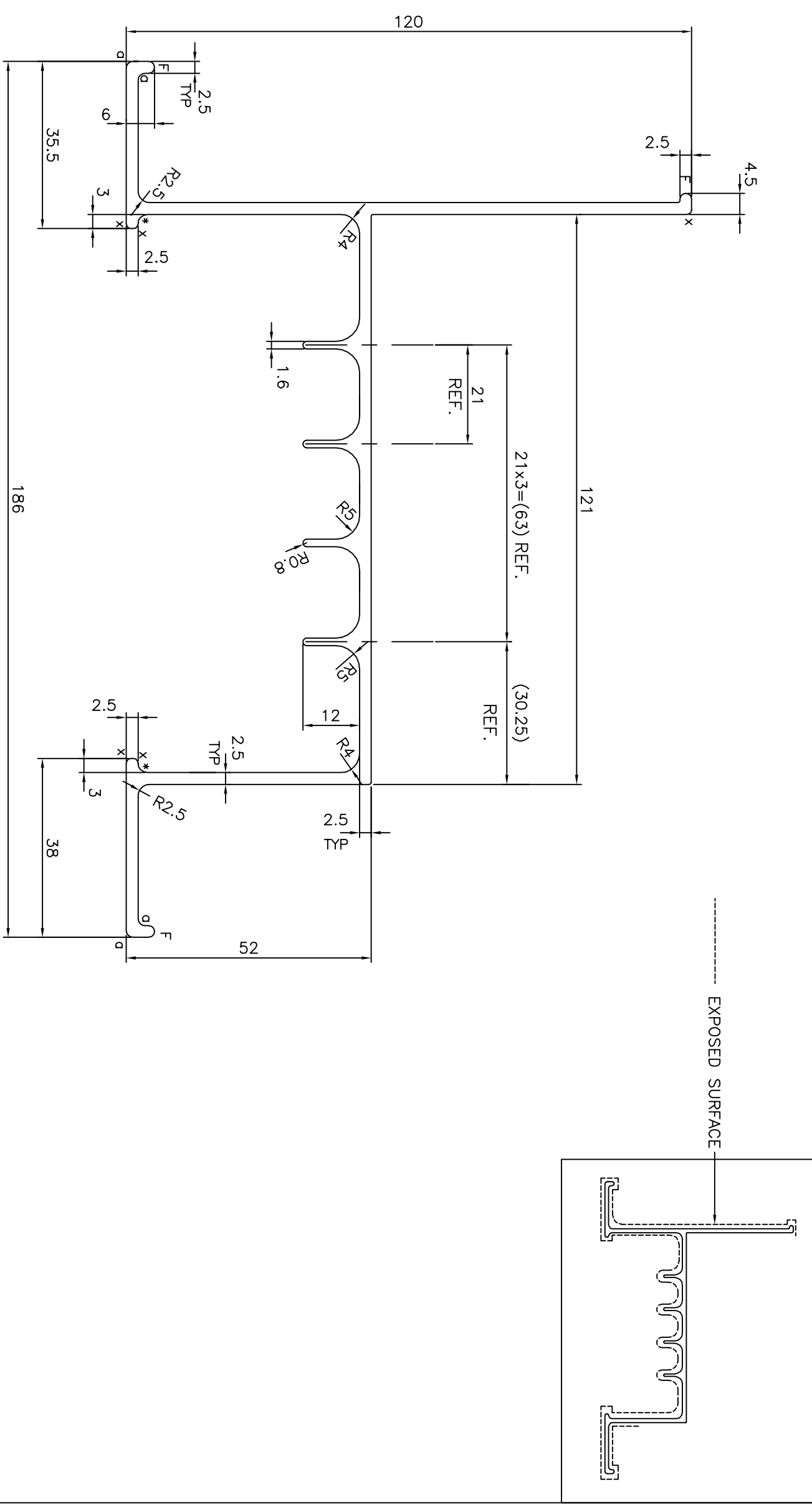

F = FULL RADIUS ( 3 PLACES )  
 \* = 2.0 RADIUS ( 2 PLACES )  
 x = 1.0 RADIUS ( 5 PLACES )  
 d = 1.5 RADIUS ( 4 PLACES )

 <b>JINDAL ALUMINIUM LTD.</b> BANGALORE-560073 (INDIA)		SYMBOL OF QUALITY AN ISO 9001 COMPANY
1. ALL DIMENSIONS ARE IN mm. 2. ROUND OFF ALL SHARP CORNERS WITH 0.40 mm. 3. TOLERANCES WILL BE AS PER IS:3965-1981 UNLESS OTHERWISE SPECIFIED		
PARTY'S NAME	DELTA INDIA SWITCHGEARS PVT. LTD., COCHIN	
PARTY'S DRAWING No.	SAP 002	
ALLOY & TEMPER	6063 T6	
DESCRIPTION	ELECTRICAL SECTION	
DRAWN	NAME	DATE
CHECKED	J.P.KAUSHIK	07-10-2012
APPROVED	S.S.GARG	26-10-2012
SCALE	1:1	
AREA	mm <sup>2</sup>	1046.974
PERIMETER	mm.	802.375
WEIGHT	kg/m	2.827
DRAWING No.	SECTION No.	
P-12115	-	
S3521	S3521	
25222	25222	