

P-12975-2

S3853

25249

EXPOSED SURFACE

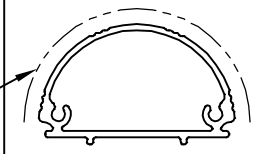

SCALE:- 1:1

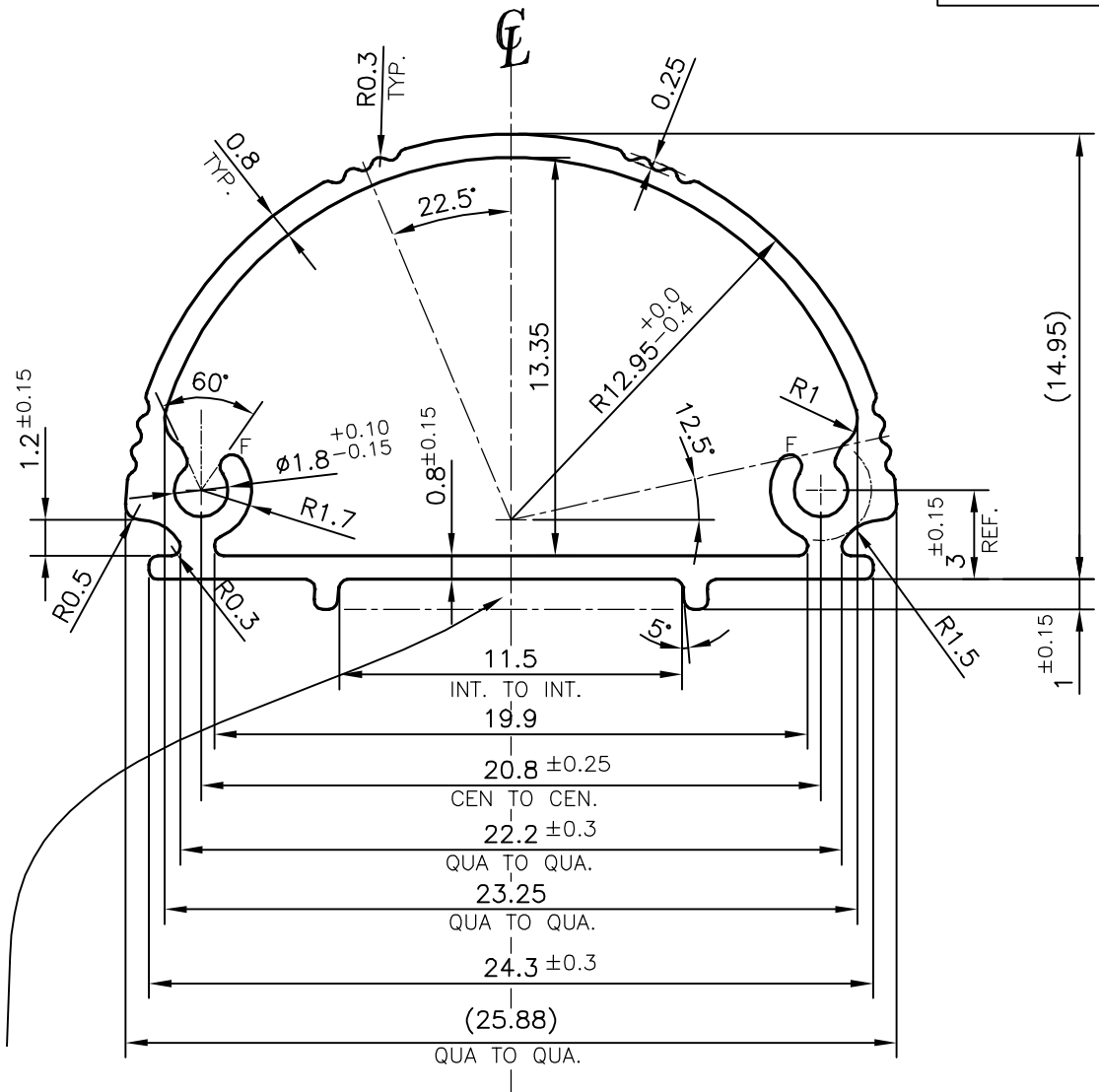

STRAIGHTNESS=1.7mm/M

F = FULL RADIUS (2 PLACES)

TOLERANCES ON OVERALL WIDTHS & WIDTHS ACROSS FLATS OF BARS, & REGULAR SECTIONS

UPTO 6.40mm - ±0.20	UPTO 32.0mm - ±0.38	UPTO 120.0mm - ±0.85	UPTO 320.00mm - ±1.70
UPTO 10.0mm - ±0.23	UPTO 50.0mm - ±0.46	UPTO 160.0mm - ±1.02	
UPTO 12.0mm - ±0.25	UPTO 60.0mm - ±0.53	UPTO 200.0mm - ±1.14	
UPTO 16.0mm - ±0.28	UPTO 80.0mm - ±0.69	UPTO 250.0mm - ±1.40	
UPTO 25.0mm - ±0.30	UPTO 100.0mm - ±0.75	UPTO 300.0mm - ±1.65	



SYMBOL OF QUALITY
AN ISO 9001 COMPANY

JINDAL ALUMINIUM LTD.
BANGALORE-560073 (INDIA)

	NAME	DATE
DRAWN	PARVESH	29-08-2013
CHECKED		
APPROVED	S.S.GARG	07-09-2013

1. ALL DIMENSIONS ARE IN mm.
2. ROUND OFF ALL SHARP CORNERS WITH 0.30 mm.
3. TOLERANCES WILL BE AS PER IS:6477-1983 , UNLESS OTHERWISE SPECIFIED

SCALE	4:1
AREA mm ²	64.531
PERIMETER mm.	77.353
WEIGHT kg/m	0.174

PARTY'S NAME	AARON LIGHTS PVT. LTD., BANGALORE
PARTY'S DRAWING No.	Arp_0046_03
ALLOY & TEMPER	6063 T6
DESCRIPTION	TUBE LIGHT SECTION

DRAWING No.	SECTION No.
P-12975-2	-
S3853	S3853
25249	25249