

P-16752-2

S5278

25379

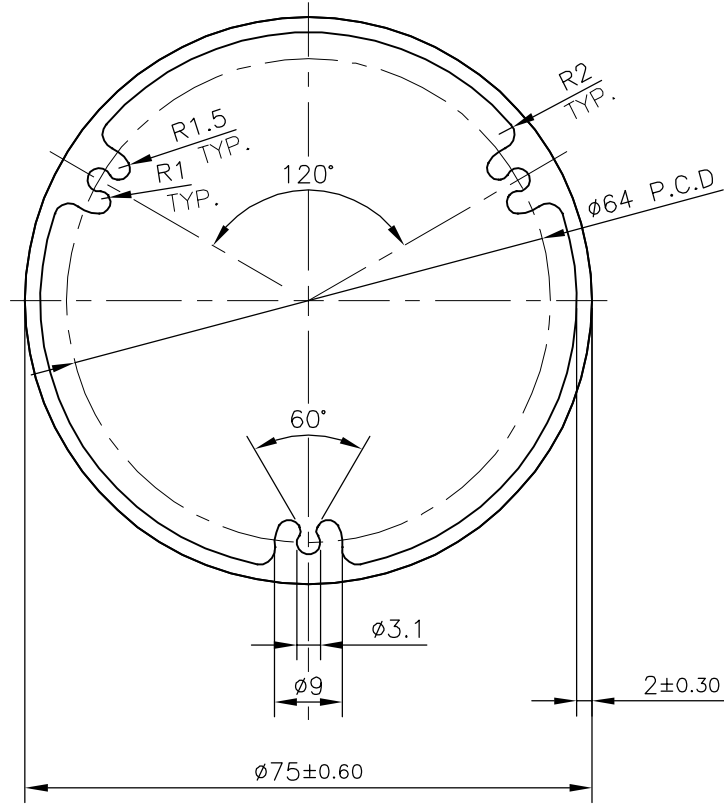

OVALITY :  $\pm 1.30$  mm

TOLERANCES ON OVERALL DIMENSIONS OF HOLLOW SECTIONS

UPTO 20.0mm -  $\pm 0.30$   
 UPTO 30.0mm -  $\pm 0.38$   
 UPTO 40.0mm -  $\pm 0.45$   
 UPTO 50.0mm -  $\pm 0.52$   
 UPTO 60.0mm -  $\pm 0.60$

UPTO 80.0mm -  $\pm 0.70$   
 UPTO 100.0mm -  $\pm 0.80$   
 UPTO 120.0mm -  $\pm 0.90$   
 UPTO 140.0mm -  $\pm 1.00$   
 UPTO 160.0mm -  $\pm 1.14$

UPTO 180.0mm -  $\pm 1.27$   
 UPTO 200.0mm -  $\pm 1.40$   
 UPTO 225.0mm -  $\pm 1.52$

1. STRAIGHTNESS=1.7mm/M
2. TWIST=1.7mm/M
3. ANGULARITY=  $\pm 2^\circ$
4. FLATNESS =0.006xWIDTH



SYMBOL OF QUALITY  
AN ISO 9001 COMPANY

**JINDAL ALUMINIUM LTD.**  
 BANGALORE-560073 (INDIA)

	NAME	DATE
DRAWN	KIRAN	24-01-2017
CHECKED		
APPROVED	B.NATARAJ	27-01-2017

1. ALL DIMENSIONS ARE IN mm.
2. ROUND OFF ALL SHARP CORNERS WITH 0.50 mm.
3. TOLERANCES WILL BE AS PER IS:6477-1983, UNLESS OTHERWISE SPECIFIED

SCALE	1:1
AREA mm <sup>2</sup>	595.358
PERIMETER mm.	235.619
WEIGHT kg/m	1.607

PARTY'S NAME	JDIANM LIGHTING (P) LTD., VASAI
PARTY'S DRAWING No.	AS PER DRAWING & REQUIREMENT
ALLOY & TEMPER	HE9 WP
DESCRIPTION	TUBE LIGHT SECTION

DRAWING No.	SECTION No.
P-16752-2	
S5278	S5278
25379	25379