

P-17516-1

S5530

25390

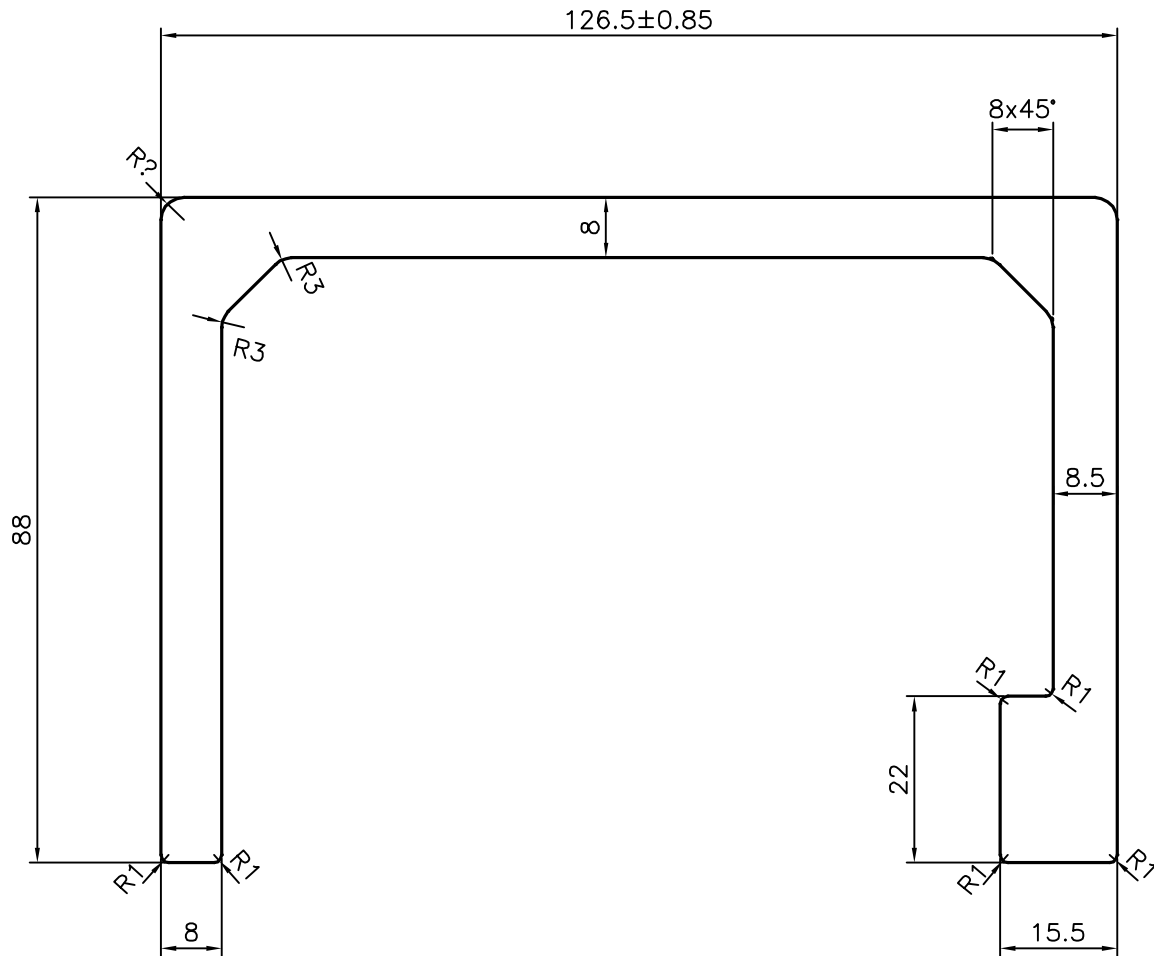

TOLERANCES ON OVERALL WIDTHS & WIDTHS ACROSS FLATS OF BARS, & REGULAR SECTIONS

UPTO 6.40mm - ±0.20	UPTO 32.0mm - ±0.38	UPTO 120.0mm - ±0.85	UPTO 320.00mm - ±1.70
UPTO 10.0mm - ±0.23	UPTO 50.0mm - ±0.46	UPTO 160.0mm - ±1.02	
UPTO 12.0mm - ±0.25	UPTO 60.0mm - ±0.53	UPTO 200.0mm - ±1.14	
UPTO 16.0mm - ±0.28	UPTO 80.0mm - ±0.69	UPTO 250.0mm - ±1.40	
UPTO 25.0mm - ±0.30	UPTO 100.0mm - ±0.75	UPTO 300.0mm - ±1.65	



SYMBOL OF QUALITY  
AN ISO 9001 COMPANY

**JINDAL ALUMINIUM LTD.**  
BANGALORE-560073 (INDIA)

	NAME	DATE
DRAWN	J.P.KAUSHIK	14-10-2017
CHECKED		
APPROVED	B.NATARAJA	18-10-2017
SCALE		1:1
AREA mm <sup>2</sup>		2546.053
PERIMETER mm.		587.961
WEIGHT kg/m		6.874
DRAWING No.	SECTION No.	
P-17516-1	-	
S5530	S5530	
25390	25390	

1. ALL DIMENSIONS ARE IN mm.
2. ROUND OFF ALL SHARP CORNERS WITH 0.40 mm.
3. TOLERANCES WILL BE AS PER IS:3965-1981 , UNLESS OTHERWISE SPECIFIED

PARTY'S NAME	NARMADA SWITCHGEAR PVT. LTD., BHOPAL
PARTY'S DRAWING No.	NSPL/25.09.2017/01
ALLOY & TEMPER	6063 T6
DESCRIPTION	MISC. CHANNEL