

P-21339

25400

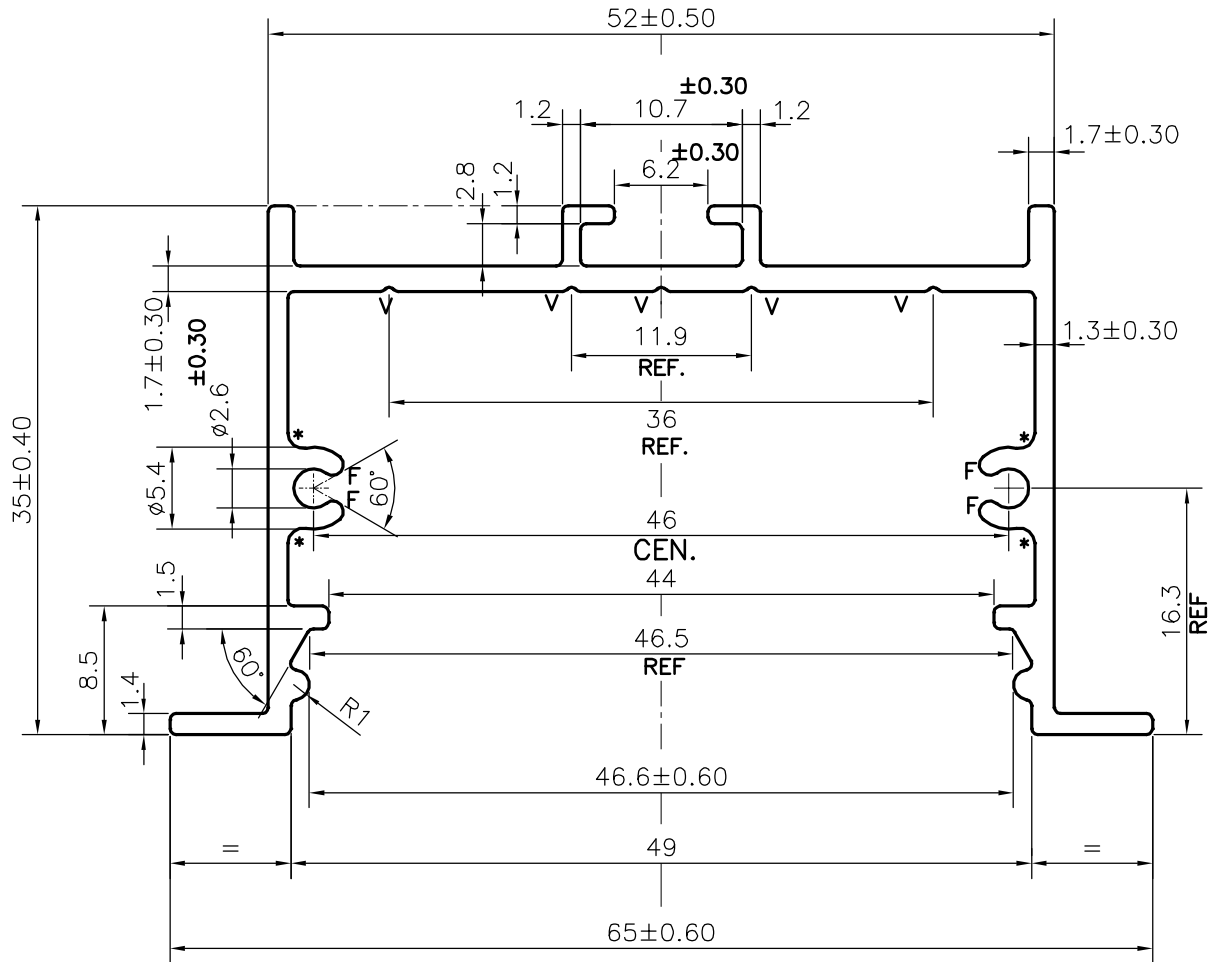
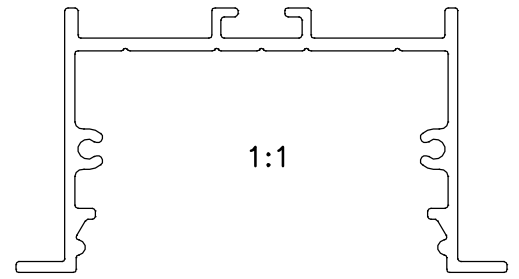

F = FULL RADIUS (2 PLACES)
 * = RADIUS 1.0 (4 PLACES)
 V = V GROOVE 0.3x90° (5 PLACES)

1) THE WELDING LINE IN THE EXPOSED SURFACE OF PROFILE IS UNAVOIDABLE. 2) PLEASE SPECIFY IMPORTANT SIZES. 3) PLEASE SPECIFY IF THIS PROFILE MATCHES WITH OTHER PROFILES. 4) PLEASE SPECIFY EXPOSED SURFACE. OTHERWISE CONSIDERED AS NO EXPOSED SURFACE. 5) FINISH :- MILL FINISH / ANODIZING / POWDER COATING



SYMBOL OF QUALITY
 AN ISO 9001 COMPANY

JINDAL ALUMINIUM LTD.
 BANGALORE-560073 (INDIA)

	NAME	DATE
DRAWN	J.P.KAUSHIK	18-08-2020
CHECKED		
APPROVED	B.NATARAJA	07-09-2020

1. ALL DIMENSIONS ARE IN mm.
 2. ROUND OFF ALL SHARP CORNERS WITH 0.40 mm.
 3. TOLERANCES WILL BE AS PER IS:3965-1981, UNLESS OTHERWISE SPECIFIED

SCALE	2:1
AREA mm ²	252.366
PERIMETER mm.	320.647
WEIGHT kg/m	0.681

PARTY'S NAME	LUMENS AIRCON PVT. LTD., BANGALORE	DRAWING No.	P-21339	SECTION No.	-
PARTY'S DRAWING No.	AS PER DRAWING		25400		25400
ALLOY & TEMPER	6063 T6				
DESCRIPTION	ELECTRICAL SECTION				