

P-13324-1

S4040

25825

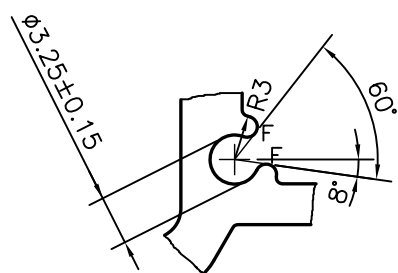
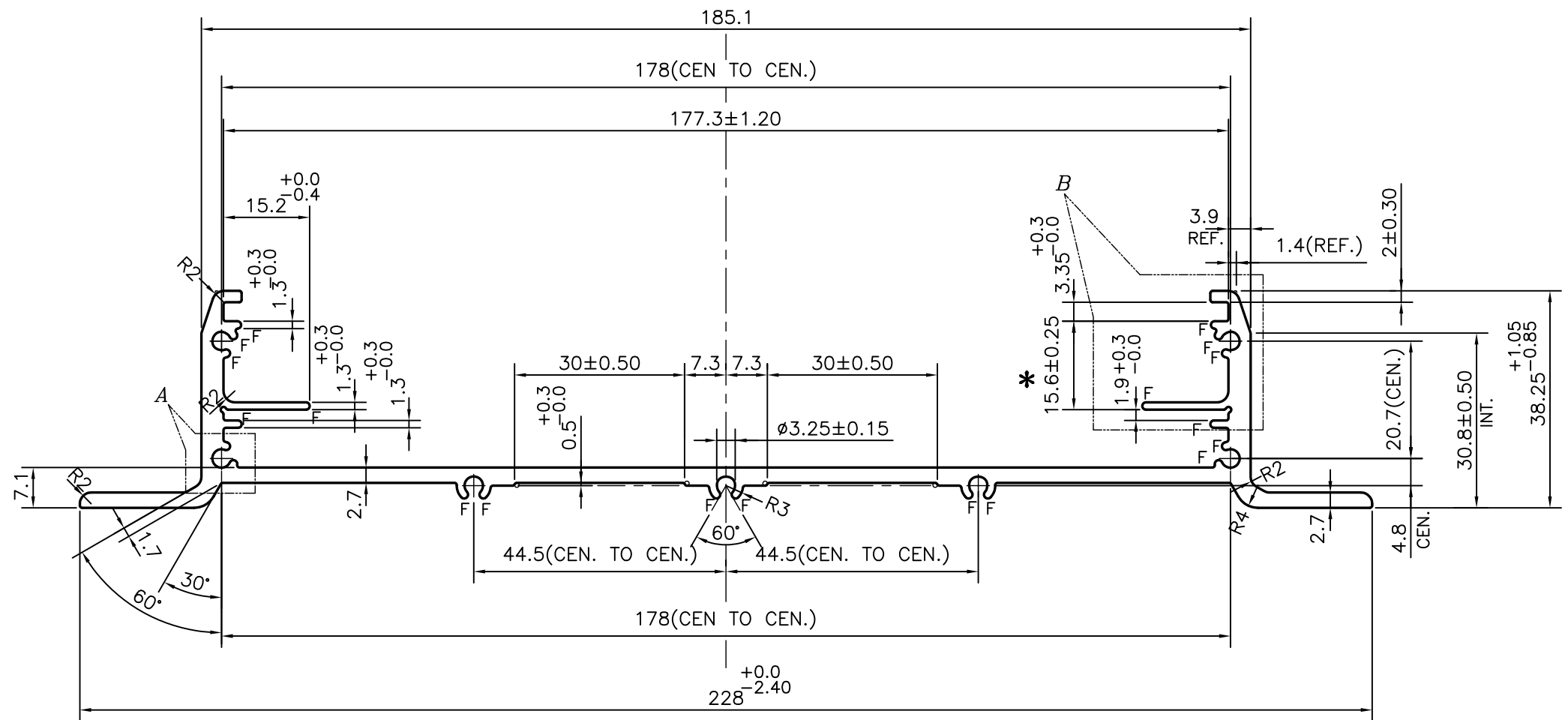

DETAIL OF "A"
SCALE 2:1

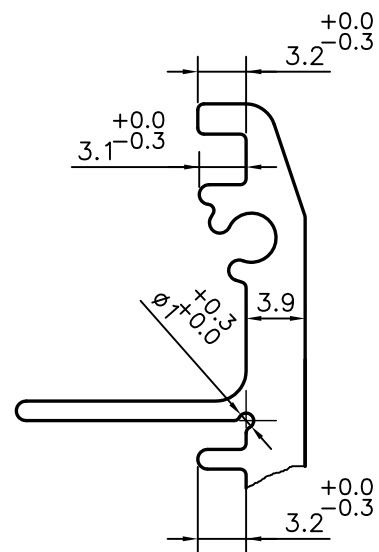

DETAIL OF "B"
SCALE 2:1

*** MARKED DIMENSION IS IMPORTANT**

- 1. ANGULARITY = ±1°
- F = FULL RADIUS(20 PLACES)

 SYMBOL OF QUALITY AN ISO 9001 COMPANY	JINDAL ALUMINIUM LTD. BANGALORE-560073 (INDIA)	NAME	DATE
		DRAWN	J.P.KAUSHIK 16-01-2014
1. ALL DIMENSIONS ARE IN mm. 2. ROUND OFF ALL SHARP CORNERS WITH 0.40 mm. 3. TOLERANCES WILL BE AS PER BS:EN-755-9 UNLESS OTHERWISE SPECIFIED		CHECKED	
		APPROVED	S.S.GARG 21-02-2014
PARTY'S NAME BHARAT ELECTRONICS LTD., SAHIBABAD		SCALE	1:1
		AREA mm ²	947.605
PARTY'S DRAWING No. 5161 417 401 96		PERIMETER mm.	738.104
		WEIGHT kg/m	2.559
ALLOY & TEMPER 6060 T5		DRAWING No.	SECTION No.
		P-13324-1	-
DESCRIPTION MISC. SECTION		S4040	S4040
		25825	25825