

P-2139-2

S313

7928

26215

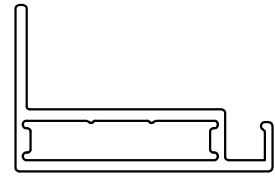

SCALE 1:1

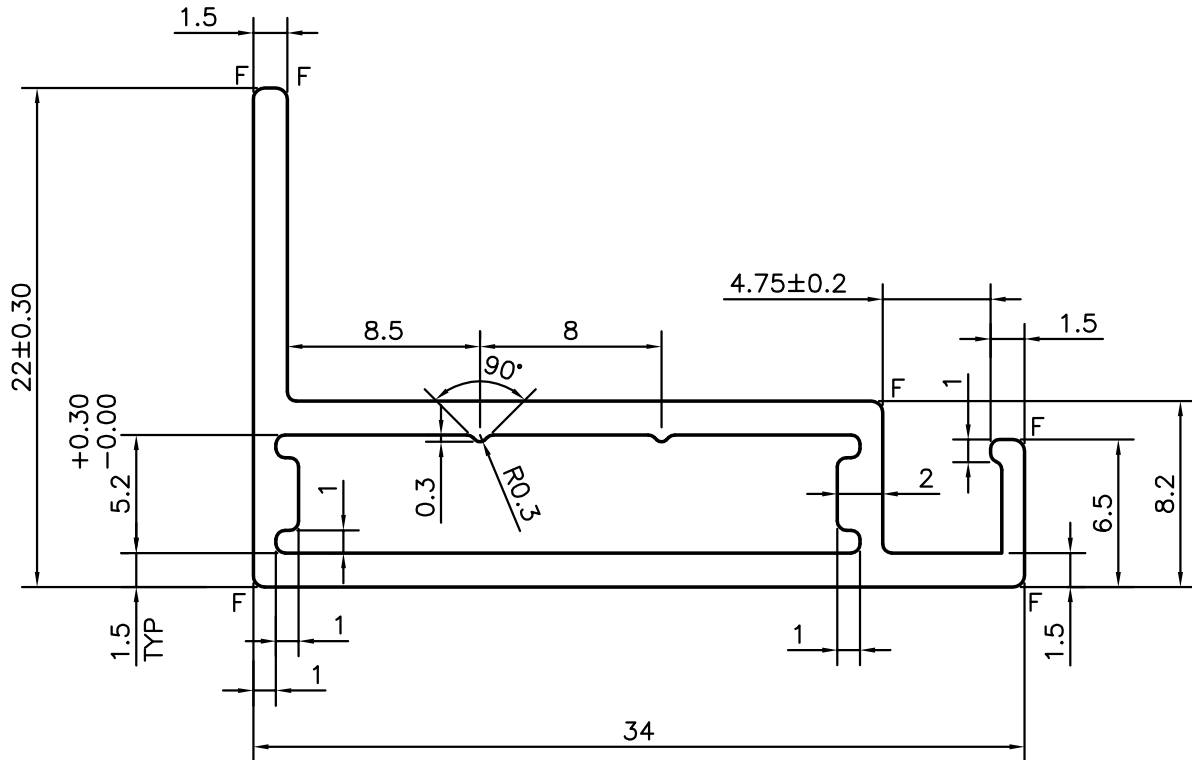

MATCHING SECTION DRAWING NO. 26216

F = 0.50 mm RADIUS (6 PLACES)



SYMBOL OF QUALITY
AN ISO 9001 COMPANY

JINDAL ALUMINIUM LTD.
BANGALORE-560073 (INDIA)

	NAME	DATE
DRAWN	P.KULKARNI	09-01-1999
CHECKED		
APPROVED		

1. ALL DIMENSIONS ARE IN mm.
2. ROUND OFF ALL SHARP CORNERS WITH 0.40 mm.
3. TOLERANCES WILL BE AS PER IS:6477-1983, UNLESS OTHERWISE SPECIFIED

SCALE	3:1
AREA mm ²	135.795
PERIMETER mm.	120.905
WEIGHT kg/m	0.365

PARTY'S NAME	WEBEL-SL ENERGY SYSTEMS LTD., CALCUTTA
PARTY'S DRAWING No.	AS PER SAMPLE
ALLOY & TEMPER	HE9 WP
DESCRIPTION	SOLAR SECTION

DRAWING No.	SECTION No.
P-2139-2	-
S313	S313
7928	7928
26215	26215