

P-6999

S1928

26261

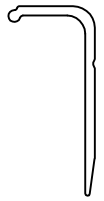

SCALE 1:1

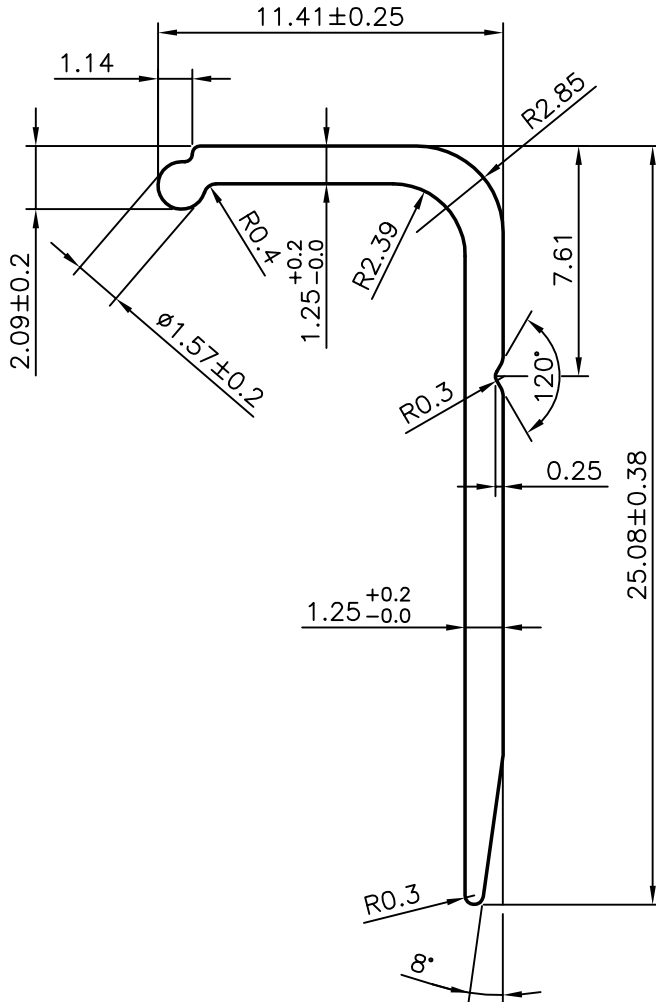

NOTE:-

1. FLATNESS =  $\pm 0.25$
2. STRAIGHTNESS =  $1.7$  mm/m
3. TWIST =  $1.7$  mm/m
4. ANGULARITY =  $\pm 2^\circ$



SYMBOL OF QUALITY  
AN ISO 9001 COMPANY

**JINDAL ALUMINIUM LTD.**  
BANGALORE-560073 (INDIA)

	NAME	DATE
DRAWN	PRASANN.H	01-02-2007
CHECKED		
APPROVED		
SCALE		4:1
AREA mm <sup>2</sup>		42.011
PERIMETER mm.		70.315
WEIGHT kg/m		0.113
DRAWING No.	SECTION No.	
P-6999	-	
S1928	S1928	
26261	26261	

1. ALL DIMENSIONS ARE IN mm.
2. ROUND OFF ALL SHARP CORNERS WITH 0.4 mm.
3. TOLERANCES WILL BE AS PER DIN EN12020-2 UNLESS OTHERWISE SPECIFIED

PARTY'S NAME	TATA BP SOLAR INDIA LIMITD., BANGALORE
PARTY'S DRAWING No.	DVP1256
ALLOY & TEMPER	HE9 'P'
DESCRIPTION	GLASS RETAINING ANGLE