

9139

26635

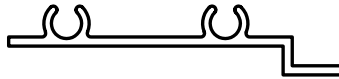

1:1

TOLERANCE FOR BEST CHOICE,  
FOR OTHER PARTY'S GENERAL TOLERANCE  
WILL BE APPLICABLE

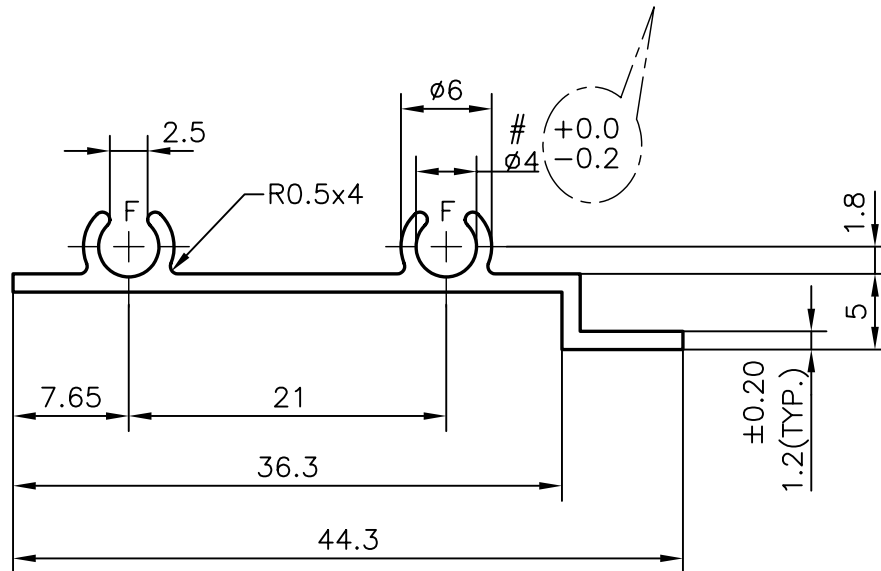

UTS: -19 kgf/mm<sup>2</sup>  
F = FULL RADIUS(4)

ISSUE-2:- TOLERANCE ADDAD FOR  
# MARKED DIMENSION  
ON 20/10/2005

**JINDAL ALUMINIUM LTD.**

**BANGALORE-560073**

JINDAL ALUMINIUM LTD. BANGALORE-560073		NAME	DATE
		DRAWN	R.D.Sharma
1. ALL DIMENSIONS ARE IN mm. 2. ROUND OFF ALL SHARP CORNERS WITH 0.4 mm. 3. TOLERANCES WILL BE AS PER IS: 3965-1981 ,UNLESS OTHERWISE SPECIFIED		CHECKED	
		APPROVED	
PARTY'S NAME	BETA INDUSTRIAL EST.,DUBAI	SCALE	1:1 & 2:1
PARTY'S DRAWING No.	SECTION-06	WEIGHT kg/m	0.204
ALLOY & TEMPER	HE9 WP (6063 T6)	SECTION No.	26635
LENGTH	5850 mm.	DRAWING No.	26635 -ISSUE-2
DESCRIPTION	DAMPER FRAME SCREW		