

P-15224

26913

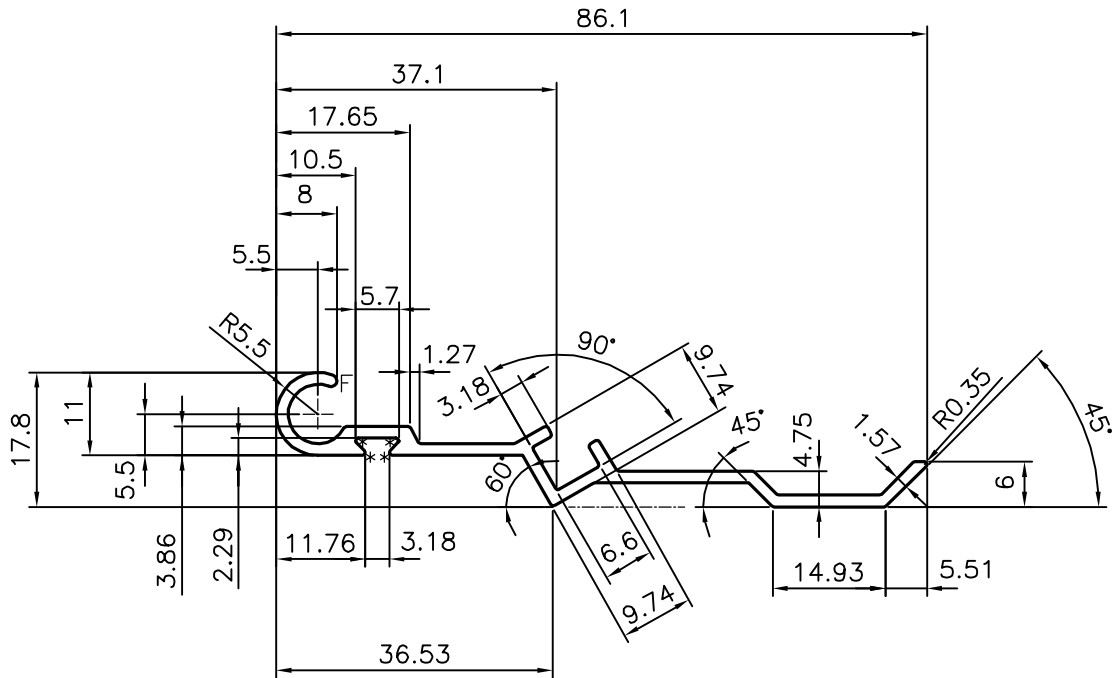

GENERAL WALL THICKNESS :- 1.57 mm  
 F = FULL RADIUS  
 \* = 0.35 RADIUS( 4 PLACES)



SYMBOL OF QUALITY  
 AN ISO 9002 COMPANY

**JINDAL ALUMINIUM LTD.**  
 BANGALORE-560073 (INDIA)

|          | NAME        | DATE       |
|----------|-------------|------------|
| DRAWN    | J.P.KAUSHIK | 05-10-2015 |
| CHECKED  |             |            |
| APPROVED | S.S.GARG    | 13-10-2015 |

1. ALL DIMENSIONS ARE IN mm.
2. ROUND OFF ALL SHARP CORNERS WITH 0.40 mm.
3. TOLERANCES WILL BE AS PER BS:EN-755-9, UNLESS OTHERWISE SPECIFIED

|                      |         |
|----------------------|---------|
| SCALE                | 1:1     |
| AREA mm <sup>2</sup> | 191.525 |
| PERIMETER mm.        | 235.675 |
| WEIGHT kg/m          | 0.517   |

|                     |  |
|---------------------|--|
| PARTY'S NAME        | KBE INTERNATIONAL SAL, LEBANON MIDDLE EAST |
| PARTY'S DRAWING No. | 11592                                      |
| ALLOY & TEMPER      | 6063 T6                                    |
| DESCRIPTION         | AIR GRILL SECTION                          |

| DRAWING No. | SECTION No. |
|-------------|-------------|
| P-15224     | -           |
| 26913       | 26913       |
|             |             |
|             |             |