

P-3680-2

9180

27022

NOTE: -

1. ALL OUTER FACES TO BE CONCAVE, NO CONVEXITY PERMISSIBLE.
2. EXTERNAL SURFACES TO BE FREE FROM HEAVY DIE LINES.
3. CONCENTRICITY IS IMPORTANT.

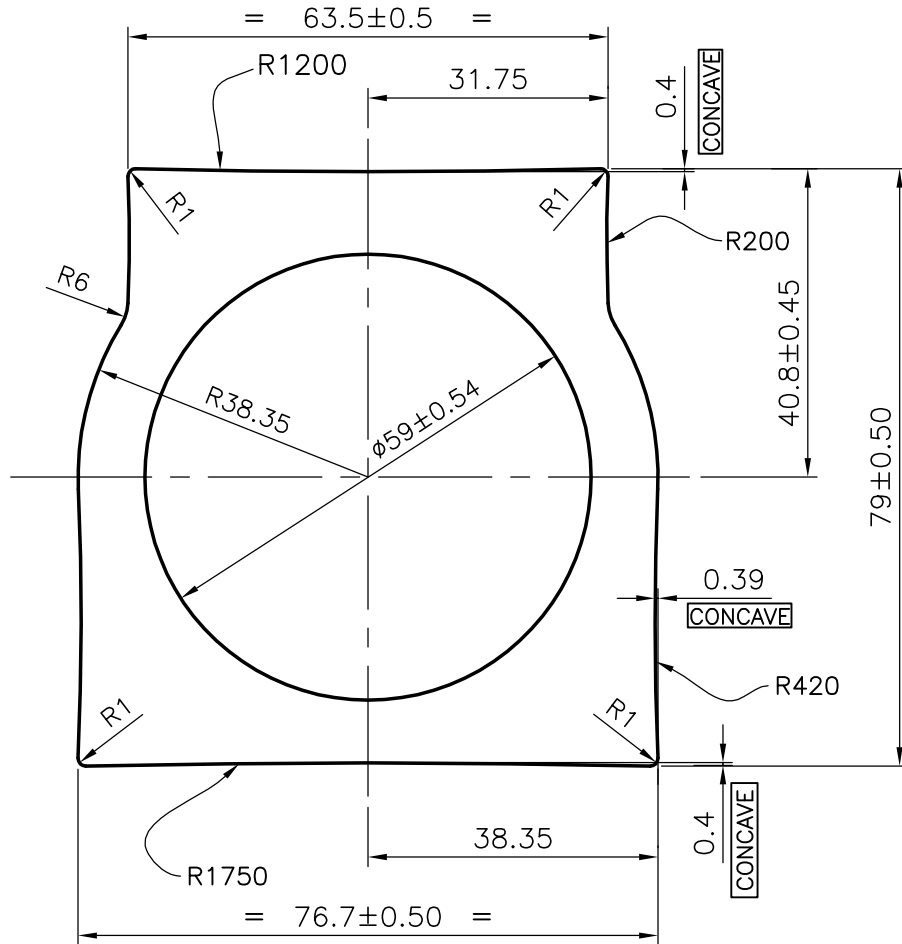

SYMBOL OF QUALITY  
AN ISO 9002 COMPANY

**JINDAL ALUMINIUM LTD.**  
BANGALORE-560073 (INDIA)

	NAME	DATE
DRAWN	RAGHAVENDRA	12-03-02
CHECKED		
APPROVED		

1. ALL DIMENSIONS ARE IN mm.
2. ROUND OFF ALL SHARP CORNERS WITH 0.40 mm.
3. TOLERANCES WILL BE AS PER BS 1474-1987 UNLESS OTHERWISE SPECIFIED

SCALE	1:1
AREA mm <sup>2</sup>	2920.37
PERIMETER	298.98mm
WEIGHT kg/m	7.885
SECTION No.	27022
DRAWING No.	27022

PARTY'S NAME	TYCO VALVES & CONTROLS
PARTY'S DRAWING No.	AS PER DRAWING(15601-4)
ALLOY & TEMPER	6060 T6 (TO BS 1474)
DESCRIPTION	BODY EXTRUSION TRP-004 ACTUATOR