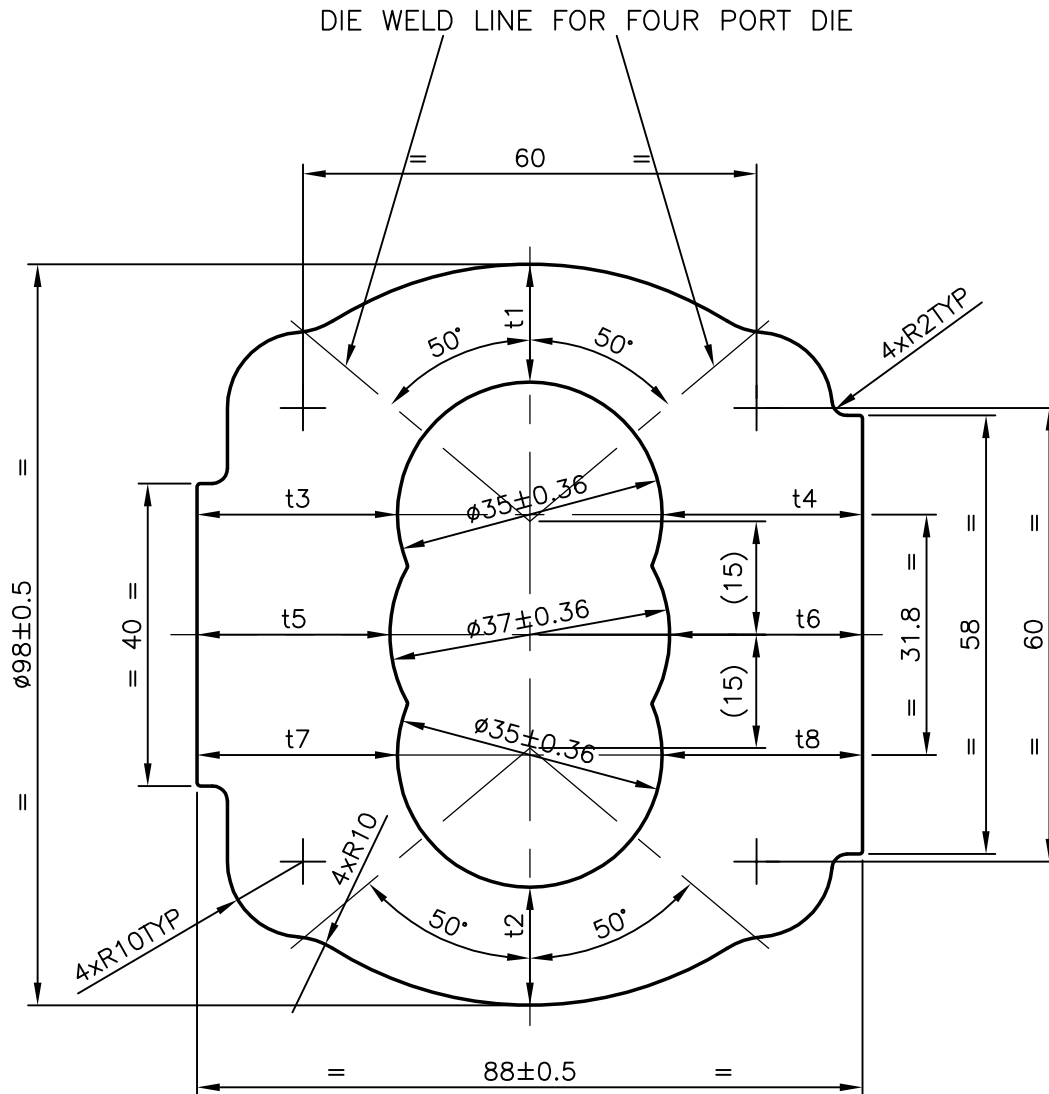

P-6905-2

S1906

27061

**NOTE:-**

1. ECCENTRICITY OF OUTSIDE PROFILE WITH INSIDE HOLLOW PROFILE WILL BE MAXIMUM 1.0mm BETWEEN  $t1-t2$ ,  $t3-t4$ ,  $t5-t6$ , AND  $t7-t8$ . (TOTAL DIFFERENCE IN ALL WALLS WILL BE MAXIMUM 1.00mm).
2. 15mm AND  $50^\circ$  ARE 4 PORT DIE, WELD LINE REFERENCE DIMENSIONS.
3. PLEASE CONFIRM ALL THE DIMENSIONS
4. HARDNESS IS CHANGED FROM 85-90 BHN TO 85 BHN MINIMUM.



SYMBOL OF QUALITY  
AN ISO 9001 COMPANY

**JINDAL ALUMINIUM LTD.**  
**BANGALORE-560073 (INDIA)**

	NAME	DATE
DRAWN	PRASANNA.H.	21-12-2006
CHECKED		
APPROVED		
SCALE		1:1
AREA mm <sup>2</sup>		5333.965
PERIMETER mm.		321.631
WEIGHT kg/m		14.402
DRAWING No.	SECTION No.	
P-6905-2	-	
S1906	S1906	
27061	27061 (ISSUE-2)	

1. ALL DIMENSIONS ARE IN mm.
2. ROUND OFF ALL SHARP CORNERS WITH 0.40 mm.
3. TOLERANCES WILL BE AS PER IS:6477-1983 UNLESS OTHERWISE SPECIFIED

PARTY'S NAME	VICKERS SYSTEMS INTRENATIONAL LTD MUMBAI
PARTY'S DRAWING No.	931135A
ALLOY & TEMPER	64430 WP (AS PER IS 1285)
DESCRIPTION	PUMP BODY