

P-11542-1

S3200

27109

TOLERANCE ADDED ON DIMENSION 49 ± 0.60
AS PER E-MAIL DATED 19/11/2014

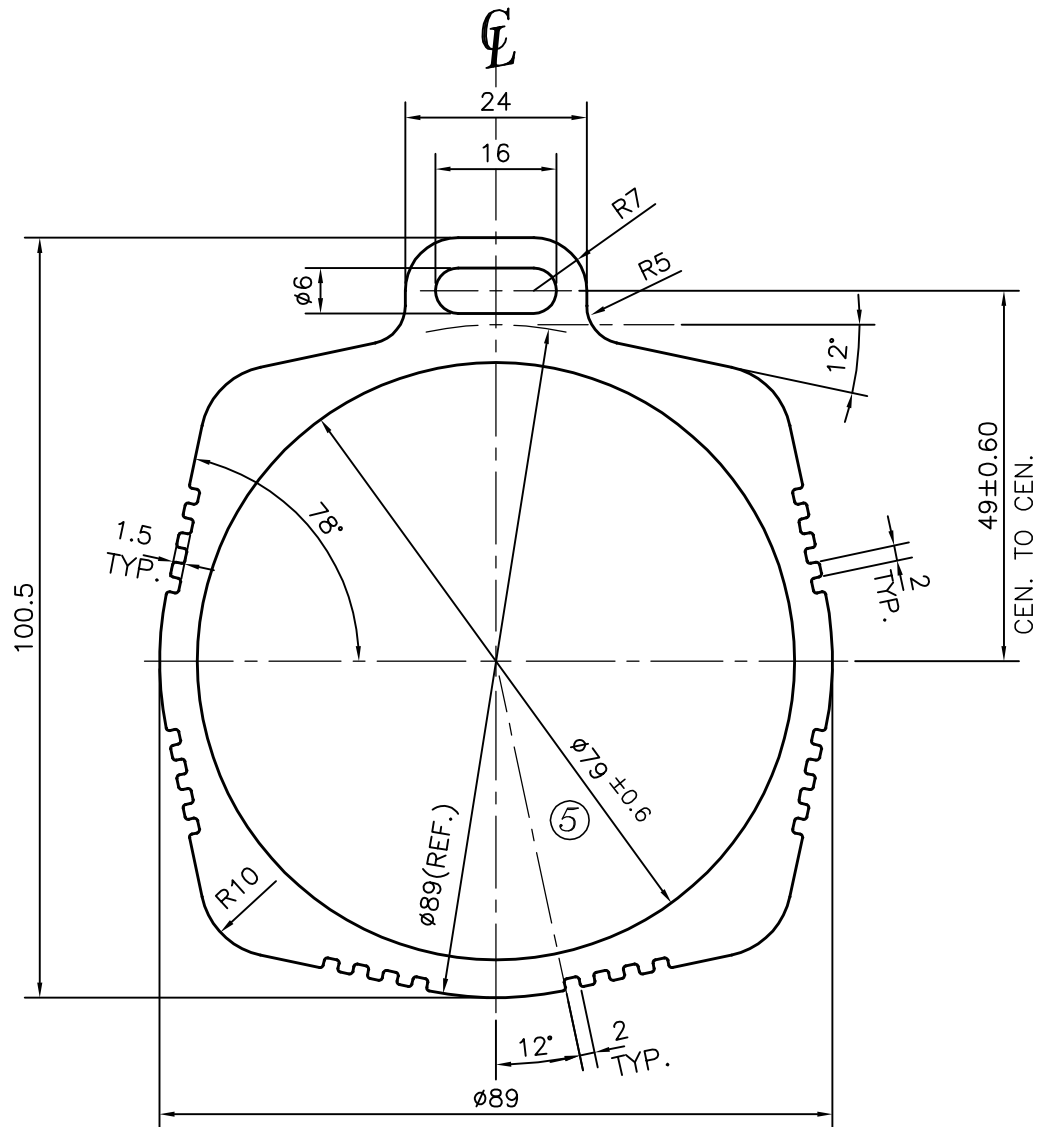

ISSUE (2) :-

- ☞ DIMENSION CHANGED FROM $\phi 80.5$ TO $\phi 79 \pm 1.0$
- ☞ WEIGHT ALSO CHANGED FROM 4.855 TO 5.362 Kg/M.

ISSUE (3) :-

- ☞ ALLOY CHANGED FROM HE9 WP TO 6005 T6

ISSUE (4) :-

- ☞ DIMENSION CHANGED FROM $\phi 79 \pm 1.0$ TO $\phi 79.5 \pm 0.6$
- ☞ HARDNESS :- 70-80 BHN
- ☞ ECCENTRICITY :- ± 0.3
- ☞ WEIGHT ALSO CHANGED FROM 5.362 TO 5.194 Kg/M.

ISSUE (5) :-

- ☞ DIMENSION CHANGED FROM $\phi 79.5 \pm 0.6$ TO $\phi 79.0 \pm 0.6$
- ☞ WEIGHT ALSO CHANGED FROM 5.194 TO 5.362 Kg/M.



SYMBOL OF QUALITY
AN ISO 9001 COMPANY

JINDAL ALUMINIUM LTD.
BANGALORE-560073 (INDIA)

	NAME	DATE
DRAWN	PARVESH	31-05-2014
CHECKED		
APPROVED	S.S.GARG	03-06-2014
SCALE		1:1
AREA mm ²		1985.946
PERIMETER mm.		372.645
WEIGHT kg/m		5.362
DRAWING No.	SECTION No.	
P-11542-1		
S3200	S3200 (ISSUE-5)	
27109	27109	

1. ALL DIMENSIONS ARE IN mm.
2. ROUND OFF ALL SHARP CORNERS WITH 0.40 mm.
3. TOLERANCES WILL BE AS PER IS:6477-1983, UNLESS OTHERWISE SPECIFIED

PARTY'S NAME PRAGATI AUTOMATION PVT. LTD., BANGALORE

PARTY'S DRAWING No. CV080302 (DATED-14-02-2014)

ALLOY & TEMPER 6005 T6

DESCRIPTION MOTOR HOUSING SECTION