

P-12648

27266

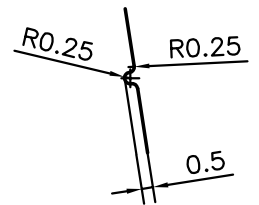

DETAILS OF "A"
SCALE 3:1

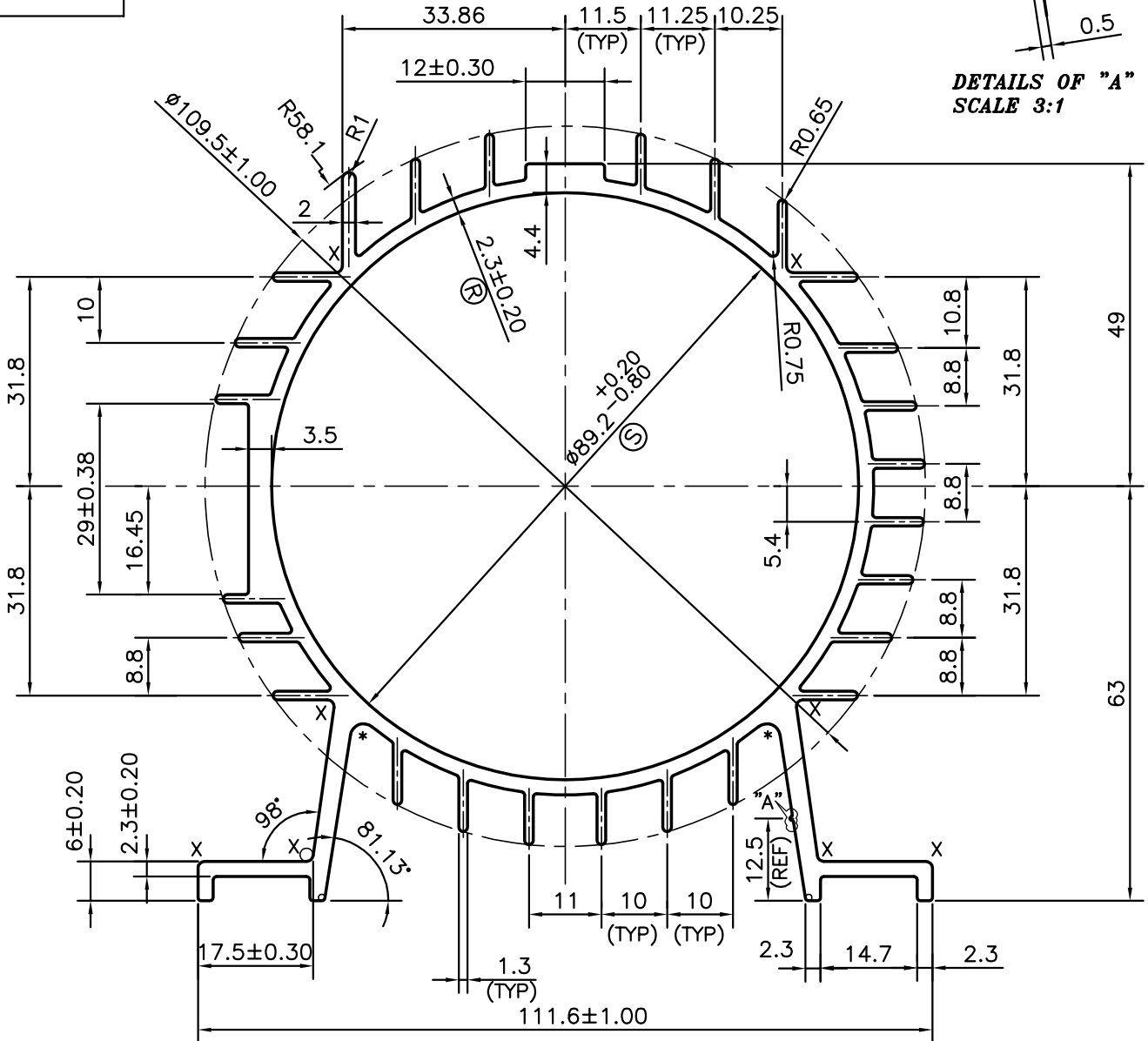

Ⓡ & Ⓢ - CRITICAL DIMENSIONS

X = 1 mm RADIUS (8 PLACES)

* = 2 mm RADIUS (2 PLACES)

TOLERANCES ON OVERALL WIDTHS & WIDTHS ACROSS FLATS OF BARS, & REGULAR SECTIONS

UPTO 6.40mm - ±0.20	UPTO 32.0mm - ±0.38	UPTO 120.0mm - ±0.85	UPTO 320.00mm - ±1.70
UPTO 10.0mm - ±0.23	UPTO 50.0mm - ±0.46	UPTO 160.0mm - ±1.02	
UPTO 12.0mm - ±0.25	UPTO 60.0mm - ±0.53	UPTO 200.0mm - ±1.14	
UPTO 16.0mm - ±0.28	UPTO 80.0mm - ±0.69	UPTO 250.0mm - ±1.40	
UPTO 25.0mm - ±0.30	UPTO 100.0mm - ±0.75	UPTO 300.0mm - ±1.65	



SYMBOL OF QUALITY
AN ISO 9001 COMPANY

JINDAL ALUMINIUM LTD.
BANGALORE-560073 (INDIA)

	NAME	DATE
DRAWN	SRIVATHSA	06-04-2013
CHECKED		
APPROVED	S.S.GARG	17-04-2013

- ALL DIMENSIONS ARE IN mm.
- ROUND OFF ALL SHARP CORNERS WITH 0.50 mm.
- TOLERANCES WILL BE AS PER IS:6477-1983 ,UNLESS OTHERWISE SPECIFIED

SCALE	1:1
AREA mm ²	1333.183
PERIMETER mm.	905.300
WEIGHT kg/m	3.600

PARTY'S NAME	GENERAL CATEGORY, COIMBATORE MARKET
PARTY'S DRAWING No.	LIGHTER OF 27230 & AS PER REQUIREMENT
ALLOY & TEMPER	HE9 WP
DESCRIPTION	MOTOR BODY

DRAWING No.	SECTION No.
P-12648	-
27266	27266