

P-4793-1

7155

27385

MOMENT OF INERTIA:- X - 40.394cm<sup>4</sup>  
Y - 579.207cm<sup>4</sup>

RADII OF GYRATION:- X - 1.5663cm  
Y - 5.931cm

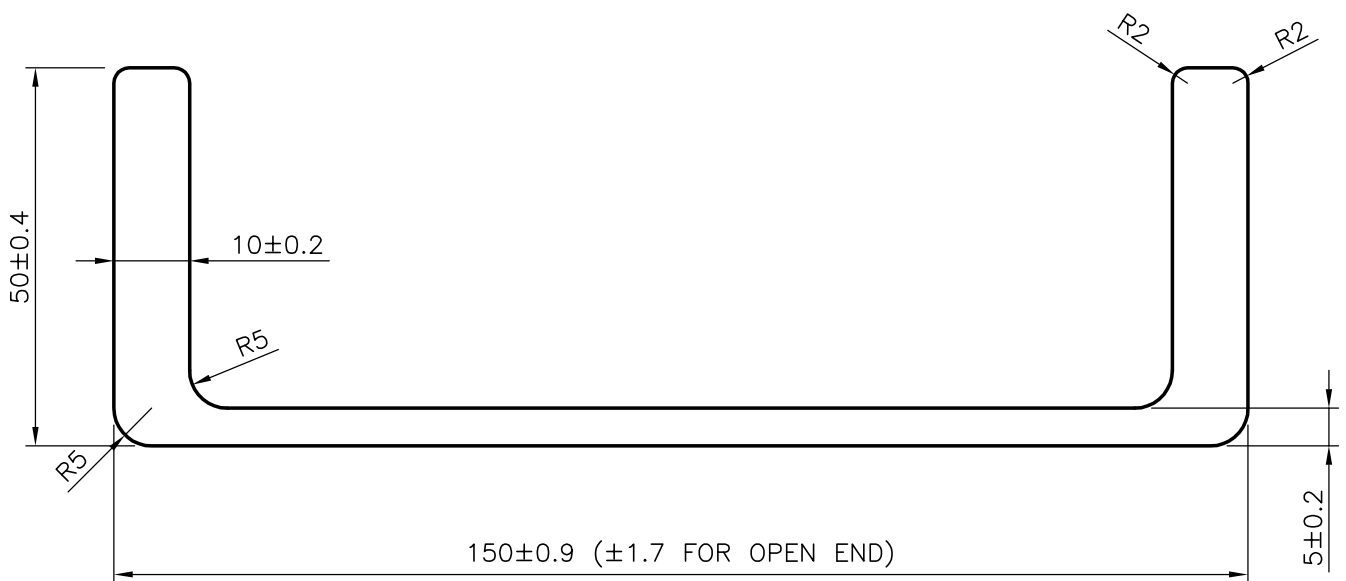

ALL OUTER SURFACE EXPOSED SURFACE  
FLATNESS =  $\pm 0.6$ mm (FOR 150mm WIDTH)  
TWIST = IN ANY 300mm LENGTH  $0.25^\circ$  & IN TOTAL LENGTH OF L METRES  $0.8L$  ( $3^\circ$  MAX)  
STRAIGHTNESS = IN ANY LENGTH  $\leq 300$ mm  $\pm 0.6$ mm & IN TOTAL LENGTH OF L METRES  $2L$



SYMBOL OF QUALITY  
AN ISO 9002 COMPANY

**JINDAL ALUMINIUM LTD.**  
BANGALORE-560073 (INDIA)

	NAME	DATE
DRAWN	RAGHAVENDRA	18-03-2004
CHECKED		
APPROVED		
SCALE		1:1
AREA mm <sup>2</sup>		1646.566
PERIMETER mm.		477.982
WEIGHT kg/m		4.446
DRAWING No.		SECTION No.
P-4793-1		-
7155		7155
27385		27385

1. ALL DIMENSIONS ARE IN mm.
2. ROUND OFF ALL SHARP CORNERS WITH 0.40 mm.
3. TOLERANCES WILL BE AS PER AS/NZS:1866-1997 UNLESS OTHERWISE SPECIFIED

PARTY'S NAME MAYFAIR IMPORTS, AUSTRALIA

PARTY'S DRAWING No. AS PER SPECIFICATION

ALLOY & TEMPER 6082 T6

DESCRIPTION MISC. CHANNEL