

P-4297

S1007

27590

1. STRAIGHTNESS: ± 1.70 mm./M
2. FLATNESS: $- 1.0$ mm/M
3. TWIST: $- 1.70$ mm./M

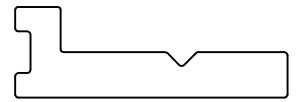

1:1

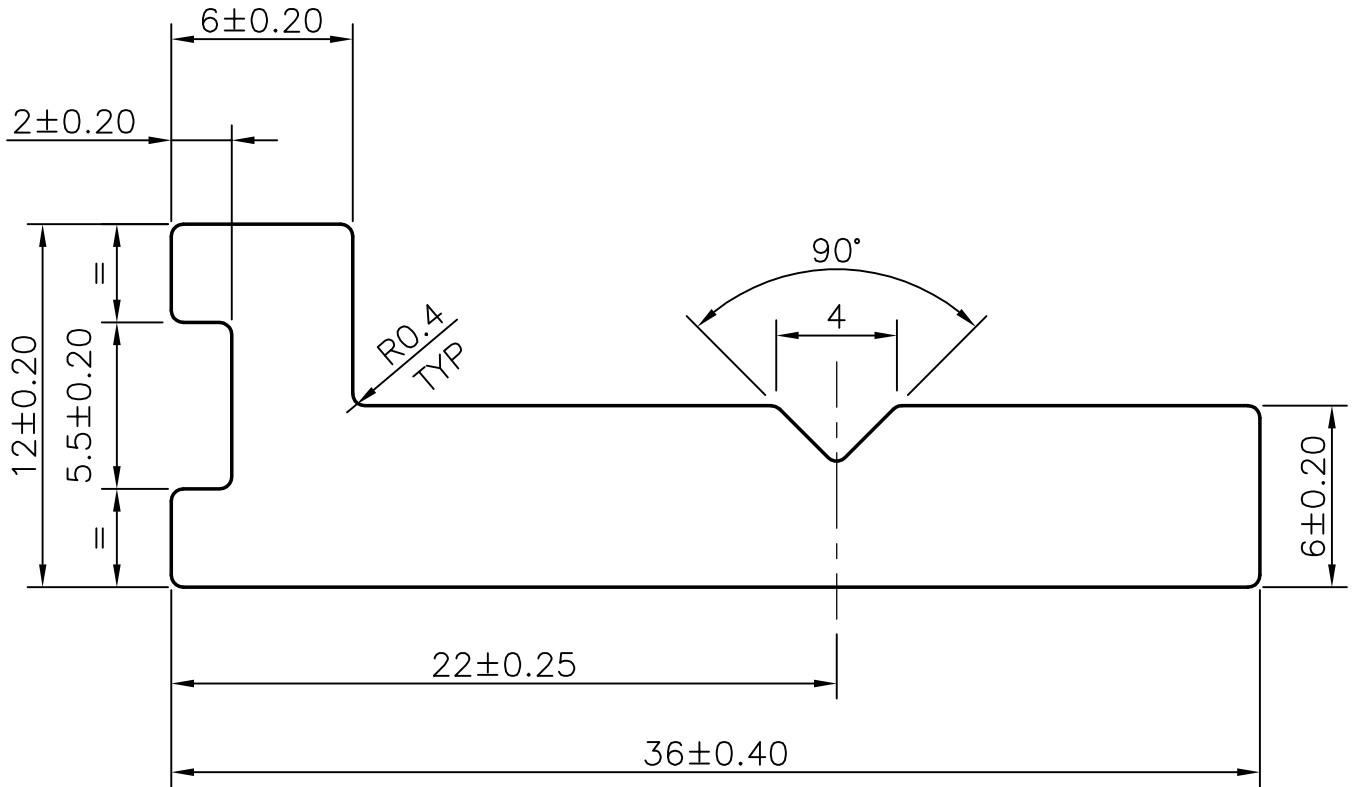

SYMBOL OF QUALITY
AN ISO 9002 COMPANY

JINDAL ALUMINIUM LTD.
BANGALORE-560073 (INDIA)

	NAME	DATE
DRAWN	R.D.Sharma	25-06-2003
CHECKED		
APPROVED		

1. ALL DIMENSIONS ARE IN mm.
2. ROUND OFF ALL SHARP CORNERS WITH 0.40 mm.
3. TOLERANCES WILL BE AS PER IS: 3965-1981 UNLESS OTHERWISE SPECIFIED

SCALE	4:1
AREA mm ²	236.9
PERIMETER mm.	99.7
WEIGHT kg/m	0.640

PARTY'S NAME	N.K. JAIN INSTRUMENTS PVT. LTD., AMBALA
PARTY'S DRAWING No.	NM-002-SEC (REV.-B)
ALLOY & TEMPER	6063 T6
DESCRIPTION	MOVING BALL SLIDE (TOP & BOTTOM)

DRAWING No.	SECTION No.
P-4297	-
S1007	S1007
27590	27590