

P-8878-1

27825

SCALE 1:1

VISIBLE SURFACE

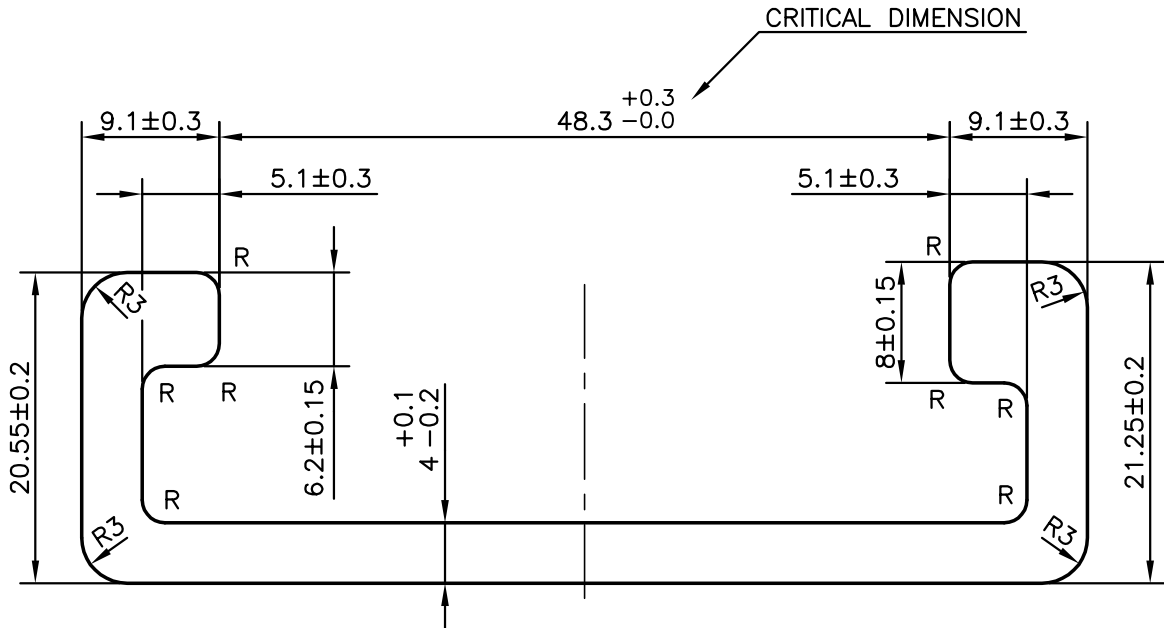

NOTE: -

TOLERANCE CHANGED ON $48.3^{+0.3}$ TO $48.3^{-0.0}$
 AS PER CUSTOMER APPROVED DRAWING.
 OPEN END 100 % TO BE CORRECTED MANUALLY.
 AS DISCUSSED IN "DO IT RIGHT MEETING"
 ON DATED 16/05/2013.

TWIST = 1.70 mm/MTR.
 STRAIGHTNESS = 1.70 mm/MTR.
 R = R1.50 mm (8 PLACES)



SYMBOL OF QUALITY
 AN ISO 9001 COMPANY

JINDAL ALUMINIUM LTD.
 BANGALORE-560073 (INDIA)

	NAME	DATE
DRAWN	PRASANNA.H	09-12-2008
CHECKED		
APPROVED		

1. ALL DIMENSIONS ARE IN mm.
2. ROUND OFF ALL SHARP CORNERS WITH 0.40 mm.
3. TOLERANCES WILL BE AS PER IS:3965-1981 UNLESS OTHERWISE SPECIFIED

SCALE	2:1
AREA mm ²	465.894
PERIMETER mm.	218.699
WEIGHT kg/m	1.258

PARTY'S NAME	OTIS ELEVATOR COMPANY (I) LTD., BANGALORE
PARTY'S DRAWING No.	FAA483T
ALLOY & TEMPER	6060 T6
DESCRIPTION	ELEVATOR SECTION

DRAWING No.	SECTION No.
P-8878-1	-
27825	27825