

P-8569-1

X1059

27873

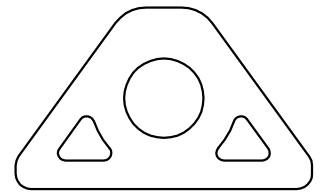

SCALE 1:1

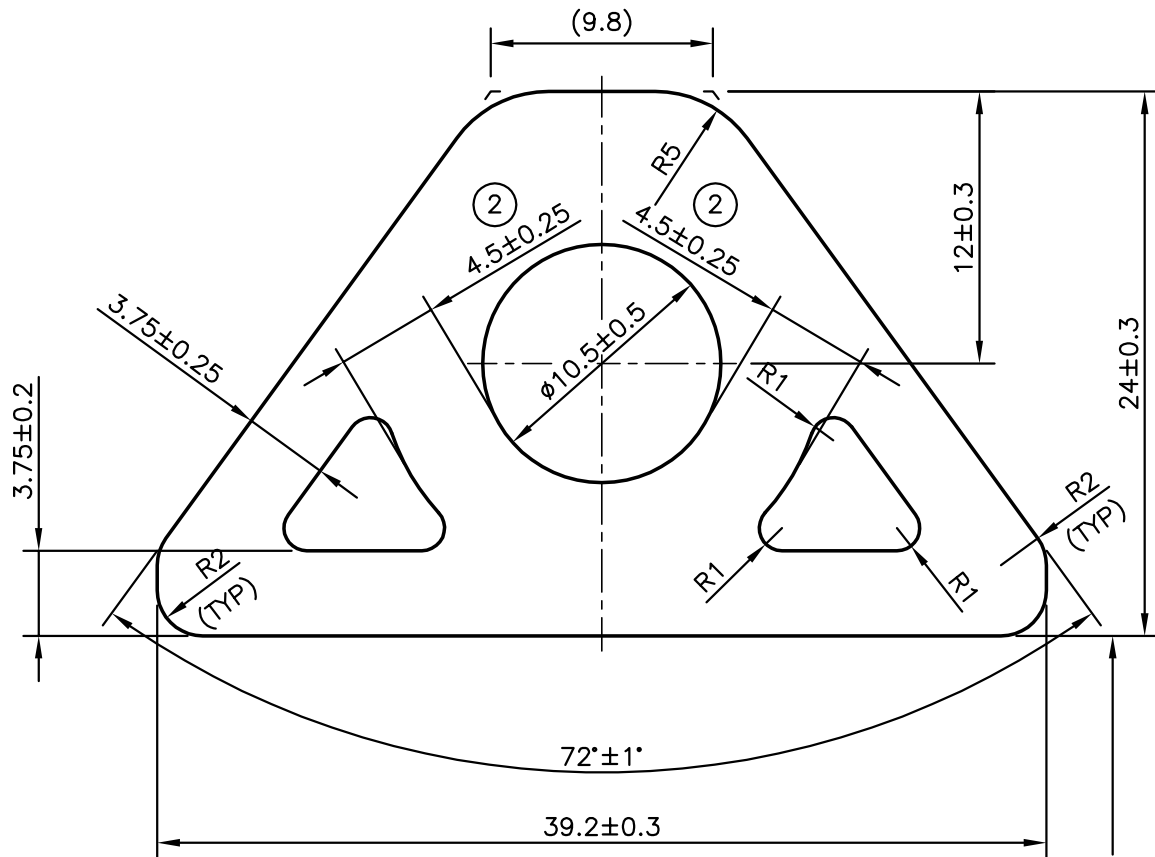

② ISSUE-2

THICKNESS INCREASED FROM 3.75 mm.±0.25 TO 4.5 mm.±0.25  
AS PER CUSTOMER REQUIREMENT.

WEIGHT ALSO CHANGED FROM 1.313 kg/m TO 1.349 kg/m ACCORDINGLY

FLATNESS:- ±0.30



SYMBOL OF QUALITY  
AN ISO 9001 COMPANY

**JINDAL ALUMINIUM LTD.**  
BANGALORE-560073 (INDIA)

	NAME	DATE
DRAWN	RAGHAVENDRA	14-02-2009
CHECKED		
APPROVED		

- ALL DIMENSIONS ARE IN mm.
- ROUND OFF ALL SHARP CORNERS WITH 0.40 mm.
- TOLERANCES WILL BE AS PER IS:6477-1983 UNLESS OTHERWISE SPECIFIED

SCALE	3:1
AREA mm <sup>2</sup>	499.812
PERIMETER mm.	103.984
WEIGHT kg/m	1.349 ②

PARTY'S NAME THI SUMMIT NEEL AUTO PVT. LTD., HOSUR

DRAWING No. SECTION No.

PARTY'S DRAWING No. SI/RF/MECH:4640/2

P-8569-1 -

ALLOY &amp; TEMPER 6061 T6

X1059 X1059 ISSUE-2

27873 27873

DESCRIPTION MISC. INNER TUBE