

P-9626

S2378

27932

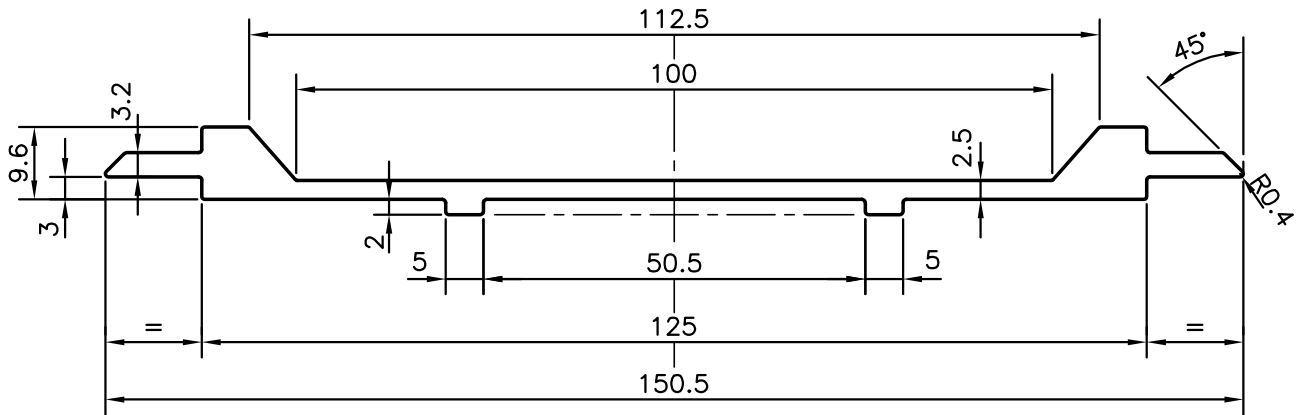
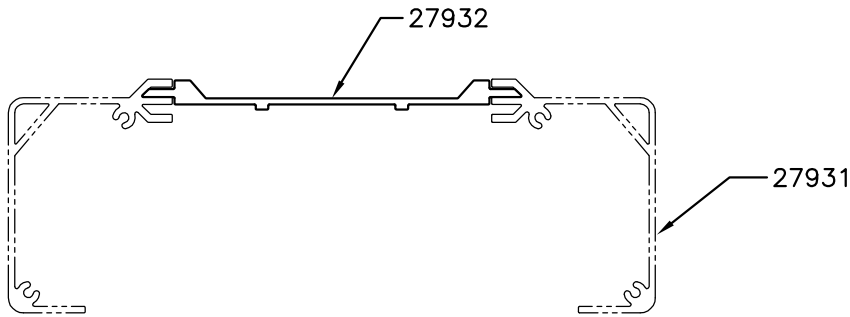
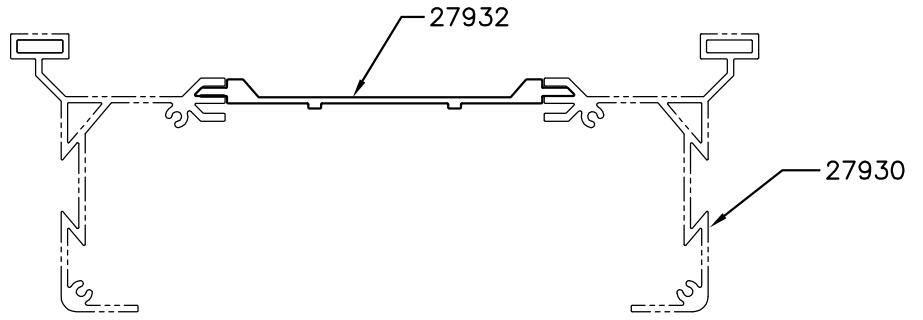

SYMBOL OF QUALITY
AN ISO 9001 COMPANY

JINDAL ALUMINIUM LTD.
BANGALORE-560073 (INDIA)

| | NAME | DATE |
|----------|-------------|------------|
| DRAWN | J.P.KAUSHIK | 11-11-2009 |
| CHECKED | | |
| APPROVED | | |

1. ALL DIMENSIONS ARE IN mm.
2. ROUND OFF ALL SHARP CORNERS WITH 0.40 mm.
3. TOLERANCES WILL BE AS PER IS:3965-1981 UNLESS OTHERWISE SPECIFIED

| | |
|----------------------|---------|
| SCALE | 1:1 |
| AREA mm ² | 540.203 |
| PERIMETER mm. | 328.285 |
| WEIGHT kg/m | 1.459 |

PARTY'S NAME: KARNATAKA INDUSTRIES, BANGALORE

PARTY'S DRAWING No.: AS PER SAMPLE

ALLOY & TEMPER: 6063 T6

DESCRIPTION: MISC. SECTION

| DRAWING No. | SECTION No. |
|-------------|-------------|
| P-9626 | - |
| S2378 | S2378 |
| 27932 | 27932 |