

P-9758-1

S2445

27936

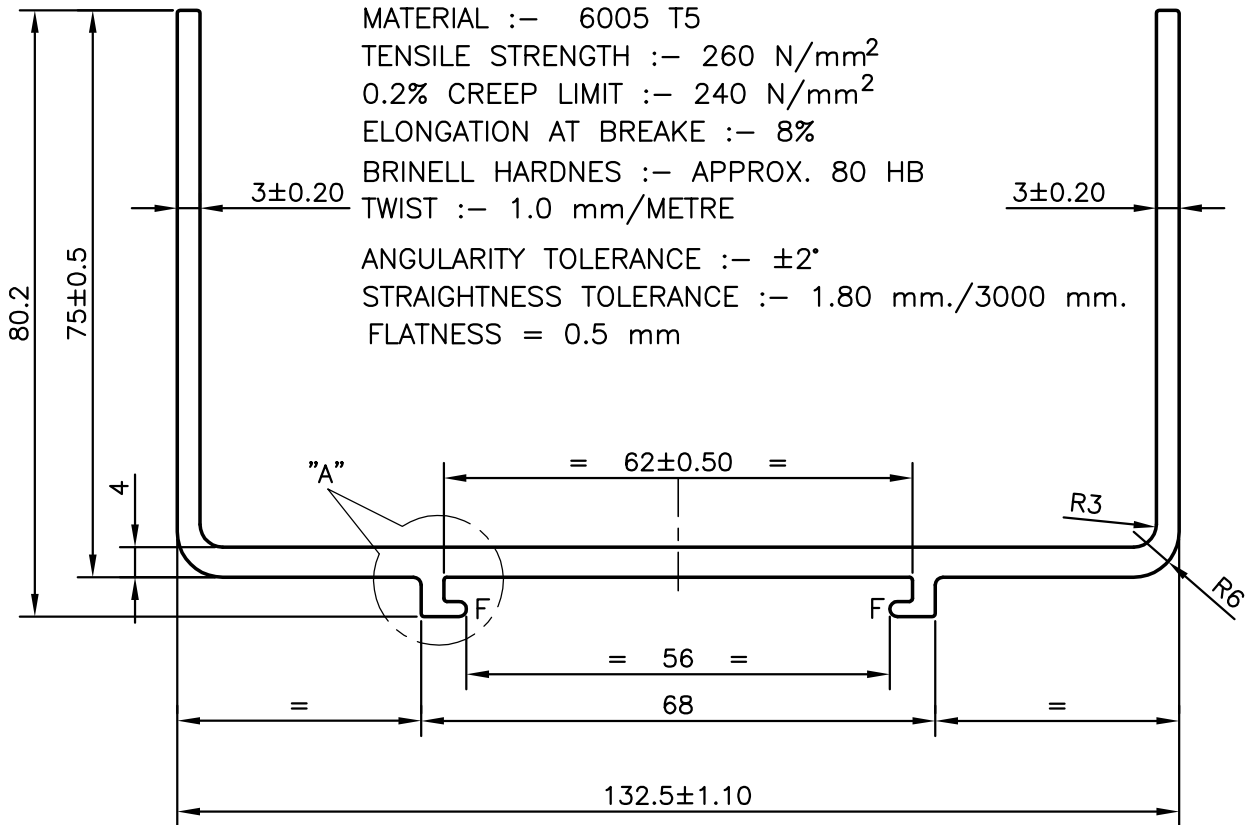
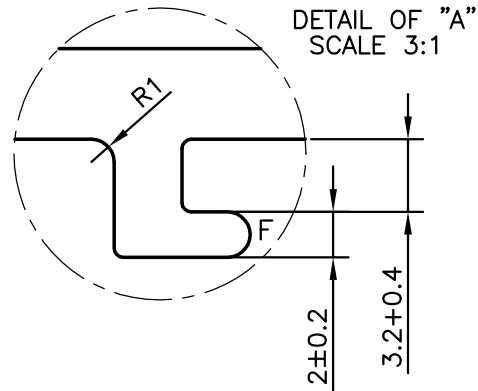

MATERIAL :- 6005 T5

TENSILE STRENGTH :- 260 N/mm²0.2% CREEP LIMIT :- 240 N/mm²

ELONGATION AT BREAK :- 8%

BRINELL HARDNESS :- APPROX. 80 HB

TWIST :- 1.0 mm/METRE

ANGULARITY TOLERANCE :- ±2°

STRAIGHTNESS TOLERANCE :- 1.80 mm./3000 mm.

FLATNESS = 0.5 mm

F = FULL RADIUS (2 PLACES)



SYMBOL OF QUALITY
AN ISO 9001 COMPANY

JINDAL ALUMINIUM LTD.
BANGALORE-560073 (INDIA)

	NAME	DATE
DRAWN	J.P.KAUSHIK	01-02-2010
CHECKED		
APPROVED	S.S.GARG	10-02-2010
SCALE		1:1
AREA mm ²		987.114
PERIMETER mm.		577.782
WEIGHT kg/m		2.665
DRAWING No.	SECTION No.	
P-9758-1	-	
S2445	S2445	
27936	27936	

1. ALL DIMENSIONS ARE IN mm.
2. ROUND OFF ALL SHARP CORNERS WITH 0.40 mm.
3. TOLERANCES WILL BE AS PER DIN-EN12020, UNLESS OTHERWISE SPECIFIED

PARTY'S NAME	PRECISION AUTOMATION & ROBOTICS INDIA LTD., PUNE
PARTY'S DRAWING No.	UE006000097
ALLOY & TEMPER	6005 T5
DESCRIPTION	C SHAPED COVER SECTION