

P-11576-1

S3231

27987

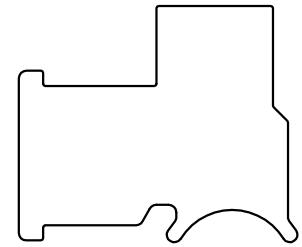

SCALE :- 1:1

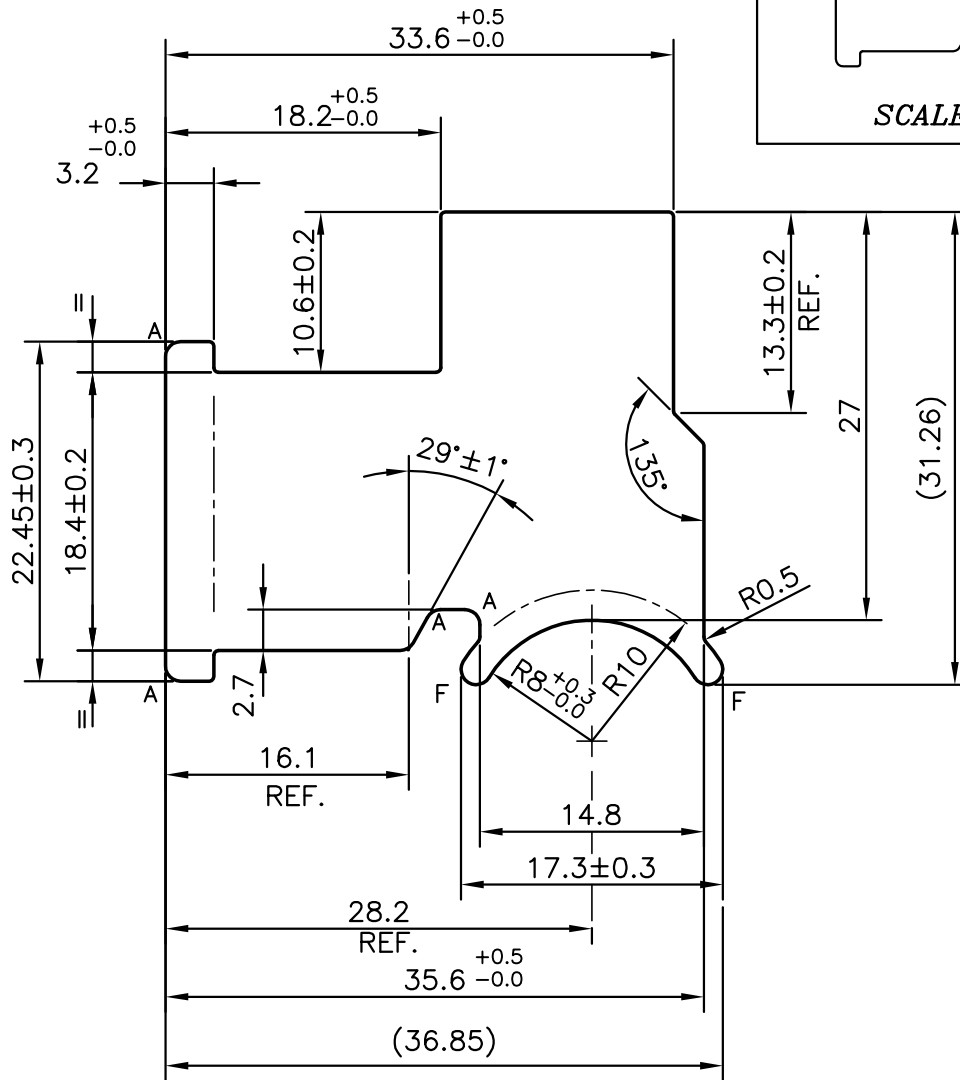

**ISSUE-2 :-**

DIMENSIONS ARE CHANGED FROM :-

- 33.4 TO 33.6
- 18.0 TO 18.2
- 3.0 TO 3.20
- 15.9 TO 16.1
- 28.0 TO 28.2
- 35.4 TO 35.6
- 36.65 TO 36.85

A = RADIUS 1 mm. (4 PLACES)

F = FULL RADIUS ( 2 PLACES)

ROUND OFF ALL SHARP CORNERS WITH 0.30 mm.

WEIGHT ALSO CHANGED FROM 2.171 Kg/m TO 2.183 Kg/m



SYMBOL OF QUALITY  
AN ISO 9001 COMPANY

**JINDAL ALUMINIUM LTD.**  
BANGALORE-560073 (INDIA)

	NAME	DATE
DRAWN	PARVESH	22-11-2012
CHECKED		
APPROVED	S.S.GARG	23-11-2012
SCALE		2:1
AREA mm <sup>2</sup>		808.382
PERIMETER mm.		147.888
WEIGHT kg/m		2.183
DRAWING No.	SECTION No.	
P-11576-1	-	
S3231	S3231 (ISSUE-2)	
27987	27987	

1. ALL DIMENSIONS ARE IN mm.
2. ROUND OFF ALL SHARP CORNERS WITH 0.30 mm.
3. TOLERANCES WILL BE AS PER BS:EN-755-9, UNLESS OTHERWISE SPECIFIED

PARTY'S NAME	PRECISION COMPONENTS INDIA, MOHALI
PARTY'S DRAWING No.	PCI-690
ALLOY & TEMPER	6063 T6
DESCRIPTION	CONNECTOR O RING INLET