

P-11824-2

S3356

28051

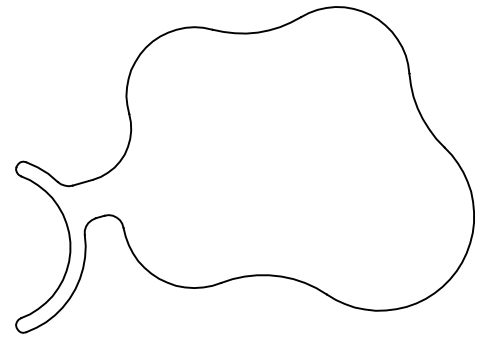

SCALE :- 1:1

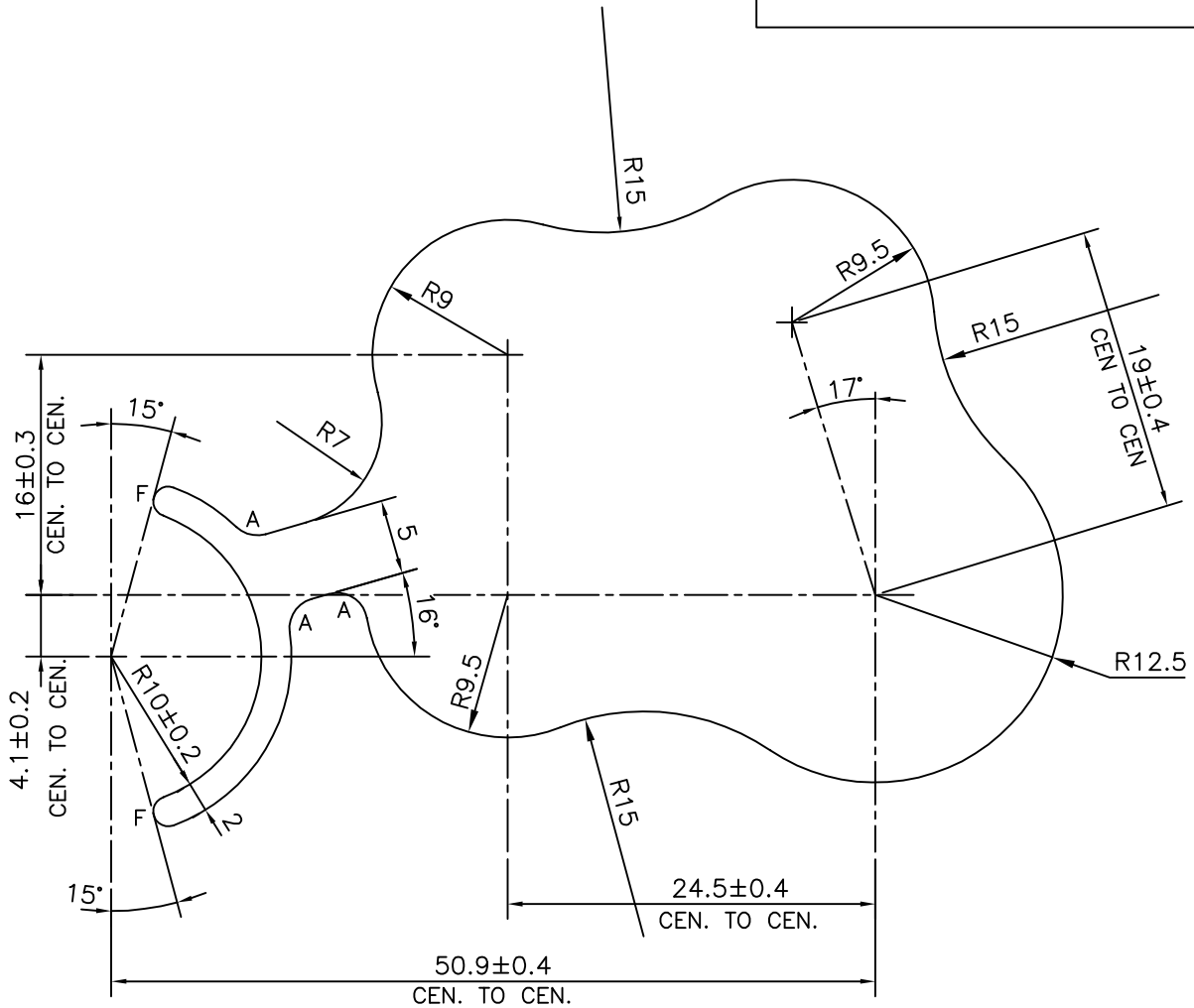

**ISSUE-2**

FOUR HOLES REMOVED AS PER CUSTOMER REQUIREMENT  
& WEIGHT ALSO CHANGED FROM 3.700 Kg/m TO 4.147 Kg/M.

F = FULL RADIUS (2 PLACES)  
A = RADIUS 2 mm. (3 PLACES)



SYMBOL OF QUALITY  
AN ISO 9001 COMPANY

**JINDAL ALUMINIUM LTD.**  
BANGALORE-560073 (INDIA)

	NAME	DATE
DRAWN	PARVESH	26-10-2012
CHECKED		
APPROVED	S.S.GARG	31-10-2012
SCALE		2:1
AREA mm <sup>2</sup>		1535.762
PERIMETER mm.		205.735
WEIGHT kg/m		4.147
DRAWING No.	SECTION No.	
P-11824-2	-	
S3356	S3356-ISSUE-2	
28051	28051	

1. ALL DIMENSIONS ARE IN mm.
2. ROUND OFF ALL SHARP CORNERS WITH 0.40 mm.
3. TOLERANCES WILL BE AS PER IS:3965-1981, UNLESS OTHERWISE SPECIFIED

PARTY'S NAME	WONJIN AUTOPARTS INDIA PVT. LTD., MARAMALAI NAGAR
PARTY'S DRAWING No.	F742007CA01-3
ALLOY & TEMPER	6005 T5
DESCRIPTION	AUTOMOBILE SECTION