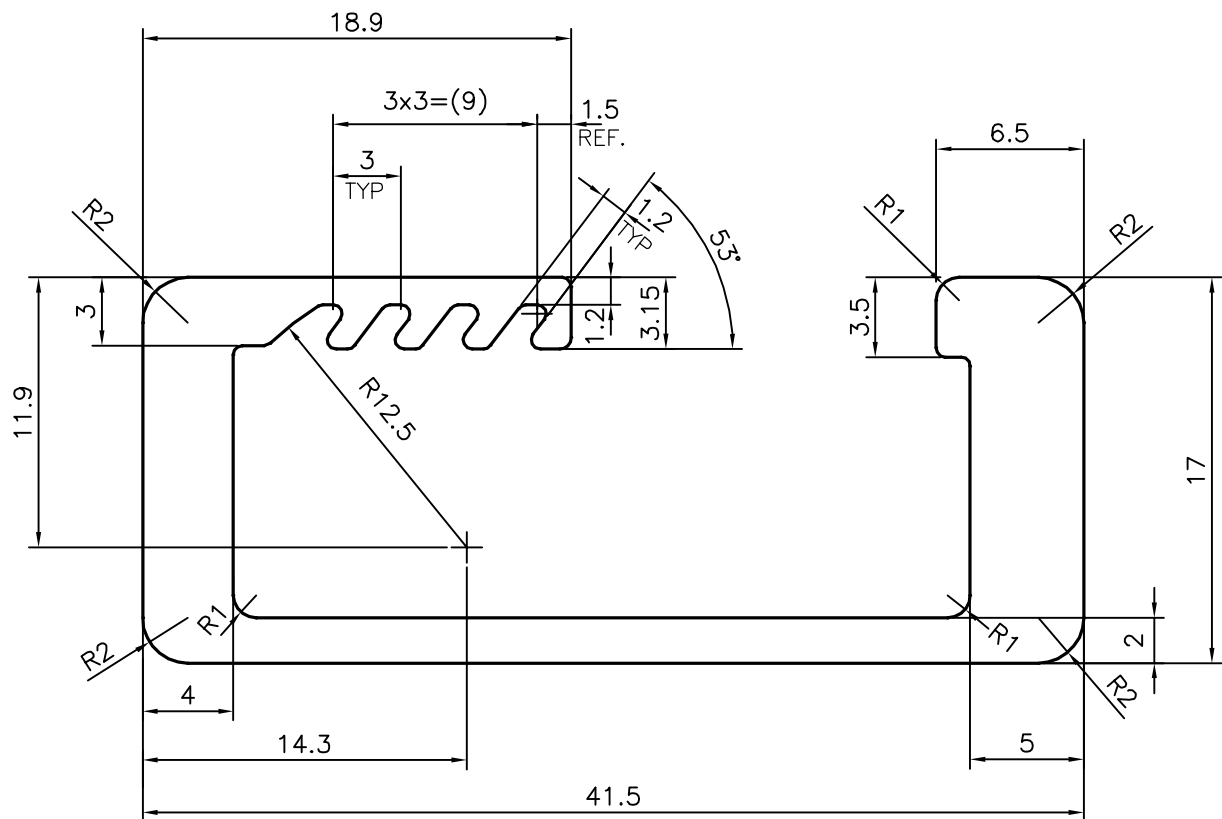
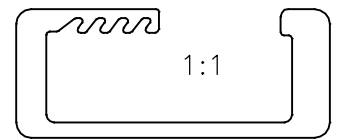

P-13685-1

S4162

28267

**ISSUE-2**

OUTER RADIUS CHANGED FROM 0.40 mm TO 2.0 mm & 0.40 TO 1.0 mm

WEIGHT ALSO CHANGED FROM 0.695 Kg/M TO 0.686 Kg/M

## TOLERANCES ON OVERALL WIDTHS &amp; WIDTHS ACROSS FLATS OF BARS, &amp; REGULAR SECTIONS

UPTO 6.40mm - ±0.20	UPTO 32.0mm - ±0.38	UPTO 120.0mm - ±0.85	UPTO 320.00mm - ±1.70
UPTO 10.0mm - ±0.23	UPTO 50.0mm - ±0.46	UPTO 160.0mm - ±1.02	
UPTO 12.0mm - ±0.25	UPTO 60.0mm - ±0.53	UPTO 200.0mm - ±1.14	
UPTO 16.0mm - ±0.28	UPTO 80.0mm - ±0.69	UPTO 250.0mm - ±1.40	
UPTO 25.0mm - ±0.30	UPTO 100.0mm - ±0.75	UPTO 300.0mm - ±1.65	



SYMBOL OF QUALITY  
AN ISO 9001 COMPANY

**JINDAL ALUMINIUM LTD.**  
BANGALORE-560073 (INDIA)

	NAME	DATE
DRAWN	J.P.KAUSHIK	12-08-2014
CHECKED		
APPROVED	S.S.GARG	01-09-2014

- ALL DIMENSIONS ARE IN mm.
- ROUND OFF ALL SHARP CORNERS WITH 0.40 mm.
- TOLERANCES WILL BE AS PER IS:3965-1981, UNLESS OTHERWISE SPECIFIED

SCALE	3:1
AREA mm <sup>2</sup>	254.064
PERIMETER mm.	187.574
WEIGHT kg/m	0.686

PARTY'S NAME	UDAWAT ENGINEERING WORKS, BANGALORE
PARTY'S DRAWING No.	AS PER SAMPLE & DRAWING
ALLOY & TEMPER	6060 T6
DESCRIPTION	MISC. SECTION

DRAWING No.	SECTION No.
P-13685-1	-
S4162	S4162(ISSUE-2)
28267	28267