

P-14515-1

S4426

28316

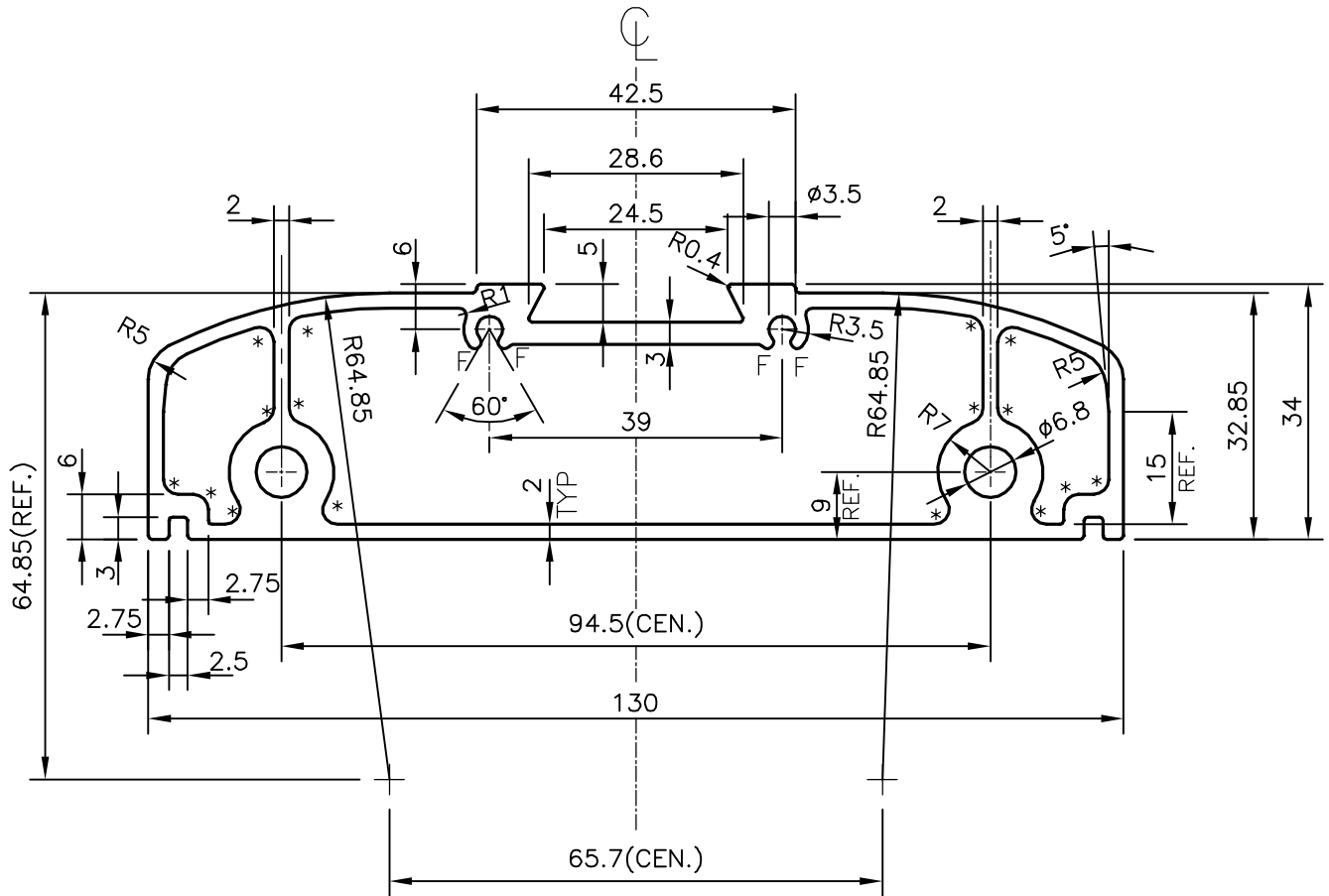

F = FULL RADIUS ( 4 PLACES)

\* = 2.0 RADIUS (16 PLACES)



SYMBOL OF QUALITY  
AN ISO 9001 COMPANY

**JINDAL ALUMINIUM LTD.**  
BANGALORE-560073 (INDIA)

	NAME	DATE
DRAWN	J.P.KAUSHIK	31-03-2015
CHECKED		
APPROVED	S.S.GARG	08-04-2015

1. ALL DIMENSIONS ARE IN mm.
2. ROUND OFF ALL SHARP CORNERS WITH 0.40 mm.
3. TOLERANCES WILL BE AS PER IS:6477-1983 UNLESS OTHERWISE SPECIFIED

SCALE	1:1
AREA mm <sup>2</sup>	1078.96
PERIMETER mm.	336.125
WEIGHT kg/m	2.913

PARTY'S NAME	STAAN BIO-MED ENGINEERING PVT. LTD., COIMBATORE
PARTY'S DRAWING No.	AS PER AutoCAD DRAWING STP-P-B-143
ALLOY & TEMPER	HE9 WP
DESCRIPTION	MISC. SECTION

DRAWING No.	SECTION No.
P-14515-1	-
S4426	S4426
28316	28316