

P-17040-1

S5398

28461

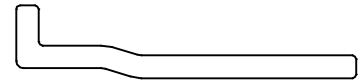

SCALE: - 1:1

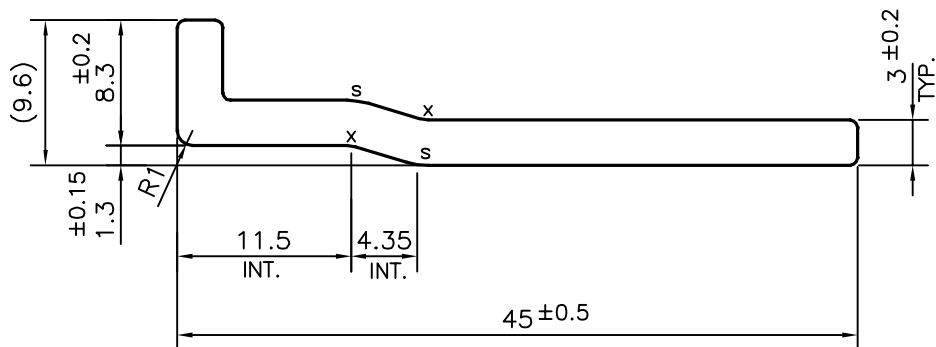

X = RADIUS 2 mm. (2 PLACES)  
Z = RADIUS 5 mm. (2 PLACES)

## TOLERANCES ON OVERALL WIDTHS &amp; WIDTHS ACROSS FLATS OF BARS, &amp; REGULAR SECTIONS

UPTO 6.40mm - ±0.20	UPTO 32.0mm - ±0.38	UPTO 120.0mm - ±0.85	1. STRAIGHTNESS=1.7mm/M 2. TWIST=1.7mm/M 3. ANGULARITY= ±2° 4. FLATNESS =0.007xWIDTH
UPTO 10.0mm - ±0.23	UPTO 50.0mm - ±0.46	UPTO 160.0mm - ±1.02	
UPTO 12.0mm - ±0.25	UPTO 60.0mm - ±0.53	UPTO 200.0mm - ±1.14	
UPTO 16.0mm - ±0.28	UPTO 80.0mm - ±0.69	UPTO 250.0mm - ±1.40	
UPTO 25.0mm - ±0.30	UPTO 100.0mm - ±0.75	UPTO 300.0mm - ±1.65	



SYMBOL OF QUALITY  
AN ISO 9001 COMPANY

**JINDAL ALUMINIUM LTD.**  
BANGALORE-560073 (INDIA)

	NAME	DATE
DRAWN	PARVESH	04-05-2017
CHECKED		
APPROVED	B.NATARAJA	11-05-2017

1. ALL DIMENSIONS ARE IN mm.
2. ROUND OFF ALL SHARP CORNERS WITH 0.50 mm.
3. TOLERANCES WILL BE AS PER IS:3965-1981 , UNLESS OTHERWISE SPECIFIED

SCALE	2:1
AREA mm <sup>2</sup>	151.052
PERIMETER mm.	105.449
WEIGHT kg/m	0.408

PARTY'S NAME	MACRO AUTOTECH, FARIDABAD	DRAWING No.	P-17040-1	SECTION No.	-
PARTY'S DRAWING No.	AS PER DRAWING-PROFILE-2		S5398		S5398
ALLOY & TEMPER	6005 T5		28461		28461
DESCRIPTION	AUTOMOBILE SECTION				