

P-21200

28509

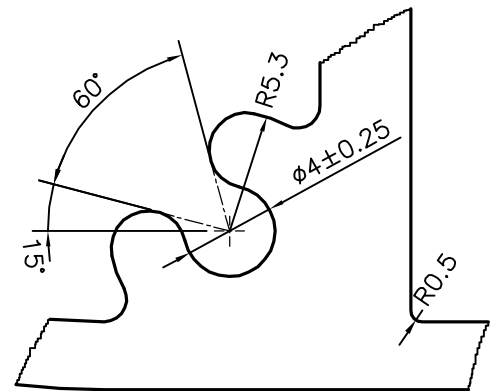
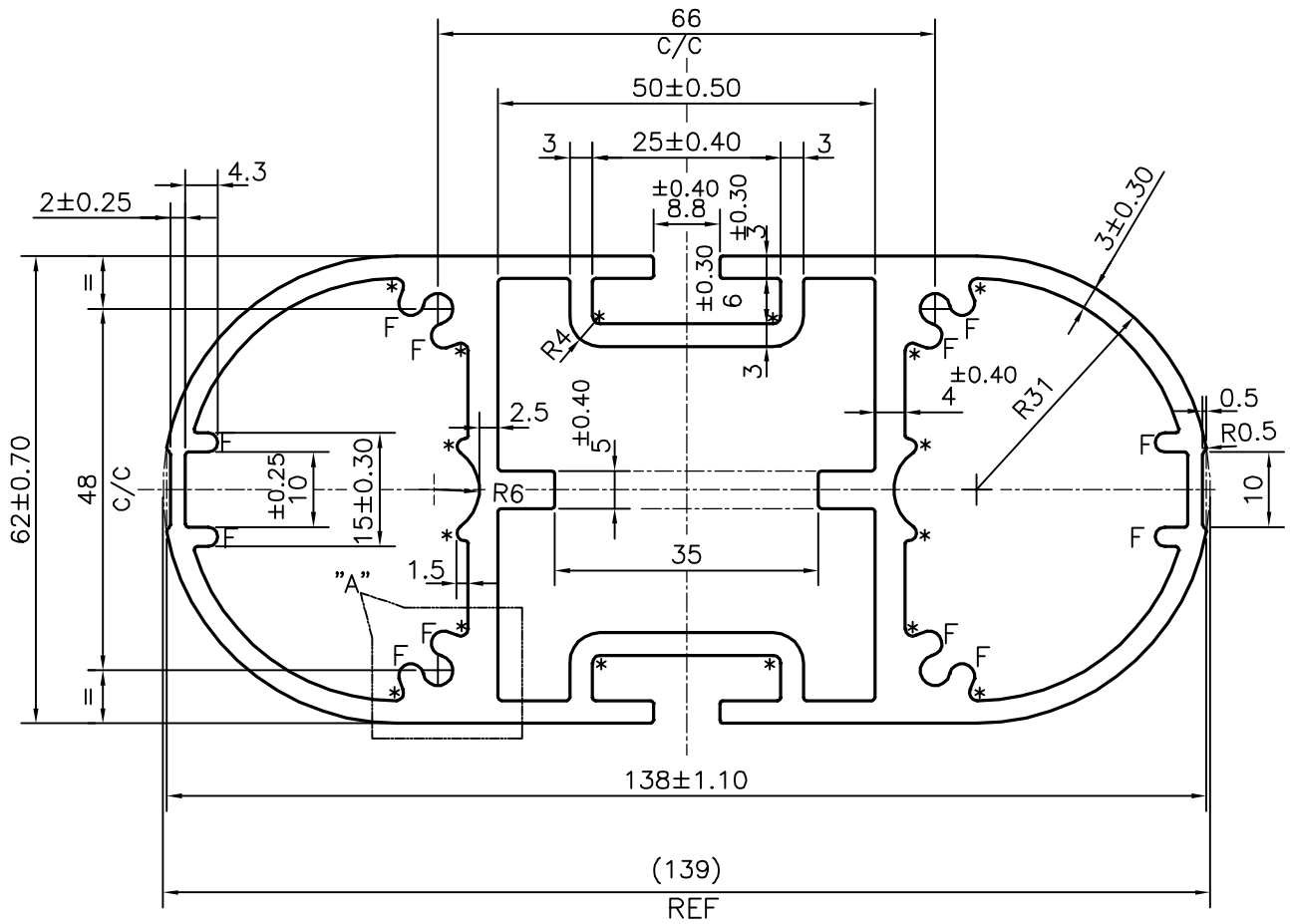

1. STRAIGHTNESS=1.7mm/M
2. TWIST=1.7mm/M
3. ANGULARITY=  $\pm 2^\circ$
4. FLATNESS =0.006xWIDTH

DETAIL "A"  
SCALE 3:1

F = FULL RADIUS (12 PLACES)  
\* = 1.0 RADIUS (16 PLACES)



SYMBOL OF QUALITY  
AN ISO 9001 COMPANY

**JINDAL ALUMINIUM LTD.**  
BANGALORE-560073 (INDIA)

	NAME	DATE
DRAWN	J.P.KAUSHIK	20-07-2020
CHECKED		
APPROVED	B.NATARAJA	23-07-2020
SCALE		1:1
AREA mm <sup>2</sup>		1940.735
PERIMETER mm.		446.453
WEIGHT kg/m		5.240
DRAWING No.	SECTION No.	
P-21200	-	
28509	28509	

1. ALL DIMENSIONS ARE IN mm.
2. ROUND OFF ALL SHARP CORNERS WITH 0.40 mm.
3. TOLERANCES WILL BE AS PER IS:6477-1983 , UNLESS OTHERWISE SPECIFIED

PARTY'S NAME	KOHLI ALUMINIUM & HARDWARE, NEW DELHI
PARTY'S DRAWING No.	18003
ALLOY & TEMPER	6063 T6
DESCRIPTION	MISC. SECTION