

P-21220

28515

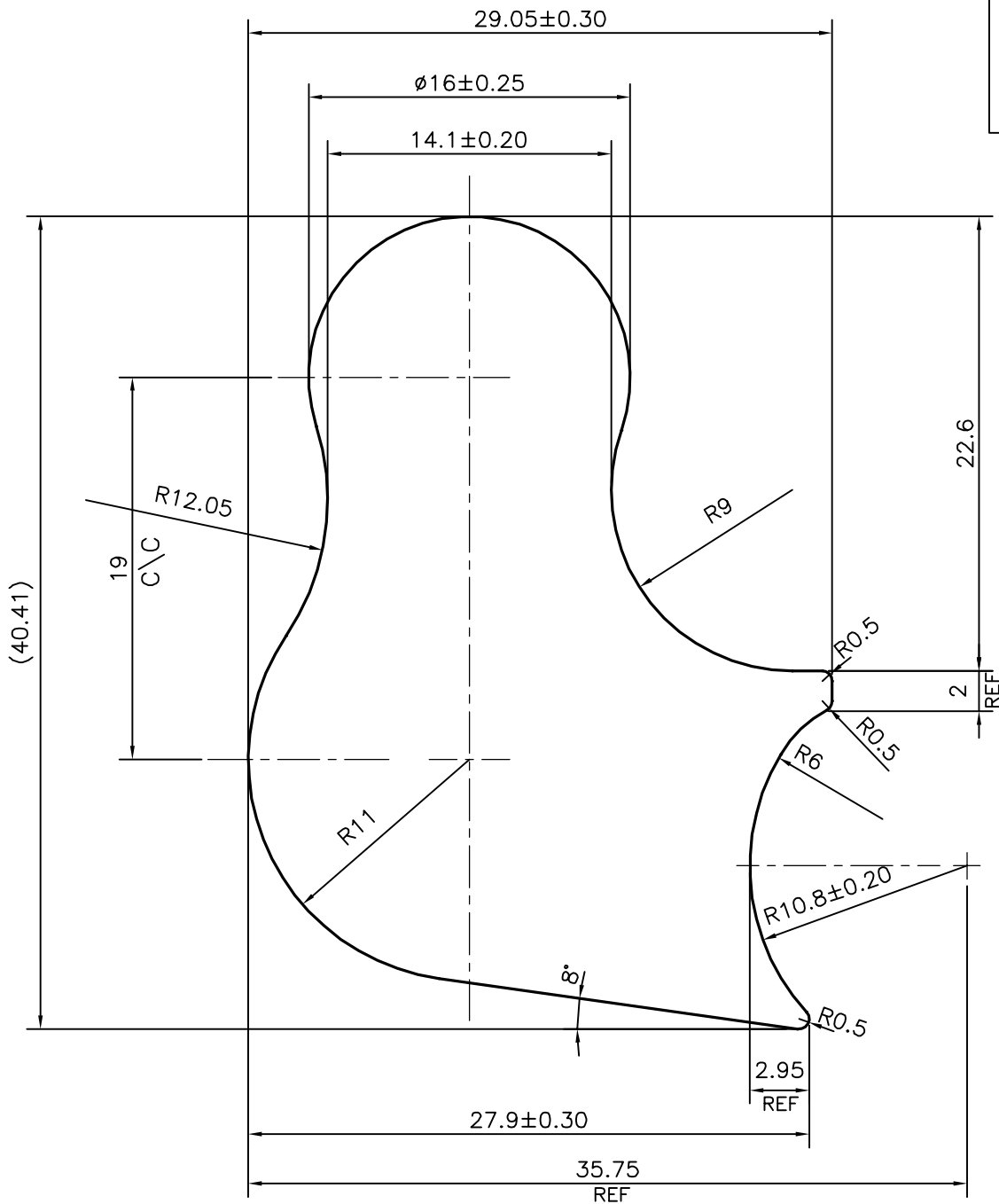
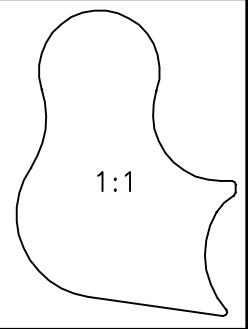

SYMBOL OF QUALITY  
AN ISO 9001 COMPANY

**JINDAL ALUMINIUM LTD.**  
BANGALORE-560073 (INDIA)

	NAME	DATE
DRAWN	J.P.KAUSHIK	25-07-2020
CHECKED		
APPROVED	B.NATARAJA	18-08-2020

1. ALL DIMENSIONS ARE IN mm.
2. ROUND OFF ALL SHARP CORNERS WITH 0.40 mm.
3. TOLERANCES WILL BE AS PER IS:3965-1981 , UNLESS OTHERWISE SPECIFIED

SCALE	3:1
AREA mm <sup>2</sup>	734.749
PERIMETER mm.	120.735
WEIGHT kg/m	1.984

PARTY'S NAME	YOONWOO AUTOMOTIVE INDIA PVT. LTD., PUNE
PARTY'S DRAWING No.	SVA-3978
ALLOY & TEMPER	6060 T66
DESCRIPTION	AUTO MOBILE SECTION

DRAWING No.	SECTION No.
P-21220	-
28515	28515