

P-7895-1

X779

28647

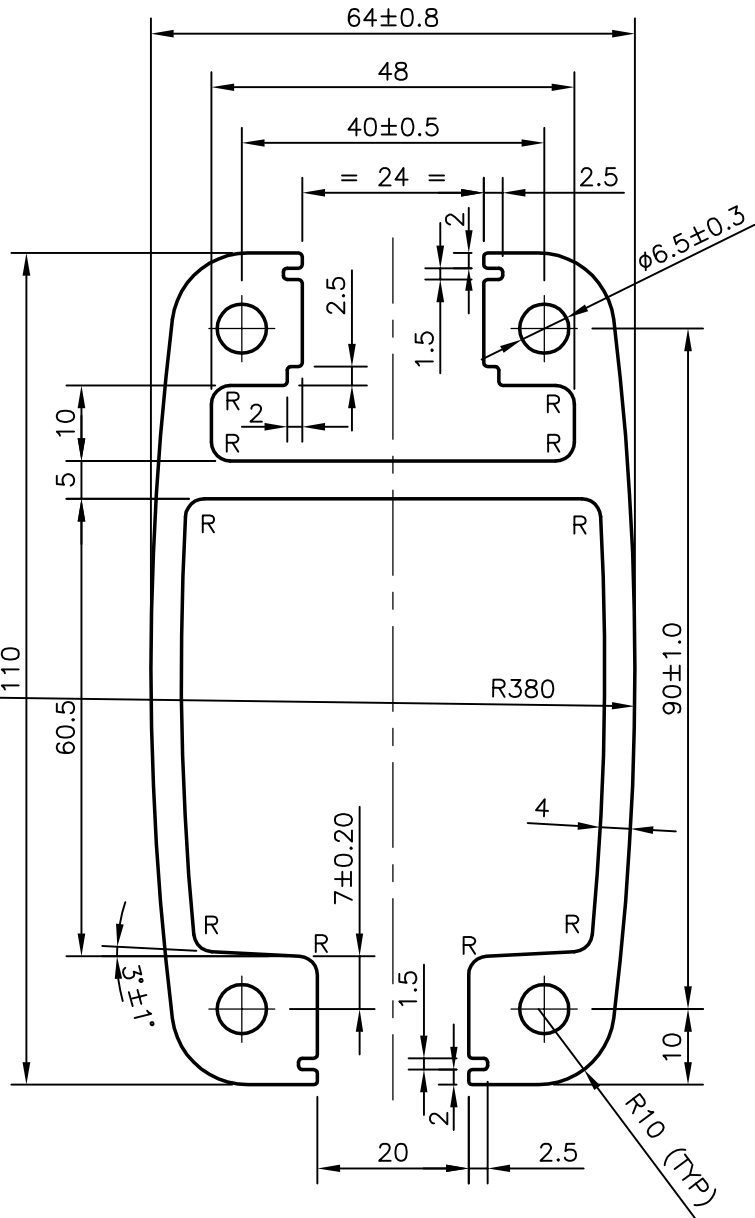

NOTE:-

- TENSILE STRENGTH = 215 MPa
- 0.2% CREEP LIMIT = 160 N/mm<sup>2</sup>
- MODULUS OF ELASTICITY = 70000 MPa
- BRINELL HARDNESS = 70HBN
- TWIST = 2.2 mm/4mtr. OR 3.0 mm/6mtr.
- R = R2.50 mm (10 PLACES)
- UNSPECIFIED RADII IS R0.50 mm



SYMBOL OF QUALITY  
AN ISO 9001 COMPANY

**JINDAL ALUMINIUM LTD.**  
BANGALORE-560073 (INDIA)

	NAME	DATE
DRAWN	PRASANNA.H	14-02-2008
CHECKED		
APPROVED		
SCALE		1:1
AREA mm <sup>2</sup>		1973.695
PERIMETER mm.		648.59
WEIGHT kg/m		5.329
DRAWING No.	SECTION No.	
P-7895-1	-	
X779	X779	
28647	28647	

1. ALL DIMENSIONS ARE IN mm.
2. ROUND OFF ALL SHARP CORNERS WITH 0.50 mm.
3. TOLERANCES WILL BE AS PER EN12020-2:2001 UNLESS OTHERWISE SPECIFIED

PARTY'S NAME	PRECISION AUTOMATION & ROBOTICS INDIA LTD., PUNE
PARTY'S DRAWING No.	EAX81.04000.00
ALLOY & TEMPER	6063 T6
DESCRIPTION	MISC. SECTION