

P-6994

S1937

29324

MATCHING SECTION

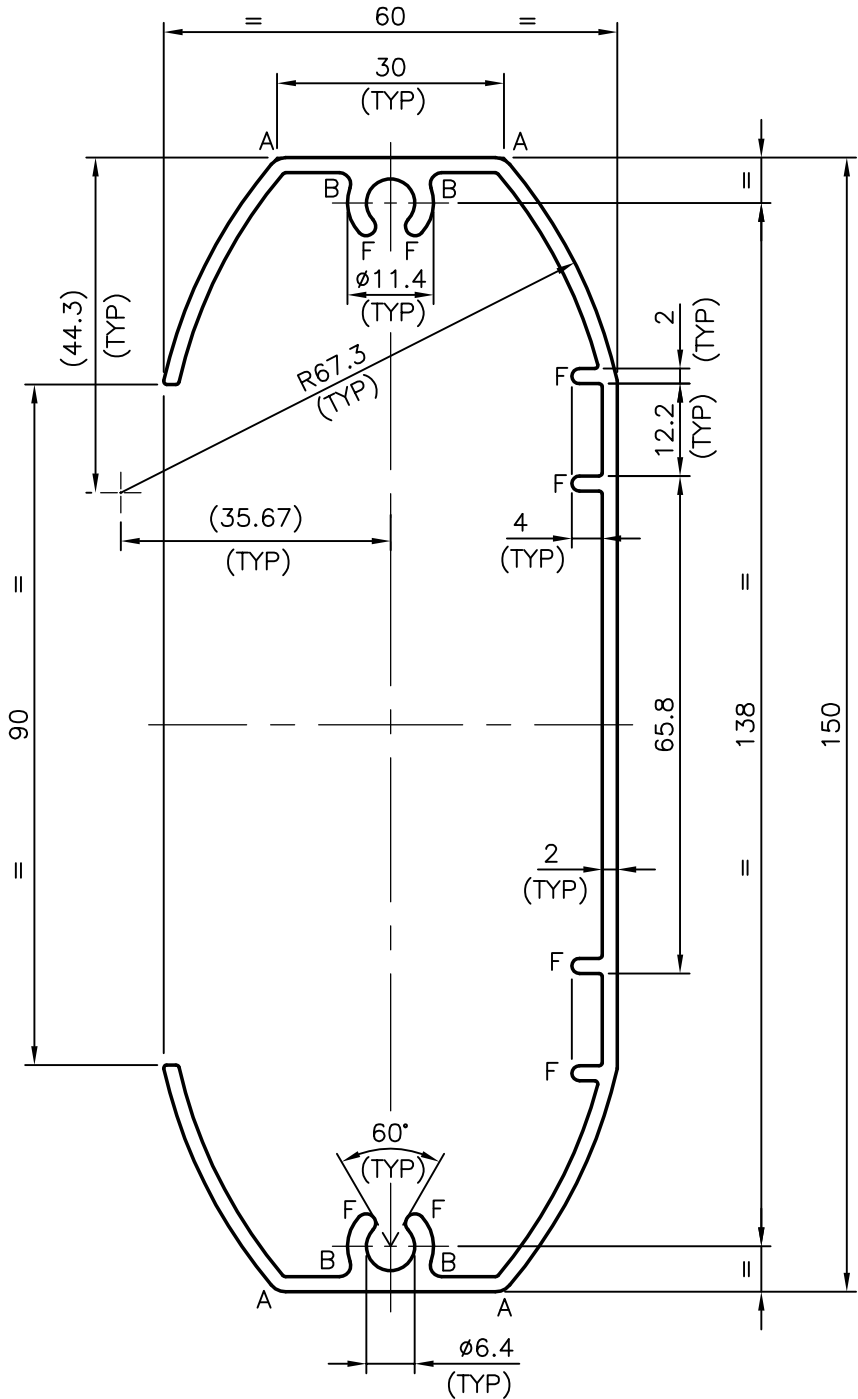
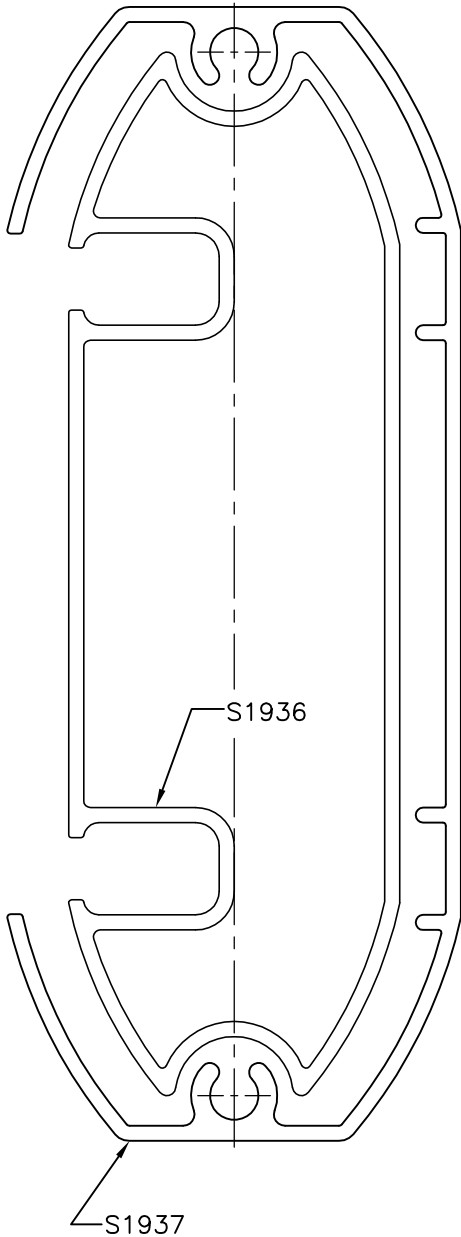

NOTE:-

1. UNSPECIFIED RADIUS = 0.4 mm
2. GENERAL WALL THICKNESS = 2.0 mm
3. F = FULL RADIUS (8 PLACES)
4. A = R2.5 mm (4 PLACES)
5. B = R1.5 mm (4 PLACES)



SYMBOL OF QUALITY
AN ISO 9001 COMPANY

JINDAL ALUMINIUM LTD.
BANGALORE-560073 (INDIA)

	NAME	DATE
DRAWN	PRASANN.H	31-01-2007
CHECKED		
APPROVED		

1. ALL DIMENSIONS ARE IN mm.
2. ROUND OFF ALL SHARP CORNERS WITH 0.4 mm.
3. TOLERANCES WILL BE AS PER IS:3965-1981 UNLESS OTHERWISE SPECIFIED

SCALE	1:1
AREA mm ²	687.094
PERIMETER mm.	642.283
WEIGHT kg/m	1.855

PARTY'S NAME	JANAK HEALTHCARE PVT. LTD., VALSAD
PARTY'S DRAWING No.	AS PER DRAWING
ALLOY & TEMPER	HE9 WP
DESCRIPTION	COMBI LOCKER-OUTSIDE

DRAWING No.	SECTION No.
P-6994	-
S1937	S1937
29324	29324