

P-12849

29520

EXPOSED SURFACE

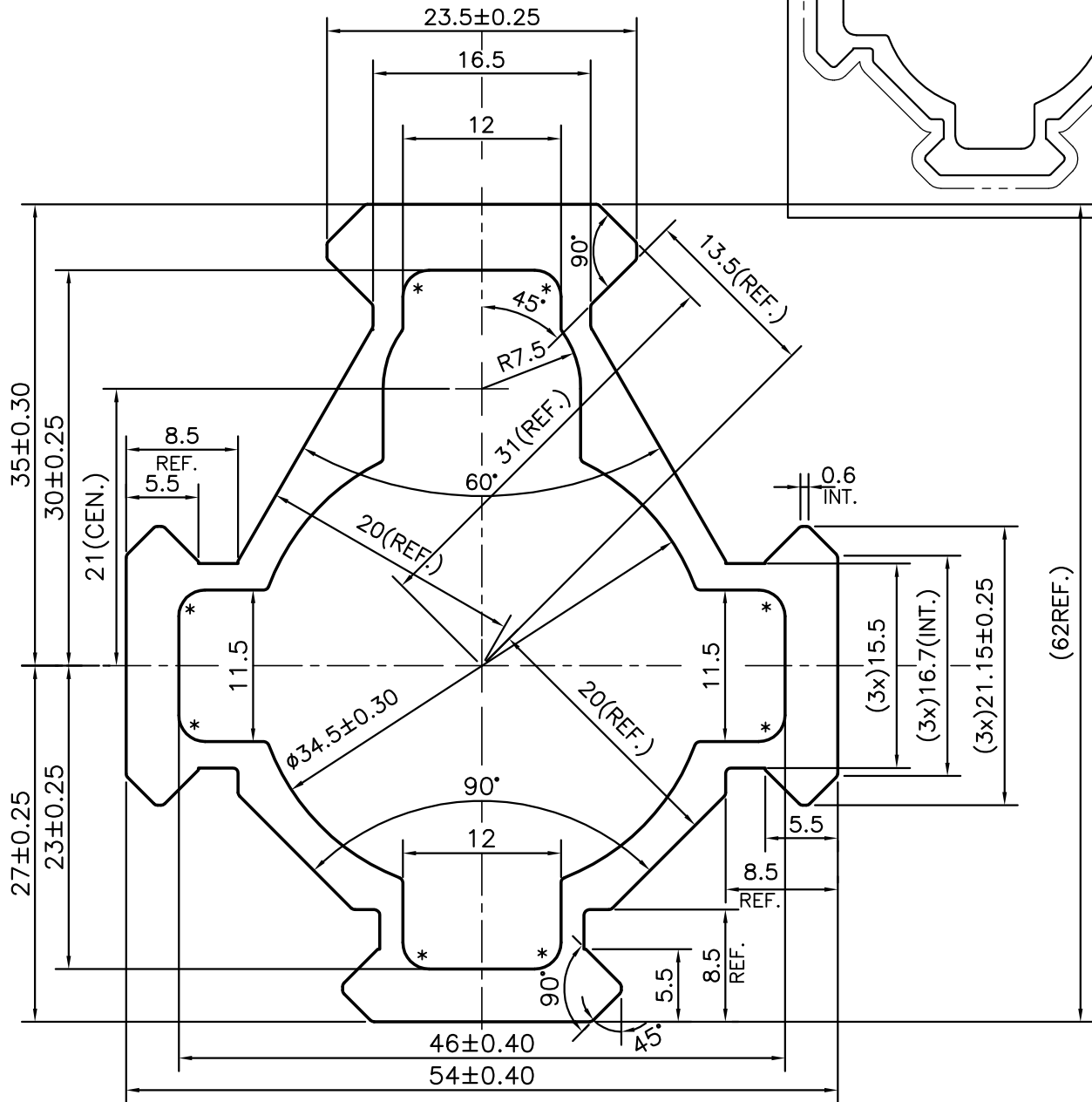
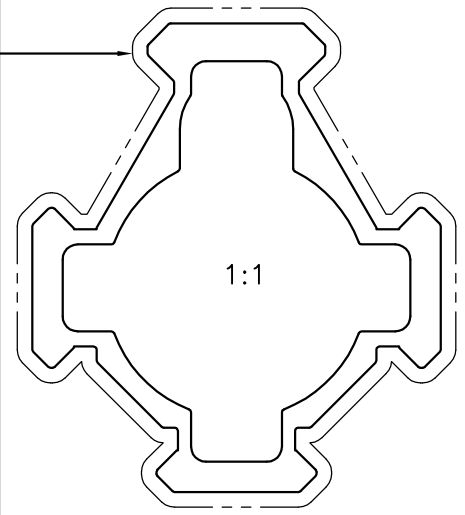

\* = 2 RADIUS ( 8 PLACES )



SYMBOL OF QUALITY  
AN ISO 9001 COMPANY

**JINDAL ALUMINIUM LTD.**  
BANGALORE-560073 (INDIA)

	NAME	DATE
DRAWN	J.P.KAUSHIK	25-06-2013
CHECKED		
APPROVED	S.S.GARG	12-08-2013
SCALE		2:1
AREA mm <sup>2</sup>		693.341
PERIMETER mm.		228.738
WEIGHT kg/m		1.872
DRAWING No.	SECTION No.	
P-12849	-	
29520	29520	

1. ALL DIMENSIONS ARE IN mm.
2. ROUND OFF ALL SHARP CORNERS WITH 0.40 mm.
3. TOLERANCES WILL BE AS PER BS:EN-12020-2, UNLESS OTHERWISE SPECIFIED

PARTY'S NAME	CARACAL- ABUDHABI
PARTY'S DRAWING No.	41185-300.01.1 & AS PER Auto Cad DRAWING
ALLOY & TEMPER	6082 T6
DESCRIPTION	MISC. SECTION