

P-10920-1

S2990

29534

EXPOSED SURFACE

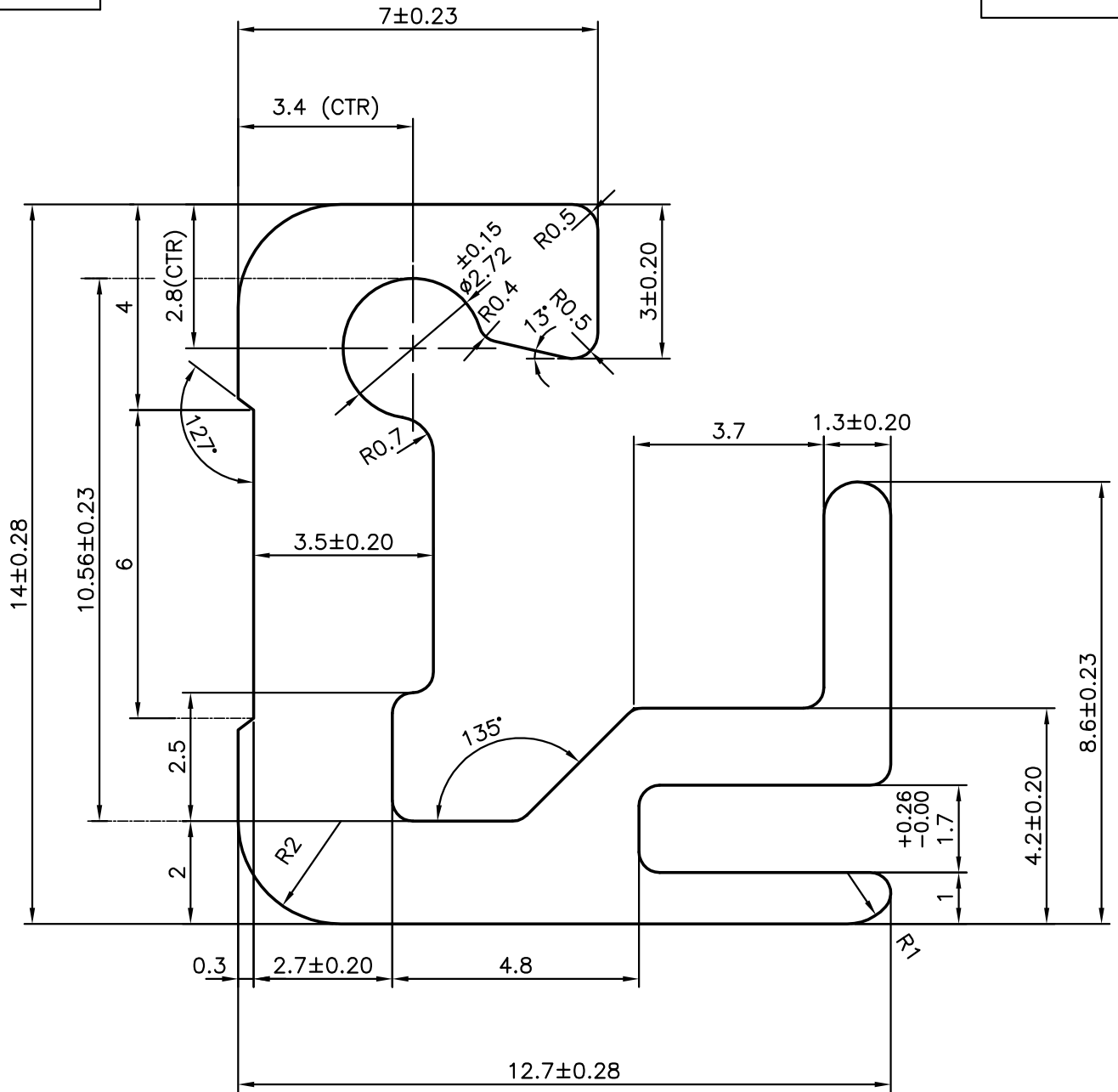
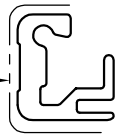

SYMBOL OF QUALITY
AN ISO 9001 COMPANY

JINDAL ALUMINIUM LTD.
BANGALORE-560073 (INDIA)

	NAME	DATE
DRAWN	J.P.KAUSHIK	13-05-2011
CHECKED		
APPROVED	S.S.GARG	01-07-2011

1. ALL DIMENSIONS ARE IN mm.
2. ROUND OFF ALL SHARP CORNERS WITH 0.40 mm.
3. TOLERANCES WILL BE AS PER IS:3965-1981 UNLESS OTHERWISE SPECIFIED

SCALE	8:1
AREA mm ²	79.962
PERIMETER mm.	83.206
WEIGHT kg/m	0.216

PARTY'S NAME: KIRAN MEDICAL SYSTEMS, NAVI MUMBAI

PARTY'S DRAWING No.: AS PER DRAWING

ALLOY & TEMPER: HE9 WP

DESCRIPTION: ALUMINIUM TRAY SECTION-HINGE/PLAIN

DRAWING No.	SECTION No.
P-10920-1	-
S2990	S2990
29534	29534