

P-10978-2

X1511

29627

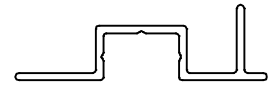

1:1

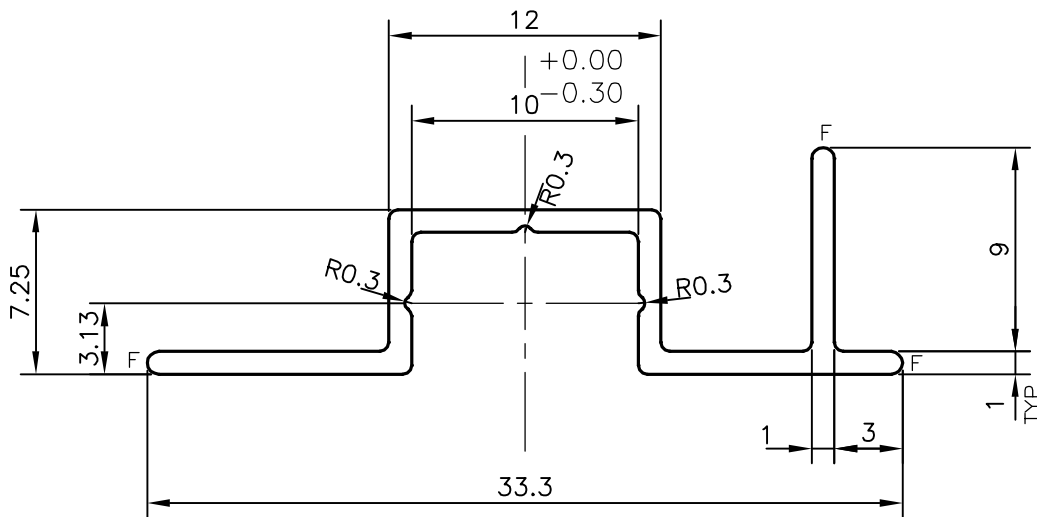

F= FULL RADIUS ( 3 PLACES )



SYMBOL OF QUALITY  
AN ISO 9001 COMPANY

**JINDAL ALUMINIUM LTD.**  
BANGALORE-560073 (INDIA)

	NAME	DATE
DRAWN	J.P.KAUSHIK	02-06-2011
CHECKED		
APPROVED	S.S.GARG	04-06-2011
SCALE		3:1
AREA mm <sup>2</sup>		54.06
PERIMETER mm.		109.192
WEIGHT kg/m		0.146
DRAWING No.	SECTION No.	
P-10978-2	-	
X1511	X1511	
29627	29627	

1. ALL DIMENSIONS ARE IN mm.
2. ROUND OFF ALL SHARP CORNERS WITH 0.40 mm.
3. TOLERANCES WILL BE AS PER, BS:EN-755-9 UNLESS OTHERWISE SPECIFIED

PARTY'S NAME	TRIANGLE MARINE SERVICES, UAE
PARTY'S DRAWING No.	AS PER DRAWING
ALLOY & TEMPER	6063 T6
DESCRIPTION	ONE SIDE OMEGA CHANNEL