

P-17354

29653

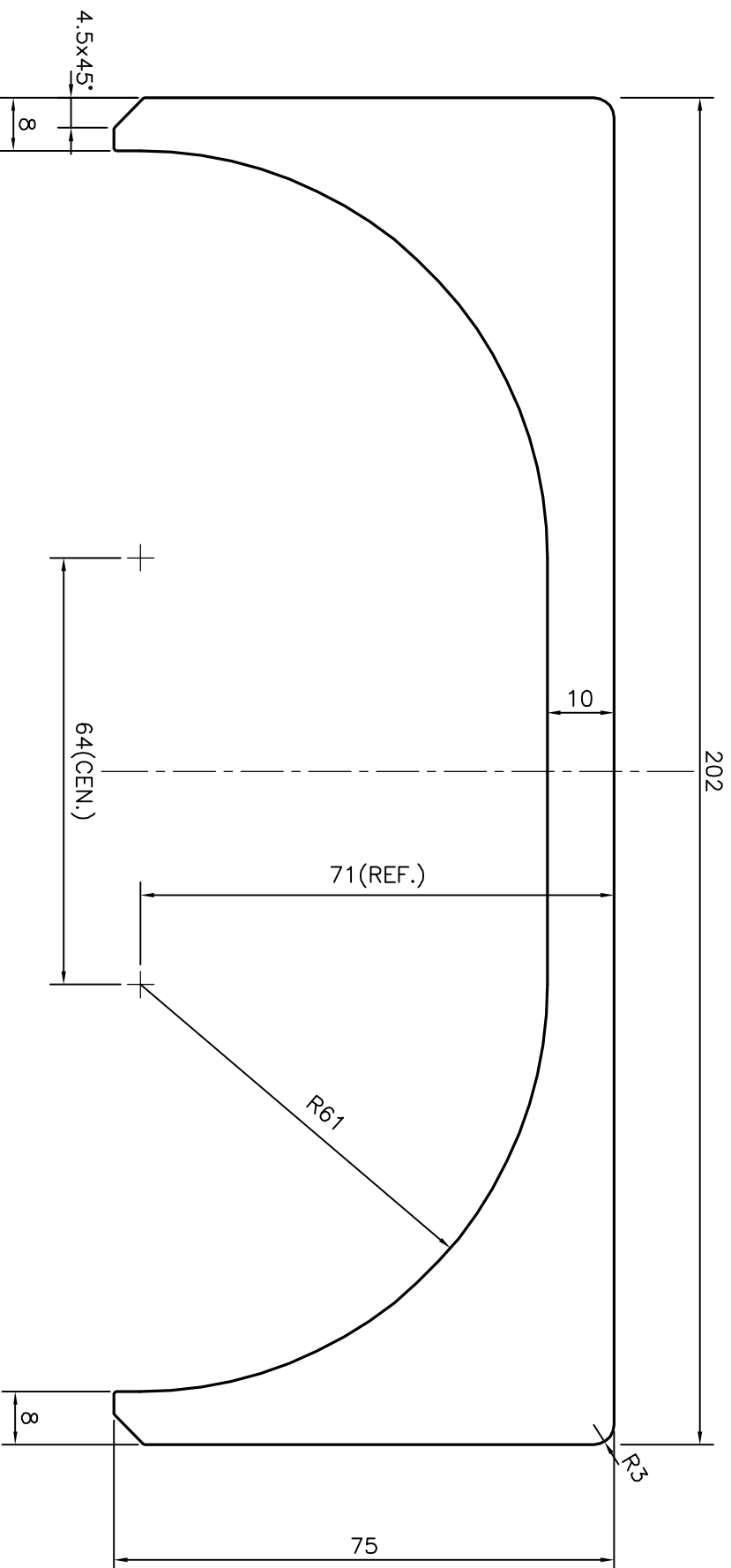

TOLERANCE CHART CD = CIRCUMSCRIBING CIRCLE

CD ≤ 100	100 < CD ≤ 200	200 < CD ≤ 300	300 < CD ≤ 500
UP TO 10mm - ±0.25	±0.30	±0.35	±0.40
10.0 - 25.0 - ±0.30	±0.40	±0.50	±0.60
25.0 - 50.0 - ±0.50	±0.60	±0.80	±0.90
50.0 - 100.0 - ±0.70	±0.90	±1.10	±1.30
100 - 150 - -	±1.10	±1.30	±1.50
150 - 200 - -	±1.3	±1.50	±1.80
200 - 300 - -	-	±1.70	±2.10
300 - 450 - -	-	-	±2.80



SYMBOL OF QUALITY
AN ISO 9001 COMPANY

JINDAL ALUMINIUM LTD.
BANGALORE-560073 (INDIA)

1. ALL DIMENSIONS ARE IN mm.
2. ROUND OFF ALL SHARP CORNERS WITH 0.40 mm.
3. TOLERANCES WILL BE AS PER BS:EN-755-9 UNLESS OTHERWISE SPECIFIED

PARTY'S NAME	DOLPHIN MANUFACTURING LTD.(L.L.C)-UAE	NAME	J.P.KAUSHIK	DATE	22-07-2017
PARTY'S DRAWING No.	EXT-202X75	CHECKED			
ALLOY & TEMPER	6060 T5	APPROVED	B.NATARAJA		02-08-2017
DESCRIPTION	CHANNEL-MISC.	SCALE			1:1
		AREA			4632.872
		PERIMETER			623.378
		WEIGHT			12.509
		DRAWING No.		SECTION No.	
		P-17354		-	
		29653		29653	