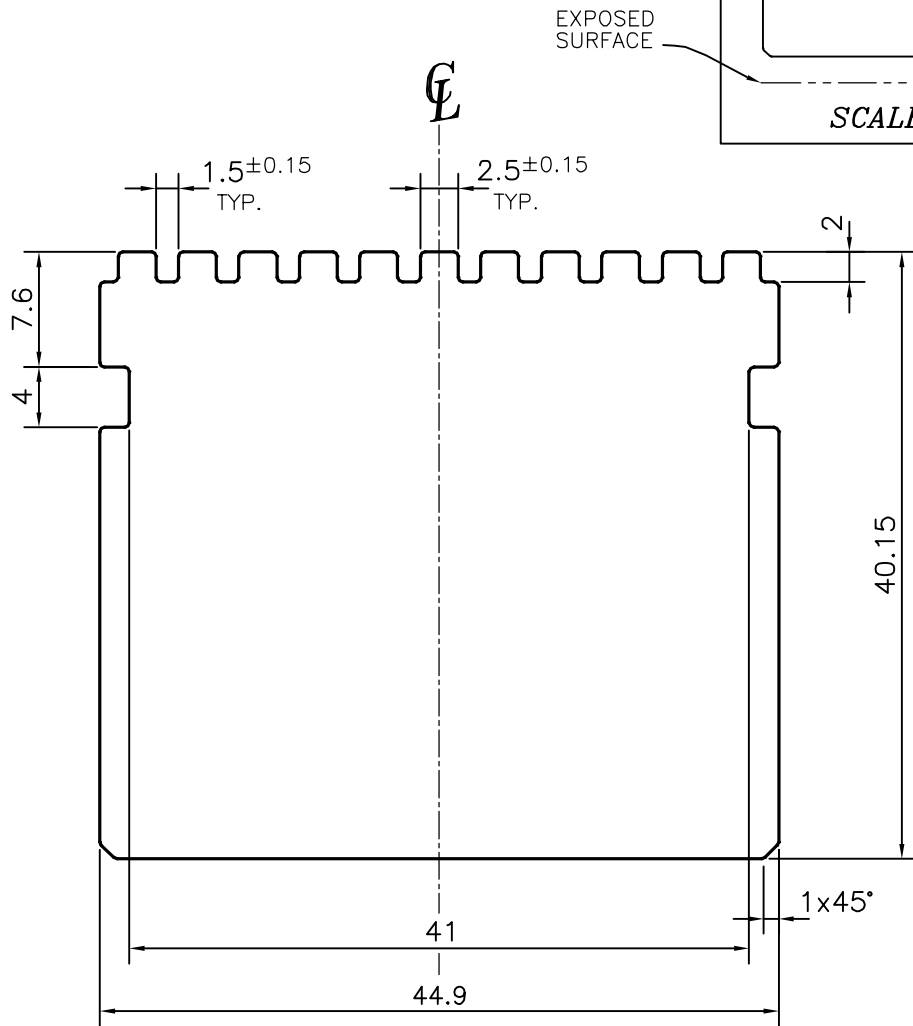

P-13084

S3891

33552

EXPOSED  
SURFACE

SCALE: - 1:1

## TOLERANCES ON OVERALL WIDTHS &amp; WIDTHS ACROSS FLATS OF BARS, &amp; REGULAR SECTIONS

UPTO 6.40mm - ±0.20  
 UPTO 10.0mm - ±0.23  
 UPTO 12.0mm - ±0.25  
 UPTO 16.0mm - ±0.28  
 UPTO 25.0mm - ±0.30

UPTO 32.0mm - ±0.38  
 UPTO 50.0mm - ±0.46  
 UPTO 60.0mm - ±0.53  
 UPTO 80.0mm - ±0.69  
 UPTO 100.0mm - ±0.75

UPTO 120.0mm - ±0.85  
 UPTO 160.0mm - ±1.02  
 UPTO 200.0mm - ±1.14  
 UPTO 250.0mm - ±1.40  
 UPTO 300.0mm - ±1.65

1. STRAIGHTNESS=1.7mm/M  
 2. TWIST=1.7mm/M  
 3. ANGULARITY= ±2'  
 4. FLATNESS =0.007xWIDTH



SYMBOL OF QUALITY  
 AN ISO 9001 COMPANY

**JINDAL ALUMINIUM LTD.**  
 BANGALORE-560073 (INDIA)

	NAME	DATE
DRAWN	PARVESH	09-10-2013
CHECKED		
APPROVED	S.S.GARG	15-10-2013

1. ALL DIMENSIONS ARE IN mm.
2. ROUND OFF ALL SHARP CORNERS WITH 0.30 mm.
3. TOLERANCES WILL BE AS PER IS:3965-1981, UNLESS OTHERWISE SPECIFIED

SCALE	2:1
AREA mm <sup>2</sup>	1751.289
PERIMETER mm.	209.724
WEIGHT kg/m	4.728

PARTY'S NAME	IC ICE MAKE REFRIGERATION PVT. LTD., AHMEDABAD
PARTY'S DRAWING No.	SZT-175
ALLOY & TEMPER	6063 T6
DESCRIPTION	HEAT SINK SECTION

DRAWING No.	SECTION No.
P-13084	-
S3891	S3891
33552	33552