

DETAILS OF "B"
SCALE 3:1

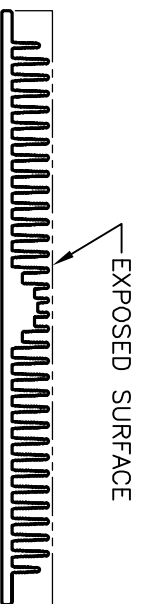

1. STRAIGHTNESS=1.5mm/M (ALONG LENGTH)
2. STRAIGHTNESS LOCAL=0.6mm/300mm (ALONG LENGTH)
3. TWIST=3mm/M
4. CONVEXITY/CONCAVITY= 1.6mm (ALONG WIDTH)

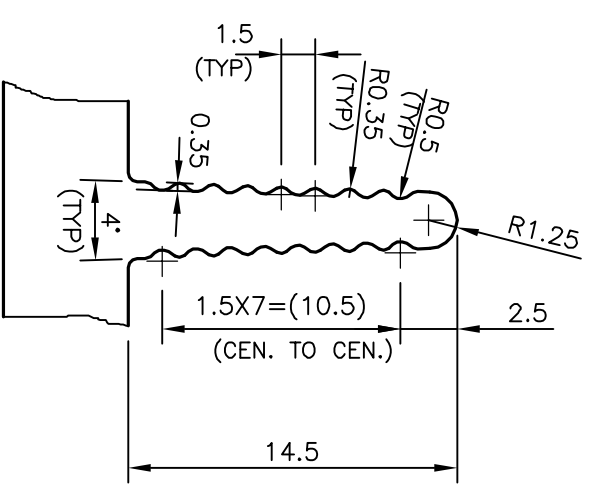

DETAILS OF "A"
SCALE 3:1

TOLERANCE CHART CD = CIRCUMSCRIBING CIRCLE

| DIMENSION | CD<100 | 100<CD<200 | 200<CD<300 | 300<CD<500 |
|-------------|--------|------------|------------|------------|
| UP TO 10mm | ±0.25 | ±0.30 | ±0.35 | ±0.40 |
| 10.0 - 25.0 | ±0.30 | ±0.40 | ±0.50 | ±0.60 |
| 25.0 - 50.0 | ±0.50 | ±0.60 | ±0.80 | ±0.90 |
| 50.0 - 100 | ±0.70 | ±0.90 | ±1.10 | ±1.30 |
| 100 - 150 | - | ±1.10 | ±1.30 | ±1.50 |
| 150 - 200 | - | ±1.3 | ±1.50 | ±1.80 |
| 200 - 300 | - | - | ±1.70 | ±2.10 |
| 300 - 450 | - | - | - | ±2.80 |

| | | | |
|---|--|--|-------------|
| <p>JINDAL SYMBOL OF QUALITY AN ISO 9001 COMPANY</p> | | <p>JINDAL ALUMINIUM LTD. BANGALORE-560073 (INDIA)</p> | |
| <p>1. ALL DIMENSIONS ARE IN mm. 2. ROUND OFF ALL SHARP CORNERS WITH 0.40 mm. 3. TOLERANCES WILL BE AS PER BS:EN-755-9, UNLESS OTHERWISE SPECIFIED</p> | | <p>SCALE 1:1 AREA mm² 3747.127 PERIMETER mm. 1907.55 WEIGHT kg/m 10.117</p> | |
| PARTY'S NAME | ACE MULTI AXES SYSTEM LTD., BANGALORE | DRAWING No. | SECTION No. |
| PARTY'S DRAWING No. | 5334814DDW REV-7(A) & AS PER REQUIREMENT | P-12840-6 | |
| ALLOY & TEMPER | 6063 T4 | S4001 | S4001 |
| DESCRIPTION | HEAT SINK SECTION | 33567 | 33567 |
| <p>DRAWN NAME DATE J.P.KAVSHIK 28-12-2013</p> | | <p>CHECKED S.S.GARG 27-01-2014</p> | |