

P-15091-2

S4696

33615

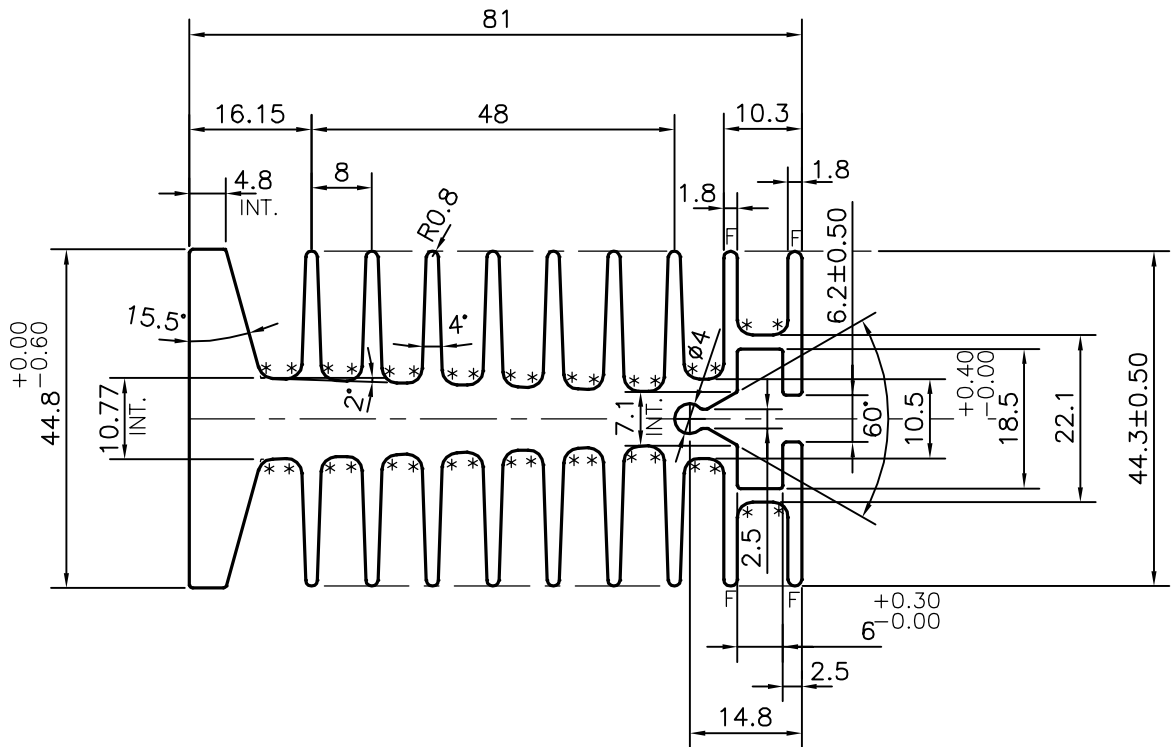

F = FULL RADIUS (4 PLACES)
 * = 2.0 RADIUS (36 PLACES)



SYMBOL OF QUALITY
 AN ISO 9001 COMPANY

JINDAL ALUMINIUM LTD.
 BANGALORE-560073 (INDIA)

	NAME	DATE
DRAWN	J.P.KAUSHIK	25-09-2015
CHECKED		
APPROVED	S.S.GARG	27-09-2015
SCALE		1:1
AREA mm ²		1606.857
PERIMETER mm.		846.78
WEIGHT kg/m		4.339
DRAWING No.	SECTION No.	
P-15091-2	-	
S4696	S4696	
33615	33615	

1. ALL DIMENSIONS ARE IN mm.
2. ROUND OFF ALL SHARP CORNERS WITH 0.40 mm.
3. TOLERANCES WILL BE AS PER IS:3965-1981, UNLESS OTHERWISE SPECIFIED

PARTY'S NAME	PARAMOUNT INDUSTRIES, BANGALORE
PARTY'S DRAWING No.	01-44GPSSR & REQUIREMENT
ALLOY & TEMPER	HE9 WP
DESCRIPTION	HEAT SINK SECTION