

P-17661

S5611

34099

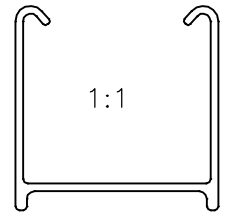

1:1

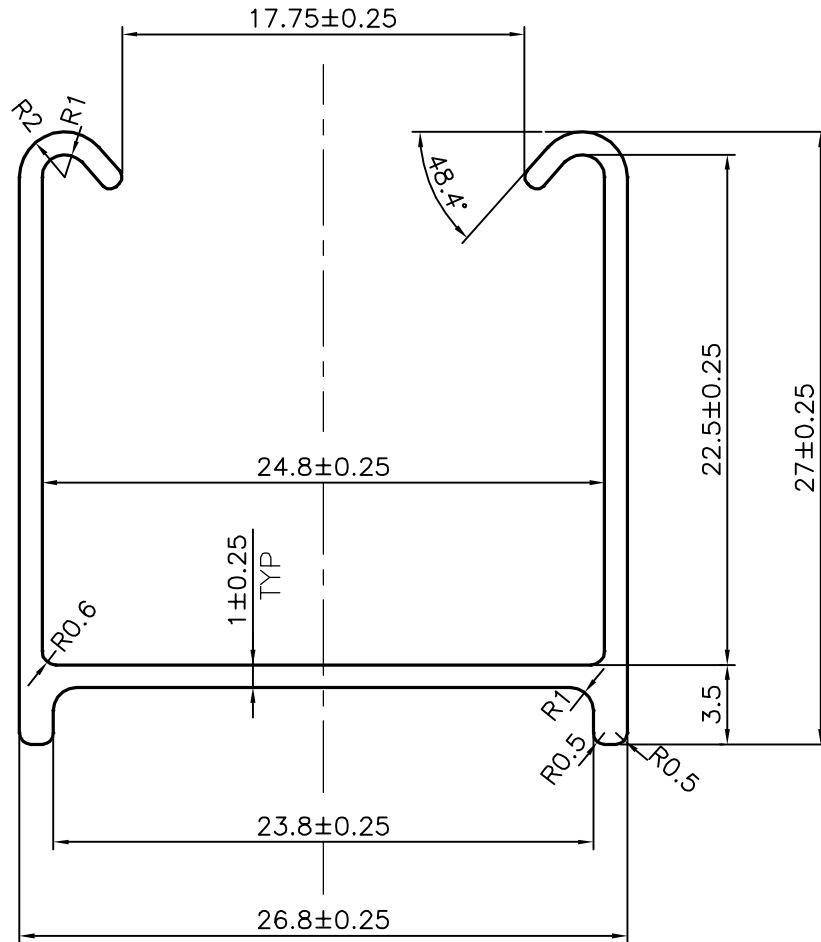

TOLERANCES ON OVERALL WIDTHS & WIDTHS ACROSS FLATS OF BARS, & REGULAR SECTIONS

UPTO 6.40mm - ±0.20
 UPTO 10.0mm - ±0.23
 UPTO 12.0mm - ±0.25
 UPTO 16.0mm - ±0.28
 UPTO 25.0mm - ±0.30

UPTO 32.0mm - ±0.38
 UPTO 50.0mm - ±0.46
 UPTO 60.0mm - ±0.53
 UPTO 80.0mm - ±0.69
 UPTO 100.0mm - ±0.75

UPTO 120.0mm - ±0.85
 UPTO 160.0mm - ±1.02
 UPTO 200.0mm - ±1.14
 UPTO 250.0mm - ±1.40
 UPTO 300.0mm - ±1.65

1. STRAIGHTNESS=1.0mm/M
 2. TWIST=1.0mm/M
 3. ANGULARITY= ±1°
 4. FLATNESS =0.007xWIDTH



SYMBOL OF QUALITY
 AN ISO 9001 COMPANY

JINDAL ALUMINIUM LTD.
 BANGALORE-560073 (INDIA)

	NAME	DATE
DRAWN	J.P.KAUSHIK	18-11-2017
CHECKED		
APPROVED	B.NATARAJA	15-12-2017

- ALL DIMENSIONS ARE IN mm.
- ROUND OFF ALL SHARP CORNERS WITH 0.40 mm.
- TOLERANCES WILL BE AS PER IS:3965-1981, UNLESS OTHERWISE SPECIFIED

SCALE	3:1
AREA mm ²	88.375
PERIMETER mm.	170.369
WEIGHT kg/m	0.239

PARTY'S NAME JAYANITA EXPORTS PVT. LTD., NOIDA

PARTY'S DRAWING No. AS PER DRAWING-01 REVISION 00

ALLOY & TEMPER 6063 T6

DESCRIPTION TOP TRACK SECTION-(VENETAIN BLIND)

DRAWING No.	SECTION No.
P-17661	-
S5611	S5611
34099	34099