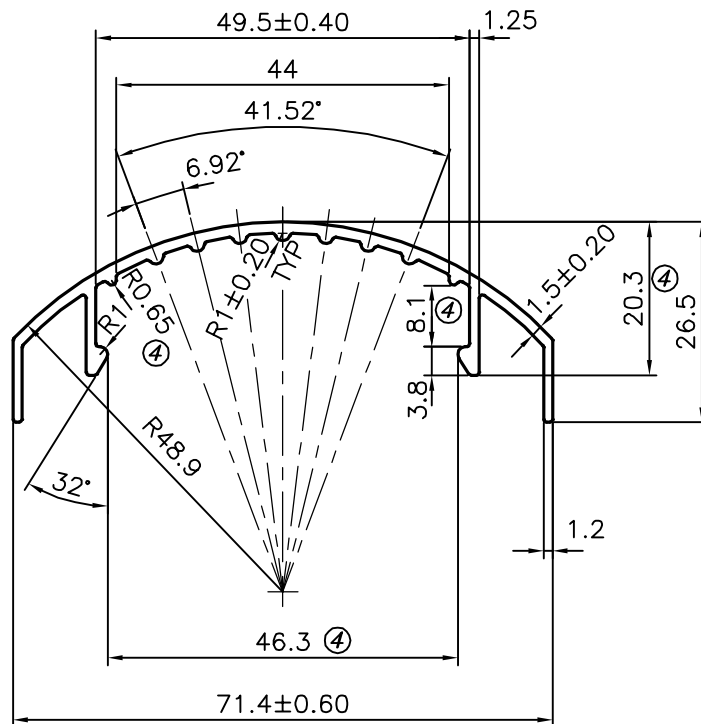

P-12062

S3496

34581

**ISSUE (2) :-**TOLERANCE ADDED ON $R1.0\pm0.20$ & 1.5 ± 0.20 **ISSUE (3) :-**

DIMENSION CHANGED FROM :-

7.35 mm. TO 8.10 mm,
20.30 mm. TO 21.05 mm,

WEIGHT ALSO CHANGED FROM 0.531 kg/m TO 0.537 kg/m.

ISSUE (4) :-

DIMENSION CHANGED FROM 21.05 mm. TO 20.3 mm., HENCE 8.1 mm. REVIEWED.

DIMENSION R0.65 ADDED

WEIGHT ALSO CHANGED FROM 0.537 kg/m TO 0.523 kg/m.

SYMBOL OF QUALITY
AN ISO 9001 COMPANY**JINDAL ALUMINIUM LTD.**
BANGALORE-560073 (INDIA)

	NAME	DATE
DRAWN	PARVESH	15-12-2012
CHECKED		
APPROVED	S.S.GARG	15-01-2013
SCALE		1:1
AREA mm ²		193.779
PERIMETER mm.		256.008
WEIGHT kg/m		0.523
DRAWING No.	SECTION No.	
P-12062	-	
S3496	S3496(ISSUE-4)	
34581	34581	

1. ALL DIMENSIONS ARE IN mm.
2. ROUND OFF ALL SHARP CORNERS WITH 0.40 mm.
3. TOLERANCES WILL BE AS PER BS:EN-755-9 UNLESS OTHERWISE SPECIFIED

PARTY'S NAME EUROCOUSTIC PRODUCTS LTD., MUMBAI

PARTY'S DRAWING No. AS PER DRAWING

ALLOY & TEMPER HE9 WP

DESCRIPTION TOP & END TRIM PROFILE