

P-13330

S4003

34602

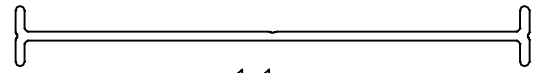

1:1

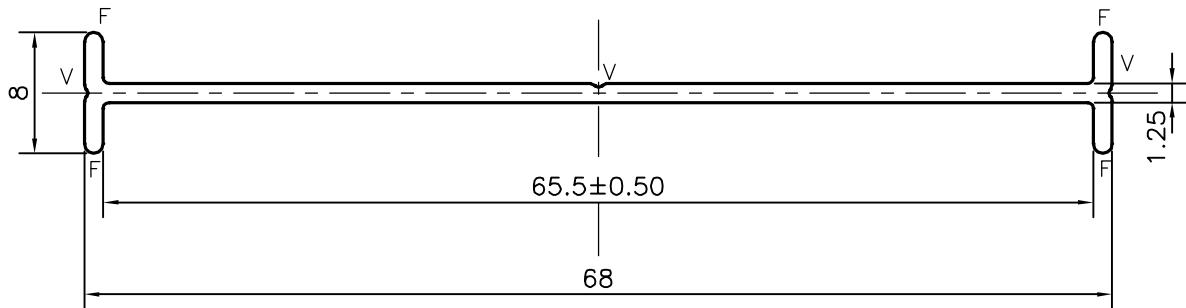

F = FULL RADIUS ( 4 PLACES )

V = V GROOVE 0.25x90° ( 3 PLACES )

## TOLERANCES ON OVERALL WIDTHS &amp; WIDTHS ACROSS FLATS OF BARS, &amp; REGULAR SECTIONS

UPTO 6.40mm - ±0.20	UPTO 32.0mm - ±0.38	UPTO 120.0mm - ±0.85	UPTO 320.00mm - ±1.70
UPTO 10.0mm - ±0.23	UPTO 50.0mm - ±0.46	UPTO 160.0mm - ±1.02	
UPTO 12.0mm - ±0.25	UPTO 60.0mm - ±0.53	UPTO 200.0mm - ±1.14	
UPTO 16.0mm - ±0.28	UPTO 80.0mm - ±0.69	UPTO 250.0mm - ±1.40	
UPTO 25.0mm - ±0.30	UPTO 100.0mm - ±0.75	UPTO 300.0mm - ±1.65	



SYMBOL OF QUALITY  
AN ISO 9001 COMPANY

**JINDAL ALUMINIUM LTD.**  
BANGALORE-560073 (INDIA)

	NAME	DATE
DRAWN	J.P.KAUSHIK	08-01-2014
CHECKED		
APPROVED	S.S.GARG	29-01-2014

1. ALL DIMENSIONS ARE IN mm.
2. ROUND OFF ALL SHARP CORNERS WITH 0.40 mm.
3. TOLERANCES WILL BE AS PER IS:3965-1981 UNLESS OTHERWISE SPECIFIED

SCALE	2:1
AREA mm <sup>2</sup>	100.959
PERIMETER mm.	163.108
WEIGHT kg/m	0.273

PARTY'S NAME	SAIKA INTERIOR PVT. LTD., COIMBATORE
--------------	--------------------------------------

PARTY'S DRAWING No.	SAIKA/H-70/001
---------------------	----------------

ALLOY & TEMPER	HE9 WP
----------------	--------

DESCRIPTION	FURNITURE SECTION - H-SEPERATOR
-------------	---------------------------------

DRAWING No.	SECTION No.
P-13330	-
S4003	S4003
34602	34602