

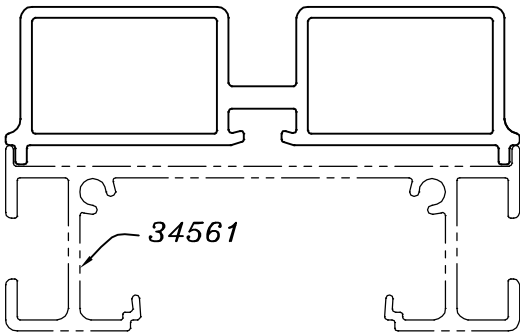

P-16034-1
S4996
34624

EXPOSED SURFACE

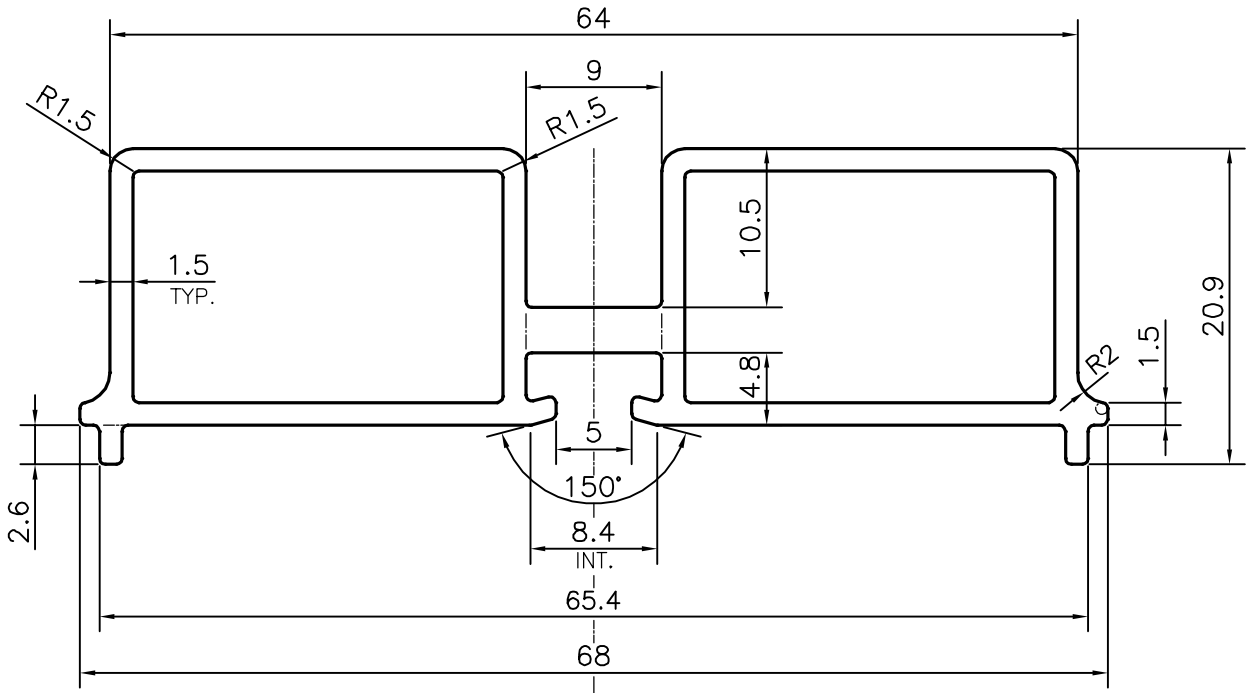
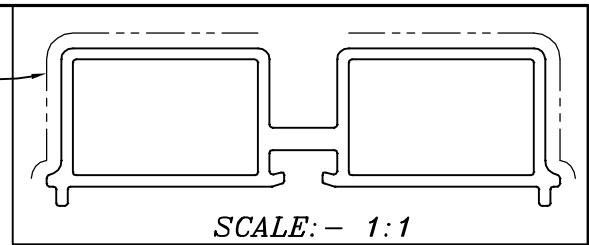

TOLERANCES ON OVERALL WIDTHS & WIDTHS ACROSS FLATS OF BARS, & REGULAR SECTIONS

UPTO 6.40mm - ±0.20	UPTO 32.0mm - ±0.38	UPTO 120.0mm - ±0.85	1. STRAIGHTNESS=1.7mm/M 2. TWIST=1.7mm/M 3. ANGULARITY= ±2° 4. FLATNESS =0.007xWIDTH
UPTO 10.0mm - ±0.23	UPTO 50.0mm - ±0.46	UPTO 160.0mm - ±1.02	
UPTO 12.0mm - ±0.25	UPTO 60.0mm - ±0.53	UPTO 200.0mm - ±1.14	
UPTO 16.0mm - ±0.28	UPTO 80.0mm - ±0.69	UPTO 250.0mm - ±1.40	
UPTO 25.0mm - ±0.30	UPTO 100.0mm - ±0.75	UPTO 300.0mm - ±1.65	

 SYMBOL OF QUALITY AN ISO 9001 COMPANY	JINDAL ALUMINIUM LTD. BANGALORE-560073 (INDIA)	DRAWN	NAME	DATE	
		CHECKED	PARVESH	29-06-2016	
1. ALL DIMENSIONS ARE IN mm. 2. ROUND OFF ALL SHARP CORNERS WITH 0.40 mm. 3. TOLERANCES WILL BE AS PER IS:6477-1983 , UNLESS OTHERWISE SPECIFIED		APPROVED	S.S. GARG	01-07-2016	
		SCALE		2:1	
PARTY'S NAME		HI-STYLE PRODUCTS, SITHAYAN KOTTAI		AREA mm ²	303.693
		PARTY'S DRAWING No.		AS PER AUTOCAD DRAWING & REQUIREMENT	PERIMETER mm.
ALLOY & TEMPER		63400 WP		WEIGHT kg/m	0.820
		DESCRIPTION		FURNITURE SECTION	DRAWING No.
				P-16034-1	-
				S4996	S4996
				34624	34624